

This booklet covers the following models :

L1 COMET 100
L15 CADET 150
K7 CAPTAIN 200
K12 COLONEL 225
K7C COTSWOLD 200
K7T COMMANDO 200

Spare Parts Catalogue

— 1956 MODELS —

Manufacturers:-

JAMES MOTOR CYCLES LTD
GREET, BIRMINGHAM 11

Price : FIVE SHILLINGS

JAMES

1956 MODELS

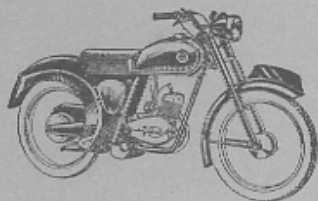

MODEL L1 — COMET 100
First frame number 56L1/101
Villiers 98 cc. Mk. 4F engine

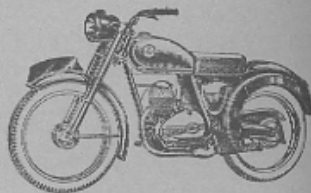

MODEL L15 — CADET 150
First frame number 56L15/101
Villiers 147 cc. Mk. 30C engine

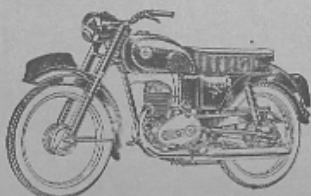

MODEL K7 — CAPTAIN 200
First frame number 56K7/101
Villiers 197 cc. Mk. 8E engine

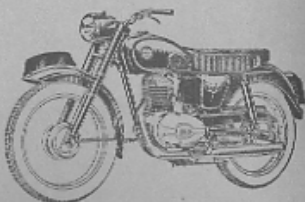

MODEL K12 — COLONEL 225
First frame number 56K12/101
Villiers 224 cc. Mk.1H engine

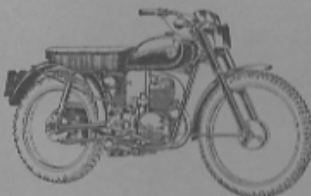

MODEL K7C — COTSWOLD 200
First frame number 56K7C/101
Villiers 197 cc. Mk. 7E engine

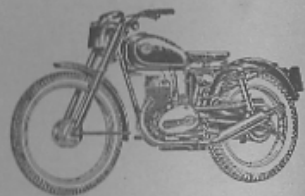

MODEL K7T — COMMANDO 200
First frame number 56K7C/101
Villiers 197 cc. Mk. 7E engine

JAMES

Spares for 1956 models

The James factory-to-dealer service is the quickest way for owners to obtain spares. James dealers hold stocks of most spares likely to be needed and if our dealer is unable to supply, we will execute an order from him by return — subject to stocks being available at the factory.

In emergencies — e.g. when touring or when the owner is unable to contact a James dealer, spares will be supplied direct against cash with order or C.O.D. Alternatively, we shall be pleased to put a James owner in touch with our nearest dealer.

Owners will assist James stockists by providing the following information when calling for spares.

Model and year of manufacture.

Frame and Engine numbers in full.

Old part as pattern, if possible.

Part number and description as in this catalogue.

- ★ Prices in groups 1, 2, 3 and 8 are subject to 10% surcharge.
Prices in groups 4, 5, 6 and 7 are subject to 20% surcharge.
We reserve the right to alter any prices without notice.

- Group 1 Front Forks**
- 2 Frames and R/S**
- 3 Wheels, hubs, brakes**
- 4 Engines**
- 5 Magnetos and Lights**
- 6 Carburetters**
- 7 Gearboxes**
- 8 Sundries**

JAMES MOTOR CYCLES LTD., BIRMINGHAM 11

Telephone : VICTORIA 2211
(5 lines)

Telegrams : JAMESGREET BIRMINGHAM
(Telex)

Ordering from the Factory

Our Service Department handles a large volume of daily correspondence from all over the world and it is in the interests of our customers to provide detailed information so that our staff can deal with their orders promptly and efficiently.

Orders and any relevant correspondence should clearly state :

Name and Address.

Date and Order Number (if any).

Part number and description as in this catalogue.

Complete Frame Number of model for which spares are wanted.

Complete Engine Number, in addition to the Frame Number if engine spares are required.

If unable to quote part numbers, the old parts may be sent as patterns, with name and address securely attached. Old parts will not be returned unless specifically requested at the time of ordering.

Should a private owner find it necessary to write to us regarding an order placed with his local James stockist, he should clearly state all the above details **plus** the name and address of the stockist with whom the order was placed; the date the order was placed and if possible, the date and order number of the stockist's order sent to us.

Payment

Orders for Spares and Repairs are always handled on a cash basis. Unless otherwise instructed, we will normally send spares by C.O.D. post (weight permitting) when remittance does not accompany the order. If desired, we will forward a pro-forma invoice and spares will be despatched on receipt of remittance.

All invoices under £5 will be surcharged by 5% (minimum 6d.) to cover packing and postage or carriage. This is in addition to the price increases of 10% for groups 1, 2, 3 and 8, and 20% for prices in groups 4, 5, 6 and 7 in this catalogue.

When remitting by telegraph money order, the name and address of the sender must be included in the space provided on the Post Office Requisition form for a private message from remitter to payee. Unless this is done the G.P.O. does not provide this information.

Please quote our Advice Note or Repair Docket Numbers in any correspondence relating to past spares or repairs.

Group 1

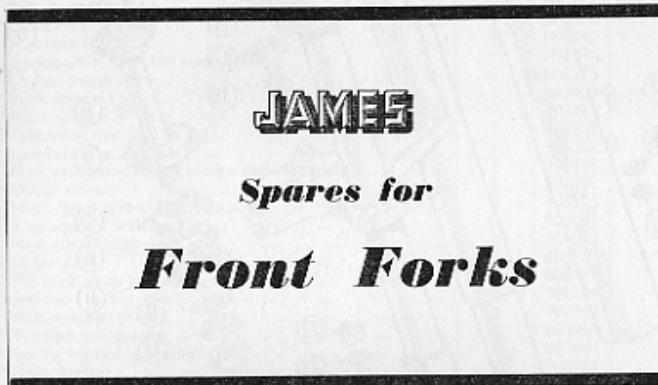

IMPORTANT

From June 1956, certain models were offered in optional maroon or grey finish. Orders for enamelled components should clearly state the colour, as well as the usual model numbers, part numbers and descriptions.

FRONT FORK — ROTARY EXCHANGE SERVICE.

Our rotary exchange scheme enables owners in the U.K. to obtain factory reconditioned components at lower cost than for brand new spares. Exchange facilities are available for front forks assemblies suitable for reconditioning.

Details may be obtained from any James stockist in Britain.

1 Front Fork

L1 — COMET 100 L15 — CADET 150

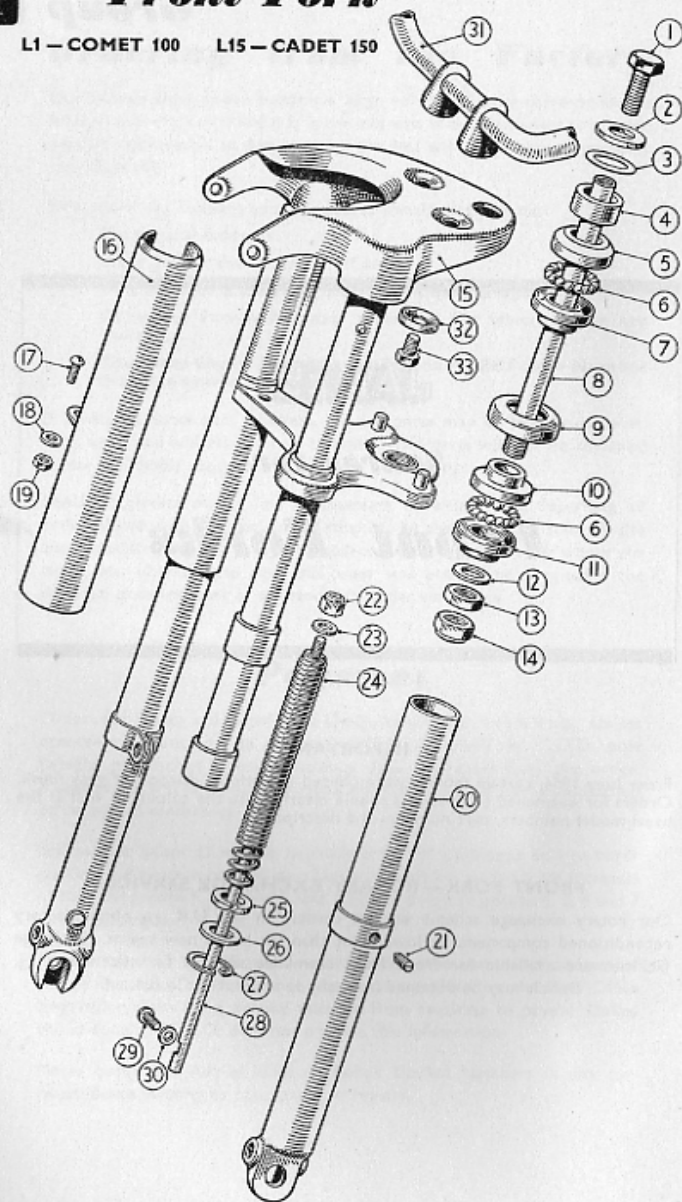

1 Front Fork

L1 — COMET 100 L15 — CADET 150

Ill. No.	Description of Part	Qty.	Part No.	Price each £ s. d.
—	Front fork complete	1	003547	11 0 0
1	Hex bolt $\frac{1}{2}$ " x 26 t.p.i.	1	003857	2 6
2	Plain washer $\frac{1}{2}$ " dia.	1	900197	3
3	Shim — steering stem	4	900389	2
4	Spacer $\frac{3}{16}$ " thick	1	003457	8
5	Adjusting race	1	003451	2 9
6	Ball bearing $\frac{1}{4}$ " dia.	34	000371	set 2 0
7	Upper frame race... ..	1	002378	1 9
8	Steering stem	1	003452	7 6
9	Enclosure cup — for lower race	1	002942	1 9
10	Lower frame race... ..	1	002378	1 9
11	Fork crown race	1	003450	2 3
12	Plain washer $\frac{3}{4}$ " dia.	1	900383	2
13	Adjusting nut $\frac{3}{8}$ " x 26 t.p.i.	1	900353	9
14	Locknut $\frac{3}{8}$ " x 26 t.p.i.	1	900352	9
15	Fork stanchions with crown and top plate	1	003461	4 0 0
16	Outer cover	2	003462	6 6
17	Mush head screw $\frac{1}{2}$ " x 26 t.p.i.	2	900315	3
18	Shake proof washer $\frac{1}{2}$ "	2	900004	1
19	Hex nut $\frac{1}{4}$ " x 26 t.p.i.	2	900027	2
20	Slider tube	2	003550	1 10 0
21	Oil level grub screw	2	003478	5
22	Self locking nut $\frac{1}{2}$ " x 26 t.p.i.	2	900284	4
23	Plain washer $\frac{1}{2}$ " dia.	2	900162	1
24	Tension coil spring	2	003464	3 3
25	Spring retaining washer	2	003469	8
26	Plain washer	2	900386	2
27	Circlip	2	003468	5
28	Compression rod	2	003465	4 6
29	Rod anchor bolt $\frac{1}{4}$ " x 26	2	900385	11
30	Fibre washer	2	900144	1
31	Handlebar	1	003553	2 2 0
32	Recessed washer $\frac{1}{2}$ " dia.	2	002923	1 6
* —	Stiffener plate — upper enamelled	1	004196	5
* —	" — lower dull plated	1	004197	3
33	Hex bolt $\frac{1}{2}$ " dia. x 26	2	900369	8
—	Mudguard bridge attachment clip	2	003475	2 1

* Modification introduced May 1956.

1

Front Fork

K7 — CAPTAIN 200
K7C — COTSWOLD 200

K12 — COLONEL 225
K7T — COMMANDO 200

EXTRA PARTS
ON K7T & K7C

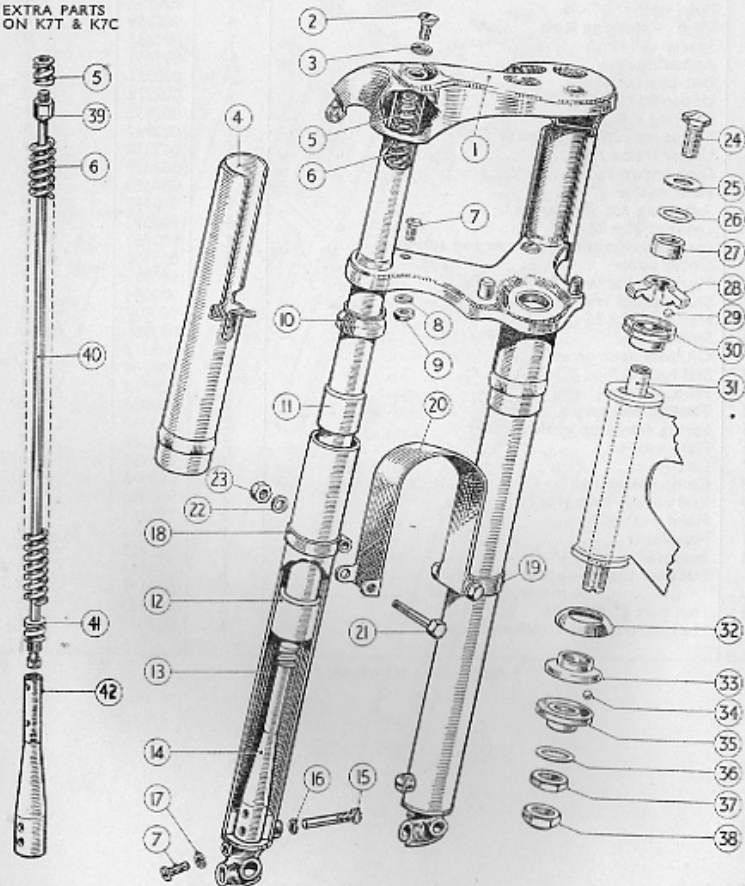

Front Fork

K7 — CAPTAIN 200
K7C — COTSWOLD 200

K12 — COLONEL 225
K7T — COMMANDO 200

1

Ill. No.	Model	Description of Part	Qty.	Part No.	Price each £ s. d.
	K7-K12	Front fork complete	1	003545	15 0 0
	K7C-K7T	Front fork complete (strutted crown) ...	1	003546	16 16 0
1	K7-K12	Fork crown top plate and stanchions ...	1	003548	4 4 0
1	K7C-K7T	Fork crown and top plate and stanchions (strutted fork crown)	1	003549	4 15 0
2	All	Oil filler plug $\frac{3}{8}$ " x 26	2	900364	9
3	"	Fibre washer	2	900144	2
4	"	Top cover sleeve (chromed rim)	2	002938	10 0
5	"	Spring adaptor — top end	2	002949	2 0
6	"	Coil spring	2	002948	12 6
7	"	Screw for drain plug and top cover fixing $\frac{1}{4}$ " x 26	4	900315	3
8	"	Shakeproof washer	2	900004	1
9	"	Hex. nut $\frac{1}{2}$ " x 26	2	900027	2
10	"	Oil seal	2	003018	2 6
11	"	Upper fork bearing bush	2	002907	4 9
12	"	Lower fork bearing bush	2	002906	4 9
13	"	Slider tube and fork end	2	002910	1 15 0
14	K7-K12	Damper post with lower spring adaptor	2	002932	7 6
15	All	Damper post retaining bolt	2	002917	5
16	"	Fibre washer $\frac{3}{8}$ " dia. (post screw)	2	900358	1
17	"	Seloc washer (drain plug)	2	900102	2
18	"	Mudguard bridge clip L.H. with brake cable adjuster plate	1	003199	3 6
19	"	Mudguard bridge clip R.H.	1	003020	2 6
20	K7-K12	Bridge piece (strip)	1	003023	4 0
—	K7C-K7T	" (tubular)	1	003868	11 0
21	All	Clip bolt $\frac{3}{8}$ " x 26 t.p.i.	2	900094	8
22	"	Plain washer $\frac{3}{8}$ " dia.	2	900009	1
23	"	Hex nut $\frac{3}{8}$ " x 26 t.p.i.	2	900000	2
24	K7-K12	Steering stem bolt $\frac{1}{2}$ " x 26 t.p.i.	1	003857	2 6
25	K7C-K7T	Steering stem hex nut $\frac{1}{2}$ " x 26 t.p.i.	1	900390	4
—	All	Plain washer $\frac{1}{2}$ " dia.	1	900197	3
26	"	Shim 20 thou.	as reqd.	900389	2
27	"	Spacer	1	003457	8
28	"	Upper fork race	1	003451	2 9
29	"	Ball bearing $\frac{1}{2}$ " dia.	17	000371	set 1 0
30	"	Upper frame race	1	002378	1 9
31	K7-K12	Steering stem (tubular)	1	003452	7 6
—	K7C-K7T	Steering stem (solid)	1	003894	9 6
32	All	Enclosure cup — lower frame race	1	002942	1 9
33	"	Lower frame race	1	002378	1 9
34	"	Ball bearing $\frac{1}{2}$ " dia.	17	000371	set 1 0
35	"	Lower fork race	1	003450	2 3
36	"	Plain washer $\frac{3}{8}$ " dia.	1	900383	3
37	"	Adjusting nut $\frac{3}{8}$ " x 26 t.p.i., thin	1	900353	9
38	"	Lock nut $\frac{3}{8}$ " x 26 t.p.i., thick	1	900352	9
39	K7C-K7T	Damper rod locknut $\frac{5}{8}$ "	2	900375	4
40	"	Damper rod and piston	2	003219	5 0
41	"	Damper piston only	2	003174	1 3
42	"	Lower spring adaptor	2	003185	4 6
—	"	Damper post with metering holes	2	002946	7 6

JAMES

Spares and Service Department

HOURS OF BUSINESS FOR CALLERS :

8.30 a.m. to 12.30 p.m. 1.30 p.m. to 5.30 p.m.

MONDAYS TUESDAYS WEDNESDAYS

THURSDAYS FRIDAYS

(Not Open on National Holidays)

— HOW TO GET THERE —

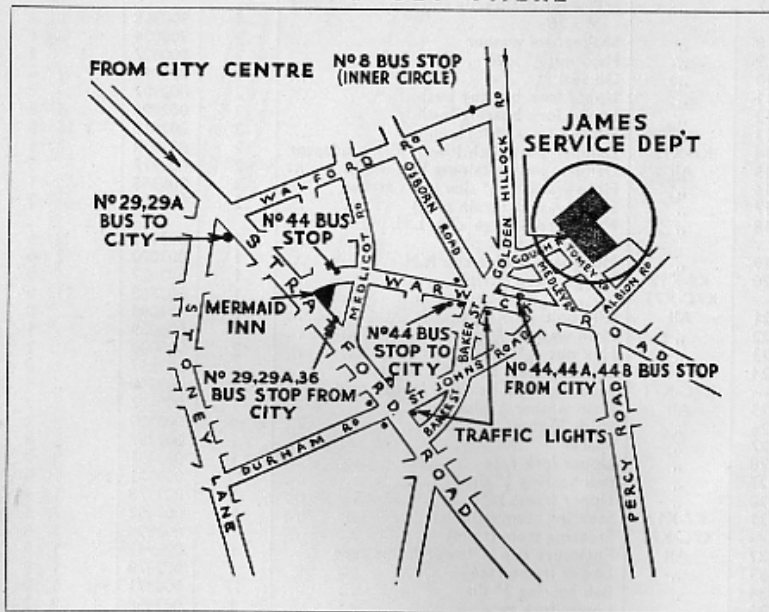

IMPORTANT

Dealers or private owners of James machines calling at the factory are requested to make an appointment by letter or telephone. This will avoid unnecessary waiting and ensure prompt attention to your enquiries.

JAMES MOTOR CYCLES LTD.
GREET, BIRMINGHAM, 11.
Tel. VICTORIA 2211 (5 lines)

Group **2**

JAMES

Spares for

Frames and Rear Suspension

IMPORTANT

From June 1956, certain models were offered in optional maroon or grey finish. Orders for enamelled components should clearly state the colour, as well as the usual model numbers, part numbers and descriptions.

Frame

L1 - COMET 100 L15 - CADET 150

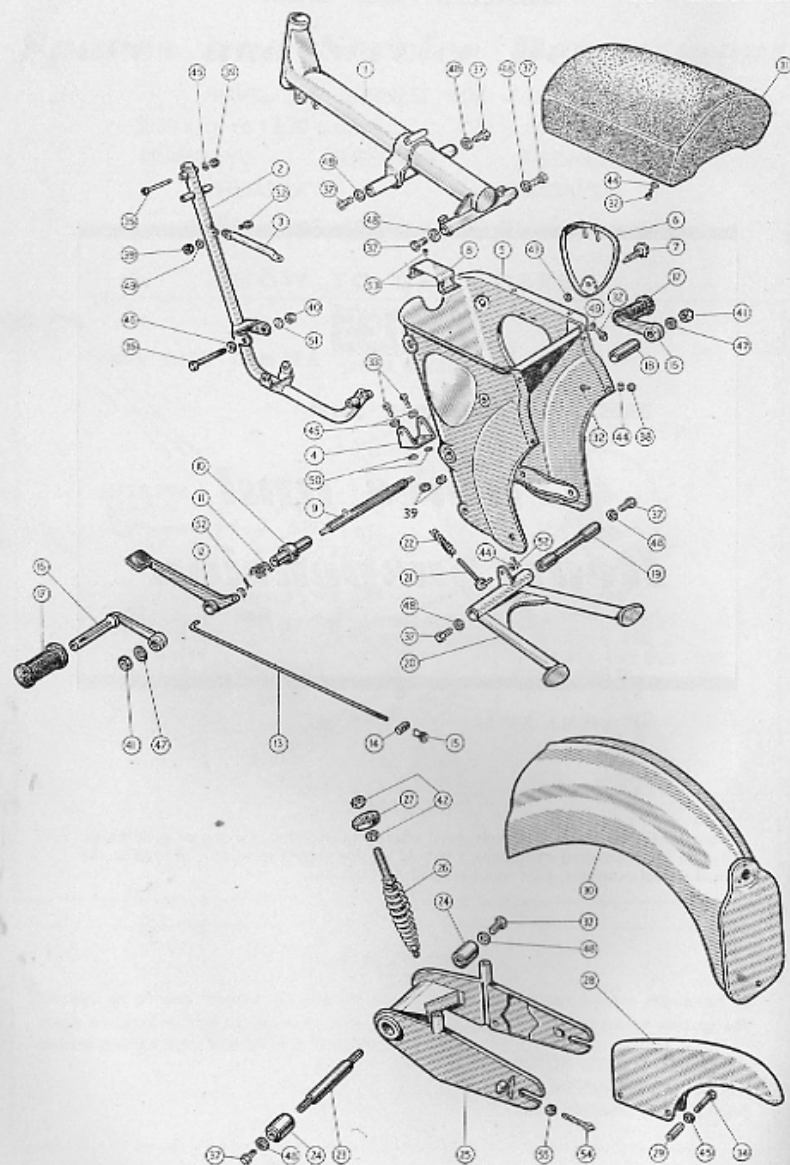

Frame L1 - COMET 100 L15 - CADET 150

Ill. No.	Model	Description of Part	Qty.	Part No.	Price each £ s. d.
1	All	Frame dorsal tube	1	003355	4 0 0
2	L15	Engine loop tube	1	003373	1 15 0
2	L1	" " " " " " " " " " " "	1	003492	1 15 0
3	L15	Cylinder head steady tube	1	003229	2 6
4	"	Rear engine lug	1	003381	2 6
5	All	" " " " " " " " " " " "	1	003486	1 9
6	"	Centre section pressing	1	003362	6 5 0
7	"	Toolbox lid	1	003678	4 1
8	L15	" thumb screw	1	000641	1 6
9	All	Battery bracket	1	003656	9
10	"	bracket insulating strip	1	002484	3
11	All	Footrest brake pedal hex bar	1	003435	5 3
12	"	Brake pedal spring housing and spacer	1	003433	4 3
13	"	Return spring	1	003431	9
14	"	Brake pedal	1	003421	12 0
15	"	rod	1	002367	1 9
16	"	lever roller	1	002382	1 0
17	"	rod adjuster	1	000342	2 0
18	"	Footrest hanger	2	003472	6 0
19	"	rubber	1	002026	1 6
20	"	spacer, R.H.	1	003436	11
21	"	Stand pivot tube	1	003414	7 6
22	"	frame	1	003408	1 1 9
23	"	operating rod	1	003383	1 3
24	"	spring	1	003395	9
25	"	Rear suspension torque tube	1	003415	7 10
26	"	torsion bush	2	003526	4 0
27	"	pivoting fork	1	003384	3 13 6
28	"	coil spring	2	003394	12 6
29	"	coil spring (heavy duty)	2	003831	12 6
30	"	rubber grommet	2	003446	8
31	"	Chainguard	1	003443	10 0
32	"	spacer	2	003479	4
33	"	Rear mudguard and number plate	1	003396	4 10 0
34	"	Cushion seat	1	003646	2 19 6

BOLTS, WASHERS, NUTS AND SPLIT PINS.

32	All	Hex bolt $\frac{1}{4}$ " x 26	11	900054	3
33	"	$\frac{1}{4}$ " x 26	2	900171	4
34	"	$\frac{1}{4}$ " x 26 x $1\frac{1}{2}$ "	2	900094	8
35	"	$\frac{1}{4}$ " x 26 x 2"	1	900290	8
36	"	$\frac{1}{4}$ " x 20 x 3"	2	900332	10
37	"	$\frac{1}{4}$ " x 26 x $\frac{1}{2}$ "	8	900384	8
38	"	Hex nuts $\frac{1}{4}$ " x 26	8	900027	2
39	"	$\frac{1}{4}$ " x 26	3	900000	2
40	"	$\frac{1}{4}$ " x 20	3	900017	3
41	"	$\frac{1}{4}$ " x 26	2	900035	3
42	"	$\frac{1}{4}$ " x 26	4	900390	4
43	"	Special washer $\frac{1}{4}$ " x 26	1	900350	1
44	"	Plain washer $\frac{1}{4}$ " dia.	14	900008	1
45	"	$\frac{1}{4}$ " dia.	5	900009	1
46	"	$\frac{1}{4}$ " dia.	3	900011	1
47	"	$\frac{1}{4}$ " dia.	2	900033	1
48	"	$\frac{1}{4}$ " dia.	8	900030	1
49	"	Shakeproof washer $\frac{1}{4}$ " dia.	8	900004	1
50	"	$\frac{1}{4}$ " dia.	2	900003	1
51	"	$\frac{1}{4}$ " dia.	3	900002	1
52	"	Split pin	2	900121	1
53	"	Self tapping screw	4	900155	1
54	"	Rear chain adjuster bolt	2	900387	3
55	"	Rear chain adjuster lock nut	2	900023	2

Frame

K7 - CAPTAIN 200 K7C - COTSWOLD 200 K7T - COMMANDO 200
K12 - COLONEL 225

NOTE: Though similar in design there are important differences between K7, K12 and K7C/K7T frames. The frame illustrated is for a K7. Refer to model columns carefully when ordering spares.

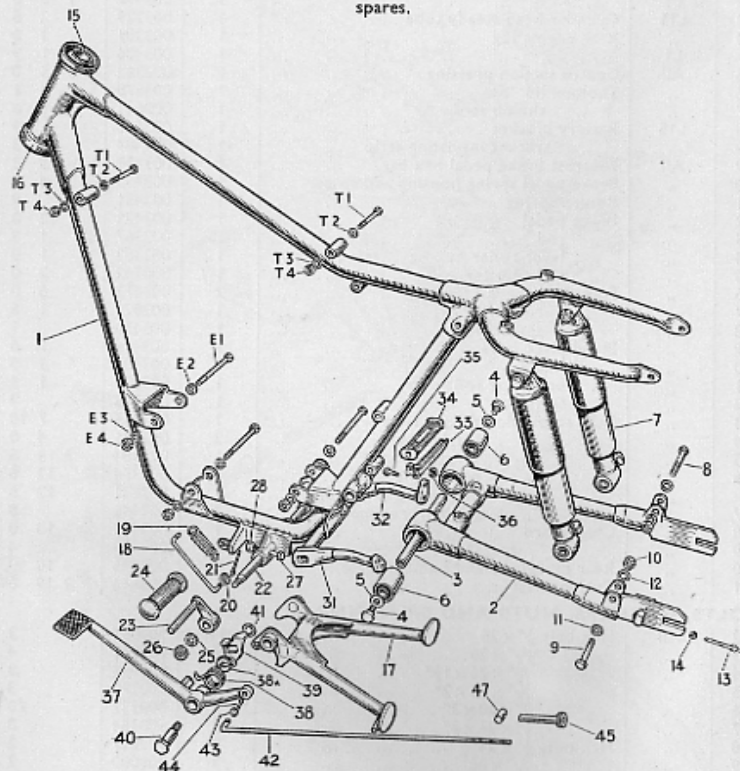

Ill. No.	Model	Description of Part	Qty.	Part No.	Price each £ s. d.
1	K7	Frame loop without fitments ...	1	002079	11 0 0
1	K7C-K7T	" " " " (strutted)...	1	003500	11 0 0
1	K12	" " " " " " " " " " " "	1	002080	11 0 0
2	K7-K12	Pivoting fork ...	1	001778	3 10 0
2	K7C	" " (re-inforced) ...	1	003768	4 5 0
2	K7T	" " " " " " " " " " " "	1	003512	4 5 0
3	K7-K12	Pivot tube ...	1	001878	12 6
3	K7C-K7T	" " " " " " " " " " " "	1	003525	12 6
4	"	Hex bolt $\frac{1}{2}$ " x 26 t.p.i. ...	2	900384	6
5	"	Washer $\frac{1}{2}$ " x 16 s.w.g. x 1 $\frac{3}{8}$ " o.d. ...	2	900197	2
6	"	Torsion bush ...	2	001973	4 0

Frame

K7 - CAPTAIN 200 K7C - COTSWOLD 200 K7T - COMMANDO 200
K12 - COLONEL 225

Ill. No.	Model	Description of Part	Qty.	Part No.	Price each £ s. d.
7	K7-K12	Telescopic unit complete ...	2	003711	3 5 0
7	K7C-K7T	" " " " heavy duty ...	2	003712	3 8 6
8	All	Hex bolt $\frac{3}{8}$ " x 26 t.p.i. x 1 $\frac{3}{8}$ " ...	3	900198	8
9	"	Hex bolt $\frac{3}{8}$ " x 26 t.p.i. x 1 $\frac{1}{4}$ " ...	1	900313	8
10	"	Hex nut $\frac{3}{8}$ " x 26 t.p.i. ...	4	900021	3
11	"	Washer $\frac{3}{8}$ " dia. ...	4	900011	1
12	"	Shakeproof washer $\frac{3}{8}$ " dia. ...	4	900002	1
13	"	Chain adjuster ...	2	900387	3
14	"	Locknut ...	2	900023	2
15	"	Frame ball race top or bottom ...	2	002378	1 9
16	"	" " enclosure cup ...	1	002942	1 9
17	K7-K12	Centre stand ...	1	002129	16 6
18	"	" " operating rod ...	1	002139	1 0
19	"	" " spring ...	1	002140	1 0
20	"	" " plain washer $\frac{1}{2}$ " dia. ...	1	900162	1
21	"	" " split pin $\frac{1}{8}$ " x $\frac{3}{4}$ " ...	1	900121	1
22	K7	Footrest bar 12" long (3 speed box) ...	1	002479	7 6
22	K12-K7C-K7T	" " bar 13 $\frac{1}{2}$ " long ...	1	002123	7 6
23	K7-K12	" " hanger ...	2	002147	4 0
24	"	" " rubber ...	2	002026	1 6
25	All	" " washer $\frac{7}{8}$ " x 14 s.w.g. ...	2	900033	1
26	"	" " hex nut $\frac{1}{4}$ " x 26 t.p.i. x $\frac{7}{8}$ " ...	2	900035	3
27	"	" " locking bolt $\frac{7}{8}$ " x 26 t.p.i. ...	2	900311	4
28	"	" " locking hex nut... ...	2	900312	2
31	"	Pillion footrest and silencer bracket ...	2†	003113	5 6
—	"	Hex bolt $\frac{1}{2}$ " x 26 t.p.i. ...	2	001879	6
—	"	Plain washer $\frac{1}{2}$ " dia. ...	2	900137	1
33	K7-K12	Pillion hanger pressing ...	2	002203	1 9
34	"	" " rubber ...	2	002204	1 6
35	"	" " hex bolt $\frac{1}{2}$ " x 26 t.p.i. x $\frac{7}{8}$ " ...	2	900024	2
36	"	" " nut $\frac{1}{2}$ " x 26 t.p.i. x $\frac{7}{8}$ " long ...	2	900027	2
—	All	Hex bolt right hand ...	1	900369	4
37	K7-K12	Rear brake pedal ...	1	002053	12 6
37	K7C-K7T	" " pedal (short)... ...	1	003865	16 6
38	All	" " return spring ...	1	002119	1 0
39	"	" " pedal adjuster ...	1	002142	2 0
40	"	" " pivot bolt ...	1	002141	1 6
41	"	" " shakeproof washer L.H. serrations ...	1	900333	2
42	"	Rear brake rod ...	1	002367	1 9
43	"	" " plain washer $\frac{1}{2}$ " dia. ...	1	900162	1
44	"	" " split pin $\frac{1}{8}$ " x $\frac{3}{4}$ " ...	1	900121	1
45	K7-K12	" " rod adjuster ...	1	000342	2 0
46	K7C-K7T	" " rod adjuster ...	1	900187	1 0
47	All	" " roller ...	1	002382	1 0
E1	K7-K7C-K7T	Engine bolt $\frac{3}{8}$ " x 20 t.p.i. x 3" long ...	3	900332	10
E1	K12	" " $\frac{3}{8}$ " x 20 t.p.i. x 2 $\frac{3}{4}$ " long ...	4	900331	10
E2	All	" " plain washer ...	—	900011	1
E3	"	" " shakeproof washer ...	—	900002	1
E4	"	" " hex nut $\frac{3}{8}$ " x 20 t.p.i. ...	—	900017	3
T1	K7-K12	Front tank bolt $\frac{7}{8}$ " x 26 x 2 $\frac{1}{8}$ " ...	1	900074	8
T1	"	Rear tank bolt $\frac{7}{8}$ " x 26 x 2 $\frac{1}{8}$ " ...	1	900119	4
T1	K7C-K7T	Front or rear tank bolt $\frac{7}{8}$ " x 26 x 3" ...	2	900041	4
T2	All	Plain washer $\frac{7}{8}$ " dia. ...	2	900009	1

* Also fitted to K7 models with 4 speed gearbox.

† One bracket only supplied with K7C and K7T models.

Frame

(Continued from page 13)

Ill. No.	Model	Description of Part	Qty.	Part No.	Price each £ s. d.
T3	All	Shakeproof washer $\frac{3}{8}$ " dia.	2	900003	1
T4	"	Hex nut $\frac{3}{8}$ " x 26 t.p.i.	2	900000	2
—	K7C-K7T	Spacer $\frac{1}{8}$ " dia. x $\frac{1}{4}$ " thick	—	003659	4
—	"	Chain guide and bolt	1	003498	4 8
—	"	Rear footrest bar	1	002728	10 6
—	"	Footrest L.H.	1	003541	13 0
—	"	" R.H.	1	003542	13 0
—	"	Frame channel pressing	1	003275	4 6
—	"	Distance piece $\frac{1}{2}$ " thick	1	003220	5
—	"	Kerb stand complete	1	003845	1 8 6
—	"	" " leg only	1	003880	18 0
—	"	" " Bracket only R.H.	1	003824	15 9
—	"	" " Tab washer	1	001507	1
—	"	" " spring	1	000229	1 0
—	"	" " hex bolt	1	900070	2

IMPORTANT

ORDERS FOR SPARE PARTS SHOULD BE SENT IN LIST FORM ON ONE SIDE OF A SHEET OF PAPER AND NOT AS PART OF A LETTER.

THE COMPLETE FRAME AND ENGINE NUMBERS AS WELL AS PART NUMBERS AND DESCRIPTIONS SHOULD BE QUOTED ON EACH ORDER.

OLD PARTS SENT AS PATTERNS WILL BE SCRAPPED UNLESS CUSTOMER SPECIFIES OTHERWISE.

Rear Suspension UnitK7 — CAPTAIN 200
K12 — COLONEL 225

K7C — COTSWOLD 200

K7T — COMMANDO 200

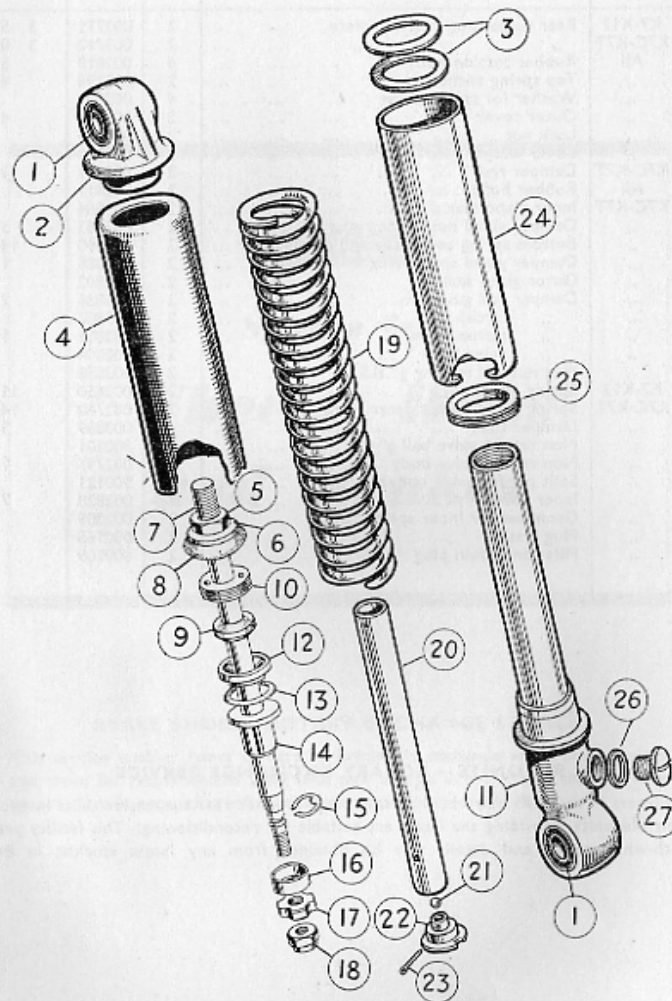

Wheels

L1 — COMET 100
K7 — CAPTAIN 200
K7C — COTSWOLD 200

L15 — CADET 150
K12 — COLONEL 225
K7T — COMMANDO 200

Model	Description of Part	Qty.	Part No.	Price each £ s. d.
L1	Front wheel complete	1	003559	5 8 9
L15	" " " " " " " "	1	003558	5 8 9
K7	" " " " " " " "	1	003557	7 12 6
K12	" " " " " " " "	1	003556	9 10 0
K7C-K7T	" " " " " " " "	1	003935	8 0 0
L1	Rear wheel complete (less sprocket and speedo drive)	1	003623	7 19 6
L15-K7	" " " " " " " "	1	003621	7 19 6
K12	" " " " " " " "	1	003619	10 10 0
K7C	" " " " " " " "	1	003933	8 17 6
K7T	" " " " " " " "	1	003622	8 17 6
L1	Rim WM0-19" aluminium finish	2	003133	16 0
L15-K7	" WM1-18" aluminium finish	2	003569	16 0
K12	" WM2-18" chromed	2	003570	1 5 0
K7C-K7T	" WM1-21" chromed (front)	1	003138	1 5 0
K7C	" WM2-19" chromed (rear)	1	003136	1 5 0
K7T	" WM3-19" chromed (rear)	1	003137	1 5 0
L1	Spokes (front) 12 s.w.g. x 7 $\frac{1}{2}$ "	36	000256	2
L15	" (front L.H.) 12 s.w.g. x 7 $\frac{1}{2}$ "	18	003585	2
"	" (front R.H.) 12 s.w.g. x 6 $\frac{1}{2}$ "	18	003703	2
K7	" (front L.H.) 10 s.w.g. x 6 $\frac{1}{2}$ "	18	003702	2
"	" (front R.H.) 10 s.w.g. x 6 $\frac{1}{2}$ "	18	003701	2
K12	" (front L.H.) 10 s.w.g. x 6 $\frac{1}{2}$ "	18	003582	2
"	" (front R.H.) 10 s.w.g. x 6 $\frac{1}{2}$ "	18	003700	2
K7C-K7T	" (front L.H.) 10 s.w.g. x 8 $\frac{1}{2}$ "	18	003202	2
"	" (front R.H.) 10 s.w.g. x 8 $\frac{1}{2}$ "	18	001282	2
L1	" (rear) 10 s.w.g. x 7 $\frac{1}{2}$ "	36	003704	2
L15	" (rear) 10 s.w.g. x 6 $\frac{1}{2}$ "	36	003705	2
K7-K12	" (rear) 10 s.w.g. x 6 $\frac{1}{2}$ "	36	003705	2
K7C-K7T	" (rear L.H.) 10 s.w.g. x 7 $\frac{1}{2}$ "	18	003139	2
"	" (rear R.H.) 10 s.w.g. x 6 $\frac{1}{2}$ "	18	003706	2
L1	Nipples (front) 12 s.w.g. x .225"	36	000266	2
"	" (rear) 10 s.w.g. x .225"	36	000255	2
L15	" (front) 12 s.w.g. x .250"	36	003707	2
"	" (rear) 10 s.w.g. x .250"	36	000254	2
All ex. L1	" (front and rear) 10 s.w.g. x .250"	72	000254	2
K7C-K7T	Security bolt (front)	1	001269	1 9
K7C	" (rear)	1	001270	1 9
K7T	" (rear)	1	001271	1 9

We do not supply tyres or tubes as spare parts.

Front Hub 4"

L1 — COMET 100 L15 — CADET 150

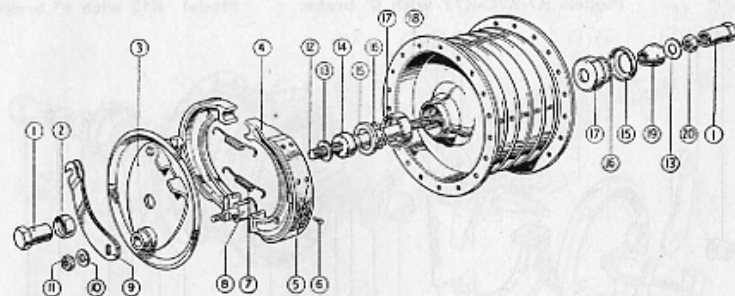

III. No.	Description of Part	Qty.	Part No.	Price each £ s. d.
—	Front hub complete	1	003783	3 16 0
1	Spindle nut $\frac{7}{16}$ " x 26 t.p.i.	2	900359	2 6
2	Recessed nut $\frac{7}{16}$ " x 26 x $\frac{1}{16}$ "	1	900360	6
3	Brake backplate	1	003801	10 0
4	" shoe and lining	2	000690	pr. 10 0
5	" lining	2	000370	pr. 2 6
6	" rivets only	16	900146	set 6
7	" return spring	2	000369	4
8	" cam	1	000692	4 0
9	" cam lever	1	002924	2 0
10	" cam special washer	1	900166	1
11	Hex. nut $\frac{7}{16}$ " x 26 t.p.i.	1	900000	2
12	Spindle	1	003470	3 6
13	Plain washer $\frac{7}{16}$ " x 16 s.w.g.	1	900013	1
13	Lock washer-adjusting cone	1	000360	1
14	Fixed cone	1	000358	2 3
15	Dust cap	2	000353	4
16	Ball bearings $\frac{1}{2}$ "	20	000371	set 1 0
17	Bearing cup	2	000351	1 6
18	Hub shell and brake drum	1	003789	1 10 0
19	Adjusting cone	1	000359	2 6
20	Hex. locknut	1	900034	3

It pays to fit Genuine James Spare Parts.

3

Rear Hub 6"

K12 — COLONEL 225

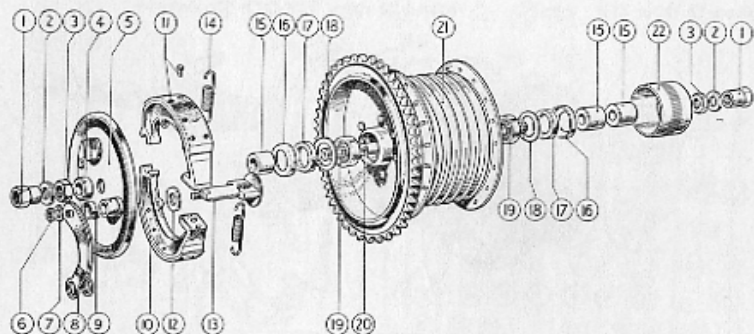

Ill. No.	Description of Part	Qty.	Part No.	Price each £ s. d.
—	Rear hub and brake complete	1	003802	8 10 0
1	Spindle nut $\frac{7}{8}$ " x 26 t.p.i.	2	900047	2 6
2	Plain washer $\frac{3}{4}$ " x 10 s.w.g.	2	900015	1
3	Locknut $\frac{7}{8}$ " x 26 x $\frac{3}{8}$ "	2	900051	3
4	Spacer $\frac{1}{8}$ " long	1	001337	9
5	Backplate	1	003809	18 6
6	Hex nut $\frac{1}{2}$ " x 26 t.p.i.	1	900000	2
7	Plain washer	1	900009	1
8	Brake cam lever	1	001816	3 0
9	Oiler spring clip	1	001418	3
10	Brake shoe and lining complete	2	002281	pr. 15 0
—	Brake lining only	2	001822	pr. 6 0
11	Rivets $\frac{1}{4}$ " long	14	900145	set 6
12	Brake cam washer	1	900170	1
13	Brake cam	1	001808	4 0
14	Return spring	2	001819	6
15	Spacer $\frac{3}{8}$ " long	3	001336	9
16	Enclosure cup, bearing seal	2	003006	6
17	Felt seal	2	003007	6
18	Enclosure washer, bearing seal	2	003005	3
19	Ball bearing 42 x 15 x 13 mm. SKF 6302	2	003008	*
20	Spindle	1	002961	10 0
21	Hub shell and brake drum with sprocket	1	003804	5 2 0
22	Outer cover	1	002980	2 6

* Manufacturers current price.

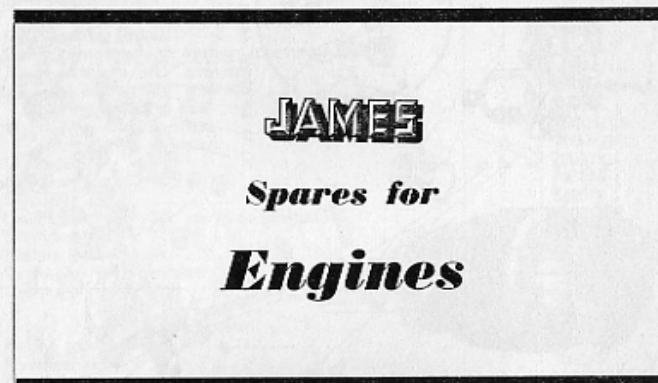
Group 4

ENGINE — ROTARY EXCHANGE SERVICE.

Our Rotary Exchange Service enables James owners in the U.K. to obtain certain factory reconditioned replacements at prices appreciably lower than the cost of new spares. Exchange facilities are available for crankshaft assemblies with new big and little end bearings, rebored cylinders complete with O/S piston and rings, and recorked clutch plates and sprockets, providing the units handed in for exchange are suitable for reconditioning. This service also applies to complete power units with gearbox, magneto and carburetter. Details and prices may be obtained from any James stockist in Britain.

continued from page 25

Ill. No.	Description of Part	Qty.	Part No.	Price each £ s. d.
51	Washer	1	702030	*
52	Flywheel assembly complete with leads ... (See Group 5, p.40 for components)	1	703045	4 0
53	High tension lead	1	703046	6
54	Rubber cover for terminal holder	1	703125	1 3
55	High tension terminal holder	1	703011	2
56	Felt washer	1	703014	1
57	Brass terminal screw	1	703126	1
58	" " spring	1	703127	2
59	Terminal spring pad	1	703128	5 6
60	Adaptor for contact breaker	3	703129	2
61	Screw securing adaptor to crankcase door	1	703130	1
62	Gasket for adaptor	1	—	*
62	Contact breaker assembly complete (See below for components)	—	—	—
63	Condenser	1	703131	5 0
64	Screw securing condenser to crankcase door	1	703038	2
65	Washer	1	703027	1
66	Distance piece	1	703132	1

CONTACT BREAKER AND CAM GREASER PARTS.

(See item 62, page 24)

Ill. No.	Description of Part	Qty.	Part No.	Price each £ s. d.
1	Contact breaker point bracket	1	703135	2 0
2	Rocker arm assembly	1	703136	5 0
3	" pivot pin	1	703137	6
4	" pivot pin washer	1	700265	1
5	Split pin	1	702027	1
6	Screw for point bracket	1	703025	2
7	Washer, brass	1	703024	1
8	Low tension terminal bush	1	703138	4
9	Washer	1	703027	1
10	Nut	1	703139	2
11	Spring	1	703033	2
12	Insulating washer	1	703023	1
13	Washer	1	703027	1
14	Low tension terminal screw	1	703140	2
15	Felt greaser pad for contact breaker cam	1	703141	2
16	Clip for greaser pad	1	703142	2
17	Screws for clip	2	900155	1

* Manufacturers current price.

L15 — CADET 150

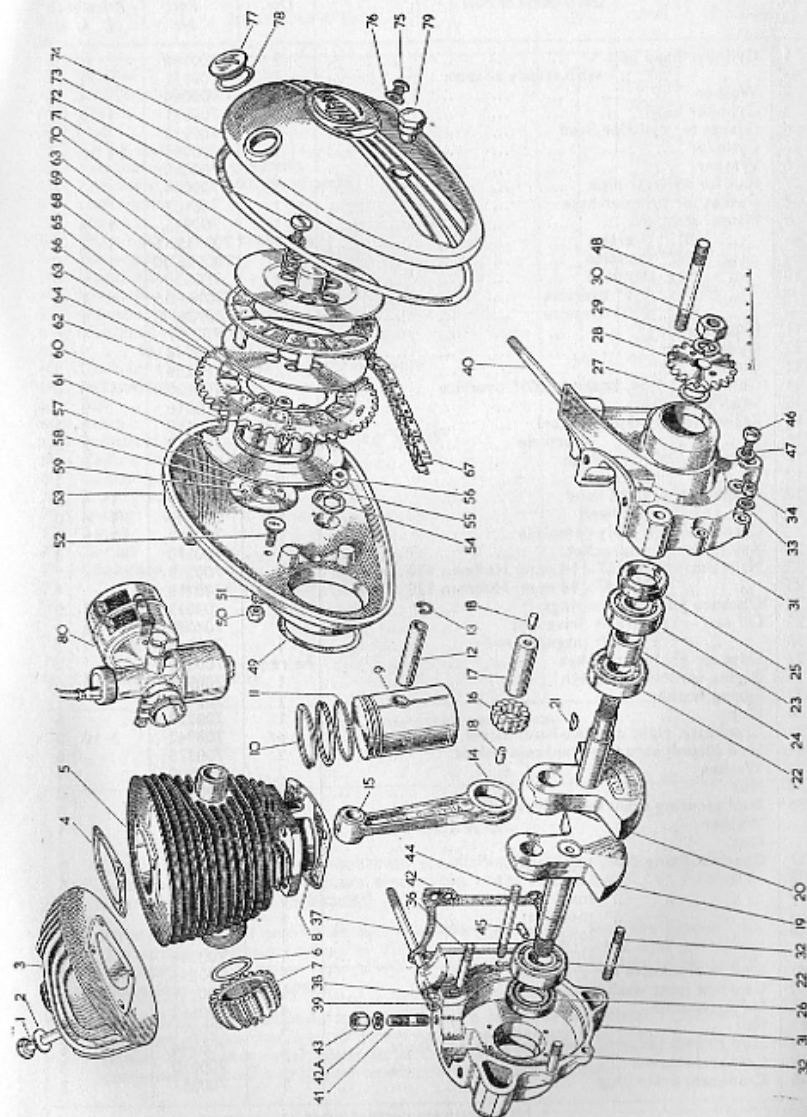

L15—CADET 150

Ill. No.	Description of Part	Qty.	Part No.	Price each £ s. d.
1	Cylinder head bolt	3	700166	10
—	" " " with steady adaptor	1	700951	1 6
2	Washer	4	900044	1
3	Cylinder head	1	700931	1 12 6
4	Gasket for cylinder head	1	700932	6
5	Cylinder	1	700933	3 15 0
6	Washer	1	700065	4
7	Nut for exhaust pipe	1	700934	3 6
8	Gasket for cylinder base	1	700163	3
9	Piston, standard	1	700935	1 2 0
—	" -.015" oversize	1	700935/15	1 2 0
—	" -.030" oversize	1	700935/30	1 2 0
10	" ring, standard	2	700936	1 9
—	" ring, .015" oversize	2	700936/15	1 9
—	" ring, .030" oversize	2	700936/30	1 9
11	Expander ring	2	700937	1 0
12	Gudgeon pin	1	700938	2 6
13	Circlip	2	700289	3
14	Connecting Rod, bushed, -.001" oversize	1	704028	1 0 0
15	Small end bush	1	700216	2 0
16	Rollers for crankpin—steel	12 set	700188	3 3
16	" " " —bronze	6 set	700212	2 0
17	Crankpin, .001" oversize	1	704029	5 0
18	" plug	2	700186	3
19	Crankshaft—right hand	1	700939	1 4 0
20	" —left hand	1	700940	1 4 0
—	Crankshaft assembly complete	1	700950	3 15 0
21	Key for engine sprocket	1	700370	3
22	Main bearing 20 x 47 x 14 m.m. Hoffman 120	2	700213	*
23	" " " 20 x 47 x 14 m.m. Hoffman 120	1	700213	*
24	Distance piece for bearings	1	704033	1 0
25	Oil seal—crankshaft drive end	1	704040	3 3
26	" " —crankshaft magneto end	1	700214	2 3
27	Shim for engine sprocket	As reqd.	700220	2
28	Engine sprocket 23 teeth	1	700941	6 6
29	Spring washer	1	700277	1
30	Nut	1	700219	6
31	Crankcase, right and left-hand halves, less fittings	1 pr.	700942	3 10 0
32	Stud (fitted) securing crankcase halves	2	700375	6
33	Washer	2	900008	1
34	Nut	2	700200	2
36	Stud securing crankcase halves	1	704043	3
—	Washer	2	900008	1
—	Nut	2	700200	2
37	Gearbox fixing stud, top right	1	700943	9
38	" " " washer	1	700662	1
39	" " " nut	1	700197	2
—	" " " medium	1	700194	9
40	" " " long	1	700195	9
—	" " " short	1	700244	3
41	Stud in crankcase for cylinder	4	700243	3
42	Gearbox joint washer	1	700211	2
42A	Spring washer	4	700662	1
43	Nut	4	700091	2
44	Stud (fitted) securing crankcase halves—short	2	700944	6
45	Crankcase dowel	2	700030	3
46	Crankcase drain plug	1	700257	3

* Manufacturers current price.

L15—CADET 150

Ill. No.	Description of Part	Qty.	Part No.	Price each £ s. d.
47	Washer	1	700283	1
48	Stud for chaincase	1	700239	7
49	Gasket	1	704045	1
50	Nut	1	900027	2
51	Spring washer	1	700399	1
52	Breather valve for chaincase	1	700215	1 0
53	Chaincase, inner, with gland plate	1	704046	1 10 0
54	Lockwasher	1	700201	3
55	Screw	1	700050	2
56	Cone nut for inner chaincase	1	700202	5
57	Felt washer	1	700174	4
58	Gland plate	1	700175	9
59	Rivets for gland plate	4	700176	set 3
60	Dowel for outer chaincase	1	700294	2
61	Clutch centre assembly	1	700949	1 10 0
62	" sprocket assembly 51 teeth	1	700222	1 2 6
63	Cork for clutch sprocket and corked plate	30	700226	set 2 6
64	Ball retaining plate	2	700223	1 3
65	Ball	50	000162	set 1 6
66	Rivet	15	700224	set 4
67	Endless chain (64 links) Renold $\frac{3}{8}$ " x $\frac{1}{4}$ " x .225"	1	704184	*
68	Centre plate	1	700227	5 0
69	Corked plate	1	700228	6 6
70	Front plate assembly	1	700230	8 0
71	Spring	6	700258	4
72	Screw	6	700259	7
73	Gasket	1	700173	1 0
74	Chaincase, outer	1	704047	17 6
75	" oil level screw	1	704068	3
76	Washer	1	700283	1
77	Oil filler plug	1	704048	1 3
78	Washer	1	704049	2
79	Nut	1	704044	9
80	Carburettor complete	1	702200	3 5 0

* Manufacturers current price.

REPAIRS

Our Service Department Workshops are staffed by experts who specialize in repair work, and all repairs are carried out under the terms of our 3 months Guarantee (see inside back cover)

If required we will provide an estimate before proceeding with the repairs. As this entails a certain amount of dismantling to ascertain what new parts are necessary, a small labour charge will be made for the preliminary inspection if the estimate is not accepted.

When further examination or tests reveal a need for additional replacement parts, we reserve the right to fit the extra parts necessary to make an efficient repair. We do not undertake to fit parts specified by the customer when further components should be replaced to effect a satisfactory overhaul.

4

VILLIERS TYPE 8E AND 7E **Engine 197 cc**

K7 — CAPTAIN 200

K7C — COTSWOLD 200

K7T — COMMANDO 200

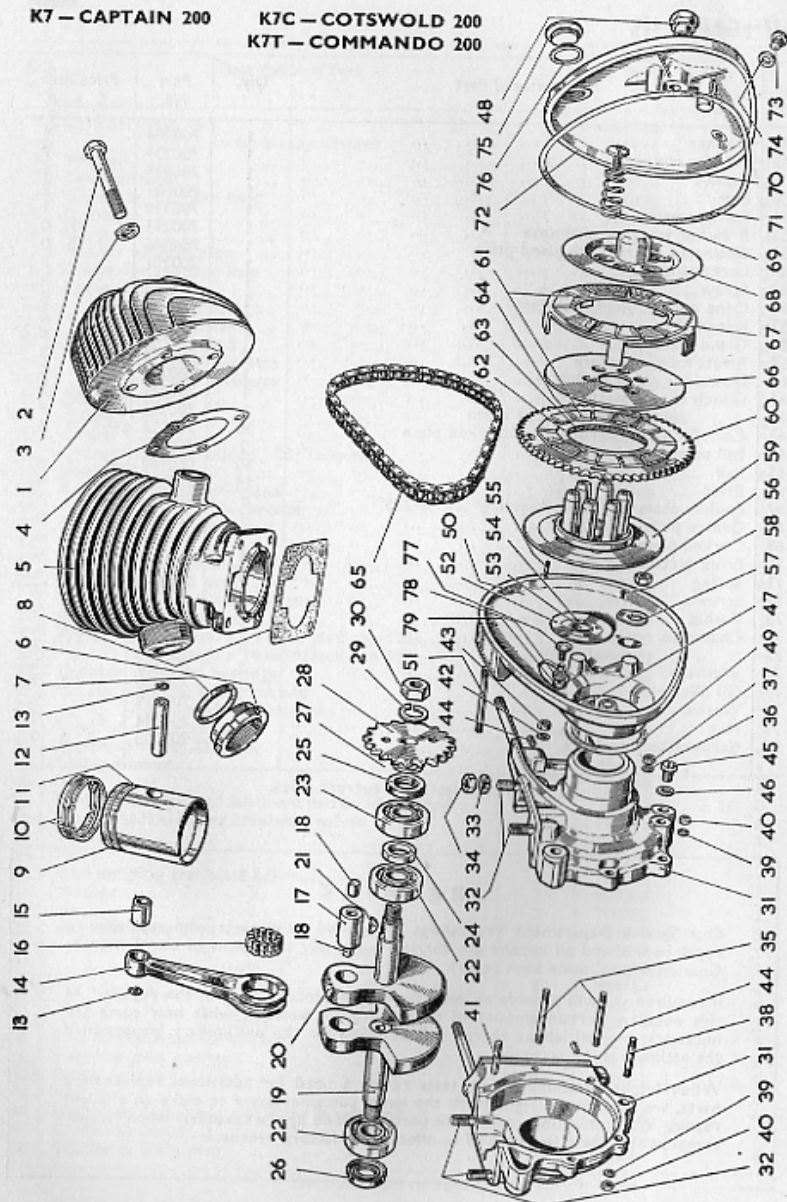

- 30 -

Engine 197 cc VILLIERS TYPE 8E AND 7E

4

K7 — CAPTAIN 200

K7C — COTSWOLD 200

K7T — COMMANDO 200

Ill. No.	Model	Description of Part	Qty.	Part No.	Price each £ s. d.
1	K7	Cylinder head (no decompressor) ...	1	704036	2 0 0
—	K7C-K7T	" " (decompressor type) ...	1	704153	2 2 6
—	"	Release valve body ...	1	700058	3 9
—	"	" stem ...	1	700059	2 0
—	"	" spring ...	1	700060	3
—	"	" cable nut ...	1	700061	1 0
—	"	" cable clamp ...	1	700092	9
—	"	" clamp screw ...	1	700271	3
—	"	" joint washer ...	1	700272	2
2	All	Cylinder head bolt (4 on K7 — 3 on Comps.)	—	700378	1 0
—	K7C-K7T	" head steady stud ...	1	700952	1 6
3	All	Washer ...	4	900011	1
4	All	Gasket for cylinder head ...	1	700398	6
5	K7	Cylinder (integral inlet manifold — 3 speed)	1	700404	4 0 0
5	K7C-K7T	" (without inlet manifold) ...	1	704168	4 0 0
—	All	Inlet manifold, bent (4 speed models) ...	1	700394	10 0
—	"	Manifold stud ...	1	700090	3
—	"	Nut for stud ...	1	700200	2
—	"	$\frac{1}{8}$ " spring washer ...	1	700662	1
—	"	Manifold joint washer ...	1	700355	3
6	"	Exhaust pipe finned nut ...	1	704169	4 0
7	"	Washer ...	2	700374	4
8	"	Gasket for cylinder base ...	2	700360	3
9	"	Piston, standard ...	2	700356	1 7 6
—	"	" .015" oversize ...	1	700356/1	5 1 7 6
—	"	" .030" oversize ...	1	700356/3	0 1 7 6
10	"	ring, standard ...	2	700357	1 9
—	"	" .015" oversize ...	1	700357/1	5 1 9
—	"	" .030" oversize ...	1	700357/3	0 1 9
11	"	Expander ring ...	1	704155	1 0
12	"	Gudgeon pin ...	1	700368	2 6
13	"	Circlip ...	2	700289	3
14	"	Connecting rod, bushed ...	1	700366	1 0 0
15	"	Small end bush ...	1	700367	2 0
16	"	Rollers for crankpin — steel ...	26	700188	set 8 0
17	"	Crankpin ...	1	700364	5 0
18	"	" plug ...	2	700365	3
19	"	Crankshaft — right hand ...	1	700363	1 4 0
20	"	" — left hand ...	1	704038	1 4 0
—	"	" assembly complete ...	1	704039	4 1 9
21	"	Key for engine sprocket ...	1	700370	3
22	"	Main bearing 20 x 52 x 15 m.m. Hoffman 320	2	700380	*
23	"	" 20 x 47 x 14 m.m. Hoffman 120	1	700213	*
24	"	Distance piece for bearings ...	1	704033	1 0
25	"	Oilseal — crankshaft drive end ...	1	704040	3 3
26	"	" — crankshaft magneto end ...	1	700214	2 3
27	"	Shim for engine sprocket ...	as reqd.	700220	2
28	"	Engine sprocket ...	1	704041	8 0
29	"	Spring washer ...	1	700277	1
30	"	Nut ...	1	700219	6
31	"	Crankcase, right and left-hand halves, less fittings ...	1 pr.	704042	3 10 0
32	"	Stud in crankcase for cylinder ...	4	700243	3
33	"	Spring washer ...	4	700662	1
34	"	Nut ...	4	700197	2
35	"	Stud (fitted) securing crankcase halves ...	2	700375	6

† Also fitted on K7 models with 4 speed gearbox.

* Manufacturers current price.

- 31 -

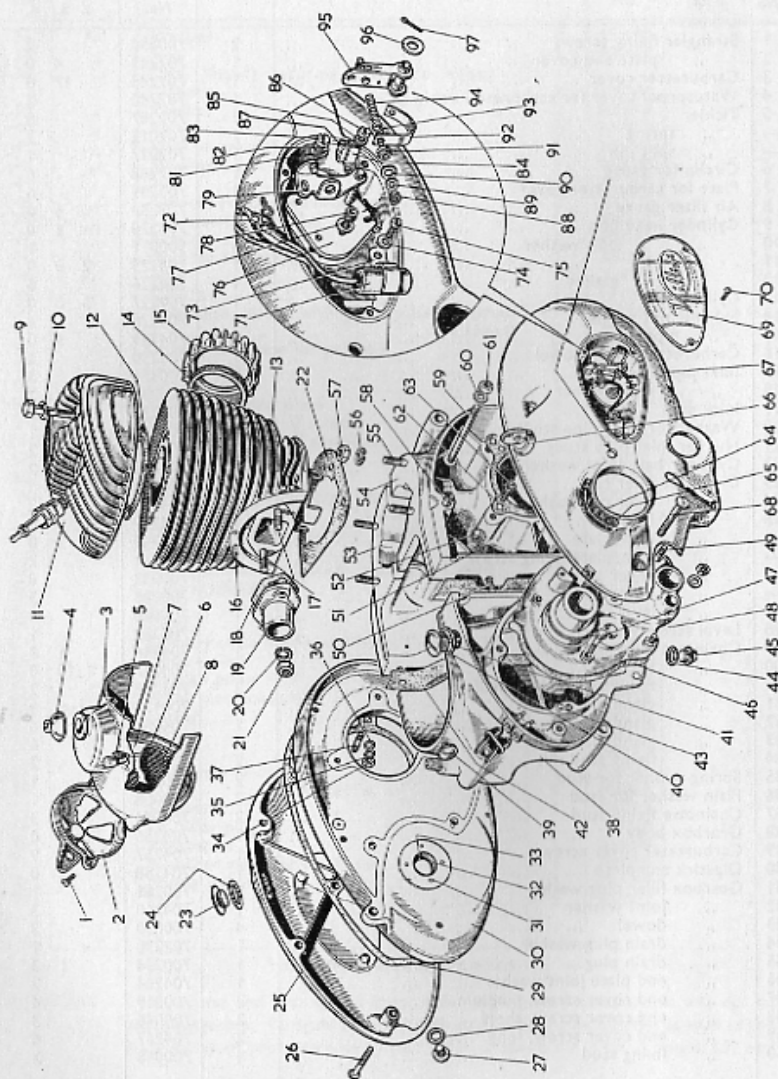
VILLIERS TYPE 1H **Engine 225 cc**K12 — COLONEL 225
INCLUDING CONTACT BREAKER PARTS**Engine 225 cc** VILLIERS TYPE 1H

continued from page 33

(including contact breaker parts)

Ill. No.	Description of Part	Qty.	Part No.	Price each £ s. d.
51	Gearbox fixing stud washer	4	700662	1
52	" fixing stud nut	4	700091	2
53	Crankcase, left hand	1	704271	2 10 0
54	" right hand	1	704272	2 10 0
—	" drain screw	1	700257	3
—	" drain screw washer	1	700283	1
55	Cylinder base stud	4	700948	3
56	" base stud washer	4	700662	1
57	" base stud nut	4	700197	2
58	R.H. crankcase dowel	2	704278	3
59	Crankcase fixing stud	4	704279	6
60	" fixing stud washer	8	900008	1
61	" fixing stud nut	8	900038	2
—	" fitting stud	2	704282	6
—	" fitting stud washer	4	900008	1
—	" fitting stud nut	4	900038	2
62	Armature plate joint washer	1	704285	2
63	" fixing screw	4	700032	3
64	Plate for gear indicator	1	704287	3
65	Fixing screw for plate	2	704288	2
66	Ignition switch complete	1	703170	12 0
67	Magneto cover	1	703171	1 5 0
68	" screw	1	700043	6
69	Contact breaker cover	1	703172	2 0
70	" fixing screw	3	703173	2
71	Condenser	1	703174	5 0
72	" lead shoe	1	703175	1
73	" clip	1	703176	2
74	" clip screw washer	1	703047	1
75	" clip screw	1	700050	2
76	Contact breaker base plate	1	703177	1 6
—	Cam for contact breaker	1	703178	3 0
—	Key for cam	1	703179	4
—	Circlip for ignition cam	1	703180	3
77	Washer for C.B. base plate screw	1	703181	1
78	Screw for C.B. base plate	1	703182	6
79	Point bracket	1	703183	2 3
81	" lock screw washer	1	703024	1
82	Adjuster plate clamp screw washer	1	700265	1
83	Point bracket screw	1	703025	2
84	Oil pad clip	1	703184	3
85	Washer for oil pad clip screw	1	703047	1
86	Screw for oil pad clip	1	700050	2
87	Oil pad	1	703185	2
88	L.T. terminal nut	1	703139	2
89	" washer	1	703023	1
90	" screw washer	1	703024	1
91	" bush	1	703138	4
92	Rocker arm earthing strip	1	703186	2
93	Point bracket pin	1	703140	2
94	Rocker arm spring	1	703033	2
95	Rocker arm	1	703136	5 0
96	Washer for rocker arm pivot pin	1	700265	1
97	Split pin for rocker arm pivot pin	1	702027	1

4

Engine 225 cc

K12 - COLONEL 225

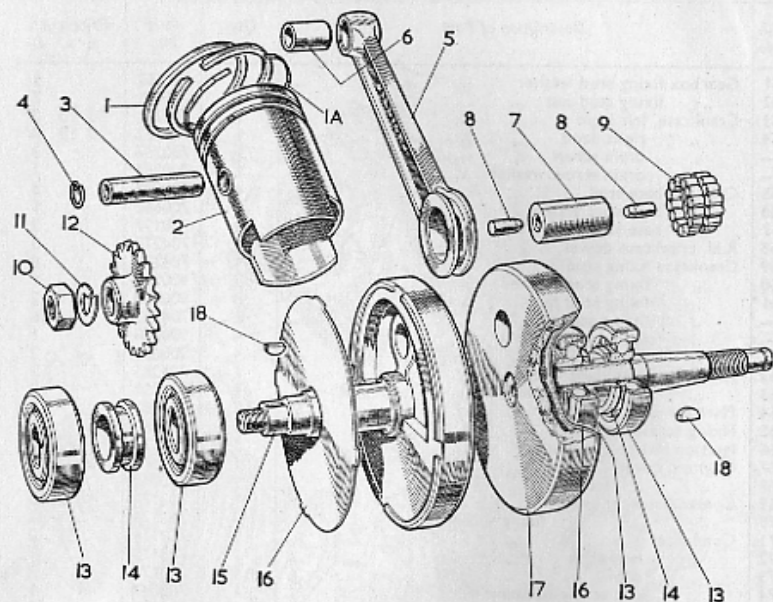

Ill. No.	Description of Part	Qty.	Part No.	Price each £ s. d.
—	Crankshaft assembly complete	1	704455	6 0 0
1	Piston rings	2	704445	1 9
1A	Expander ring	1	704446	1 0
2	Piston with bushes	1	704447	1 10 0
3	Gudgeon pin	1	704448	3 6
4	" " circlips	2	700289	3
5	Connecting rod with bush -001" O/S	1	704450	1 0 0
6	" " bush	1	700367	2 0
7	Crankpin -001" O/S...	1	704452	5 0
8	" " plugs	2	700365	3
9	Rollers for crankpin $\frac{1}{4}'' \times \frac{1}{4}''$	26	700188	set 8 0
10	Engine sprocket nut	1	700219	6
11	" " washer	1	700277	1
12	Engine sprocket, 20 teeth	1	704457	9 0
13	Main bearing 25 x 62 x 17 m.m. Hoffman 325	4	704458	*
14	Mainshaft ball bearing distance piece	2	704459	1 3
15	" " and flywheel, left hand	1	704460	2 2 0
16	Cover plate for mainshaft flywheel	2	704461	1 0
17	Mainshaft and flywheel, right hand	1	704462	2 2 0
18	Engine sprocket and flywheel generator key	2	700370	3
—	Oil seal	2	704322	3 0

* Manufacturers current price

Clutch

K12 - COLONEL 225

4

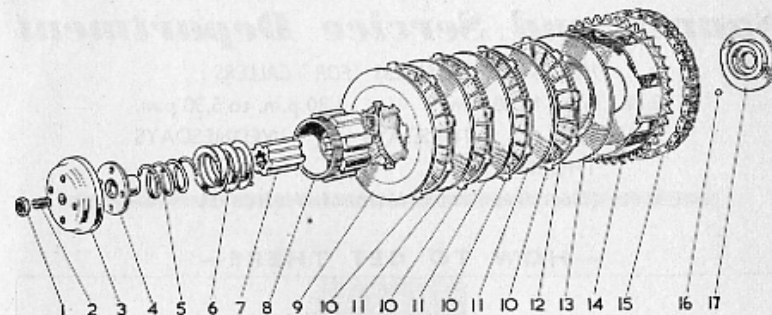

Ill. No.	Description of Part	Qty.	Part No.	Price each £ s. d.
1	Internal clutch adjuster lock nut	1	704418	4
2	Clutch adjuster screw internal	1	704419	3
3	" " cap nut	1	704420	6 0
4	" " centre nut	1	704421	4 0
5	" " inner spring	1	704422	6
6	" " spring	1	704423	1 6
7	" " hub	1	704424	6 0
8	" " sliding sleeve	1	704425	18 0
9	" " pressure plate	1	704426	3 6
10	" " driving plate	4	704427	6 0
11	" " intermediate plate	3	704428	3 6
12	" " corks	80	704429	set 5 0
13	" " back plate	1	704430	6 0
14	" " chainwheel assembly	1	704431	1 0 0
15	Primary chain $\frac{3}{8}'' \times \frac{1}{4}'' \times 225$ (60 links)	1	704184	* 1 3
16	Balls for roller track $\frac{3}{16}''$	24	000162	set 1 3
17	Clutch chainwheel ball track	1	704433	3 0
—	Packing shim	1	704399	3

* Manufacturers' current price

JAMES

Spares and Service Department

HOURS OF BUSINESS FOR CALLERS :
8.30 a.m. to 12.30 p.m. 1.30 p.m. to 5.30 p.m.
MONDAYS TUESDAYS WEDNESDAYS
THURSDAYS FRIDAYS
(Not Open on National Holidays)

— HOW TO GET THERE —

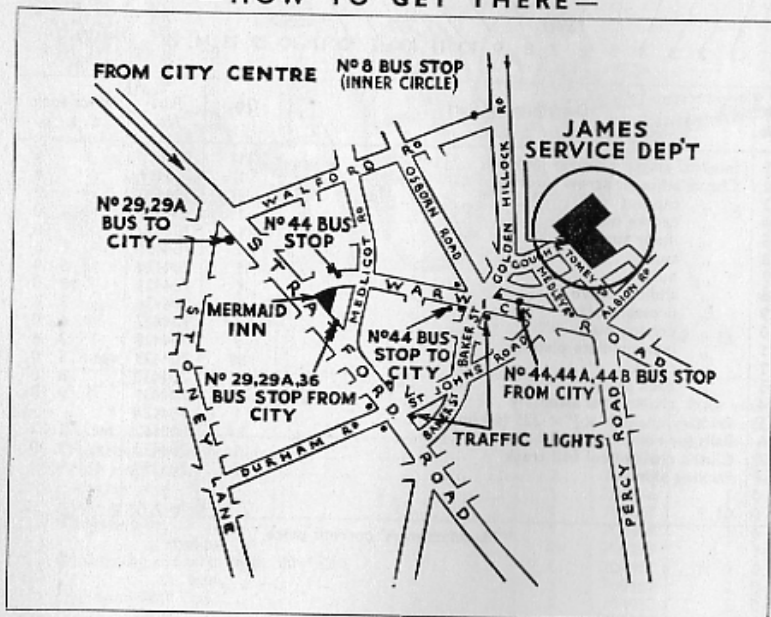

IMPORTANT

Dealers or private owners of James machines calling at the factory are requested to make an appointment by letter or telephone. This will avoid unnecessary waiting and ensure prompt attention to your enquiries.

JAMES MOTOR CYCLES LTD.
GREET, BIRMINGHAM, 11.
Tel. VICTORIA 2211 (5 lines)

Group 5

JAMES

Spares for
**Magnetos and
Lights**

5

Flywheel Generator

L1 - COMET 100

L1 Contact Breaker parts are listed in Group 4, pages 24 - 26.

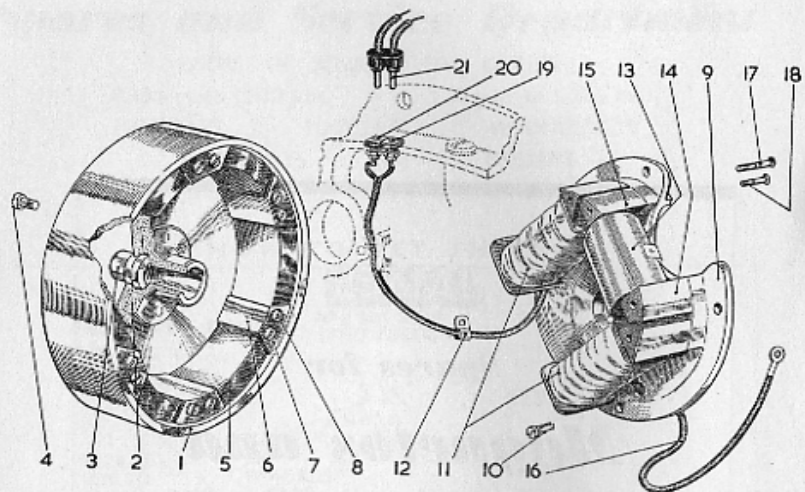

Ill. No.	Description of Part	Qty.	Part No.	Price each £ s. d.
1	Flywheel assembly (parts 1 to 8) ...	1*		
2	" centre ...	1*		
3	" centre nut ...	1*		
4	" centre screws ...	6*		
			703143	5 10 0
5	" magnets ...	6*		
6	" pole pieces ...	6*		
7	" pole plates ...	6		
8	" pole screws ...	12	703036	3
9	Armature plate assembly ...	1	703144	5 0 0
10	" securing screws ...	4	702024	3
11	Twin lighting coils complete with leads to sockets on engine casing ...	1 pair	703145	pr. 1 5 0
12	Clip securing lighting lead to armature plate ...	1	703146	1
13	Ignition coil ...	1	703147	1 10 0
14	" end, R.H. ...	1	703148	3 0 0
15	" end, L.H. ...	1	703149	3 0 0
16	Low tension lead and shoe (rubber covered cable) ...	1	703150	9
17	Screw for ignition and lighting coil ends ...	6	703035	3
18	Screw for ignition coil ends ...	2	703151	3
19	Small socket for lighting lead ...	1	703152	2 0
20	Large socket for lighting lead ...	1	703153	2 0
	Locking plate for sockets ...	1	703154	2
21	Twin plug for lighting lead ...	1	703155	3 0

* Not supplied separately

Flywheel Magneto

L15 - CADET 150

K7 - CAPTAIN 200

K7C - COTSWOLD 200

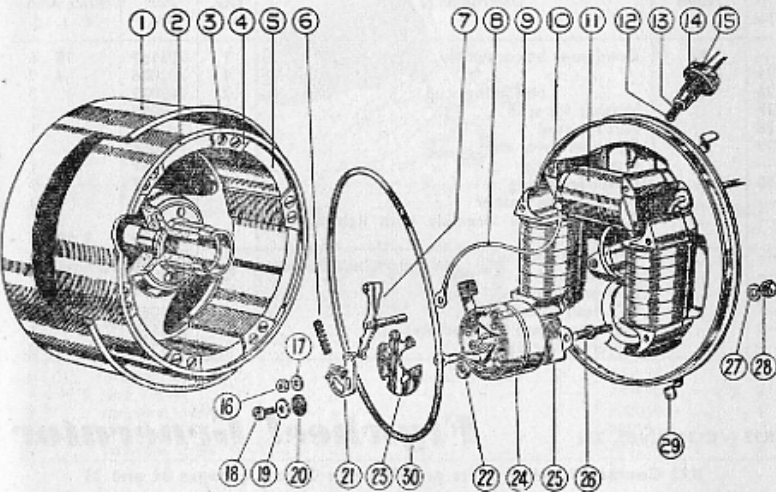

Ill. No.	Model	Description of Part	Qty.	Part No.	Price each £ s. d.
1	All	Flywheel cover ...	1	703065	7 6
2	"	" assembly ...	1	703156	6 2 6
3	"	Screw, pole shoe ...	12	703073	4
4	"	Top plate, pole shoe, iron ...	5	703072	3
4	"	" " " " brass ...	1	703071	4
5	"	Magnet ...	6	703070	9 0
6	"	Rocker arm spring ...	1	703033	2
7	"	" " " " " ...	1	703059	4 0
8	"	Low tension lead ...	1	703044	6
9	"	Lighting coils with cheeks ...	1 pr.	703163	1 6 0
10	"	H.T. coil end, left-hand ...	1	703018	2 9
10	"	" coil end, right-hand ...	1	703019	2 9
11	L15-K7	" coil ...	1	703015	1 10 0
11	K7C-K7T	" coil ...	1	703200	1 10 0
12	All	" terminal pad ...	1	703013	2
13	"	" terminal spring ...	1	703012	1
14	"	" terminal felt washer ...	1	703011	2
15	"	" terminal ...	1	703010	1 0
	"	" terminal cover ...	1	703046	7
16	"	Nut, L.T. lead ...	1	900129	2
17	"	Brass washer ...	7	703027	1
18	"	Lockscrew, point bracket ...	1	703025	2
19	"	Brass washer ...	1	703024	2
20	"	Insulating washer ...	1	703023	1
21	"	Point bracket ...	1	703167	2 3
22	"	Point bracket adjuster cam ...	1	703166	6
23	"	Insulating pad ...	1	703165	4
24	"	Condenser box ...	1	703168	4 6

continued from page 43

Model	Description of Part	Qty.	Part No.	Price each £ s. d.
L15-K7-K12	Rim clip	1	701701	
"	clip screw	1	701702	
K7	Rubber bead — headlamp — fork top ...	1	003069	
K7C-K7T	Spacer — headlamp	2	003220	
L1-L15 K7C-K7T	Main switch complete	1	701548	
K7	" " complete	1	701573	
K12	" " complete	1	701692	
All	" " control lever	1	701559	
"	" " control lever fixing screw ...	1	701560	
"	" " rubber ring	1	701520	
"	" " spring clips	1	701519	
L1 K7C-K7T	Bulb holder — pilot	1	701546	
"	" " — main	1	701545	
L15-K7-K12	" " — pilot (with wire)	1	701699	
"	" " — main	1	701706	
L1 K7C-K7T	Pilot bulb 3.5 volt, .15 amp. M.E.S. ...	1	701631	
L15	" " 3.5 volt, .15 amp. M.B.C. ...	1	701677	
K7-K12	" " 6 volt, 3 watt M.B.C. ...	1	701639	
L1 K7C-K7T	Main bulb 6 volt, 24/24 watt B.C. ...	1	701642	
K7	" " 6 volt, 24/24 watt B.P.F. ...	1	701647	
L15-K12	" " 6 volt, 30/24 watt B.P.F. ...	1	701655	
L1 K7C-K7T	Wiring harness	1	701558	
L15	" "	1	701676	
K7	" "	1	701581	
K12	" "	1	701693	
L15-K7-K12	Rubber grommet (headlamp shell) ...	1	701700	
All	Connector — wiring cables	—	002499	
"	" — plug	—	002489	
K7-K12	Ammeter	1	701516	
"	" rubber ring	1	701517	
L1-L15 K7C-K7T	Dipper switch	1	701549	
K7-K12	" " and horn button	1	000586	
L1-L15	Tail light complete	1	002674	
K7-K12	" " complete	1	002345	
K7C-K7T	" " complete	1	003403	
L1-L15	" " rubber moulding	1	701679	
K7-K12	" " rubber moulding	1	701707	
L1-L15	" " back plate	1	701680	
K7-K12	" " back plate	1	701708	
L1-L15	" " bulb holder	1	701681	
K7-K12	" " bulb holder	1	701709	
L1-L15	" " leads and contacts assembly ...	1	701682	
K7-K12	" " leads and contacts assembly ...	1	701710	
All (roadsters)	" " screws for back plate	3	701683	
"	" " washers for back plate	3	701684	
"	" " nuts	3	701685	
"	" " red plastic lens	1	701686	
"	" " clear plastic window	1	701689	
"	" " fixing screws	2	701687	
"	" " rubber washers	2	701688	
L1-L15 K7C-K7T	" bulb 6 volt, 3w. M.B.C.	1	701639	
K7-K12	" bulb 6 volt, 3/18w. offset	1	701638	
"	Rectifier and cables	1	000463	
"	Hex bolt $\frac{3}{8}$ " x 26 t.p.i.	4	900165	
"	Insulator	4	000465	
"	Fibre washer	4	900168	
"	Shakeproof washer	4	900006	
"	Hex nut $\frac{3}{8}$ " x 26 t.p.i.	4	900016	
"	Battery 6 volt Lucas (dry charged) ...	1	002835	
* L15	" 6 volt Lucas (dry charged) ...	1	003870	

* optional equipment

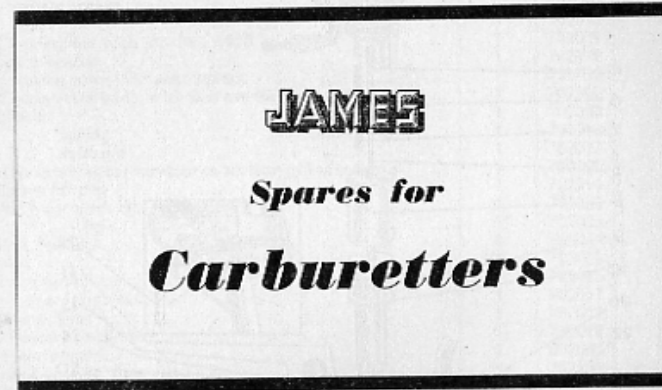

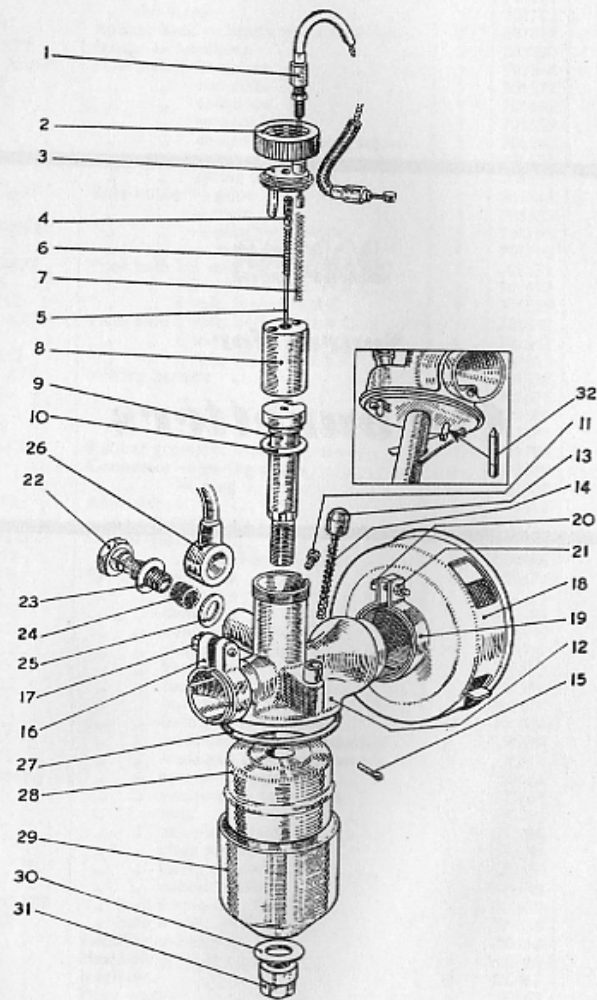

Ill. No.	Description of Part	Qty.	Part No.	Price each £ s. d.
1	Control cable complete	1	702031	5 0
2	Top ring	1	702007	1 6
3	" disc with guide peg	1	702008	2 0
4	Adjuster for taper needle	1	702013	6
5	Taper needle, No. 2½	1	702014	1 0
6	" spring	1	702015	2
7	Throttle spring	1	702012	2
8	"	1	702011	3 0
9	Centrepiece with jet, No. J.120	1	702029	5 0
10	Fibre washer	1	702030	1
11	Locating screw for centrepiece	1	702028	3
12	Carburettor body, with fuel needle lever and bush	1	702000	9 6
13	Tickler	1	702002	9
14	" spring	1	702012	2
15	" split pin	1	702027	1
16	Clip securing carburettor to stub on cylinder barrel	1	702009	2 3
17	Screw for clip	1	702010	8
18	Air filter with clip	1	702022	7 0
19	" clip	1	702023	9
20	Bolt for clip	1	702024	3
21	Nut	1	702025	2
22	Banjo union bolt	1	702016	1 3
23	Washer, large hole	1	702017	1
24	Gauze filter	1	702019	8
25	Washer, small hole	1	702018	1
26	Banjo union	1	002000	2 0
27	Joint washer, float cup	1	702001	2
28	Float	1	702003	3 6
29	" cup	1	702004	2 6
30	Washer for bottom nut	1	702006	1
31	Bottom nut	1	702005	1 3
32	Fuel needle	1	702021	10

REPAIRS

Our Service Department Workshops are staffed by experts who specialize in repair work, and all repairs are carried out under the terms of our 3 months Guarantee (see inside back cover)

If required we will provide an estimate before proceeding with the repairs. As this entails a certain amount of dismantling to ascertain what new parts are necessary, a small labour charge will be made for the preliminary inspection if the estimate is not accepted.

When further examination or tests reveal a need for additional replacement parts, we reserve the right to fit the extra parts necessary to make an efficient repair. We do not undertake to fit parts specified by the customer when further components should be replaced to effect a satisfactory overhaul.

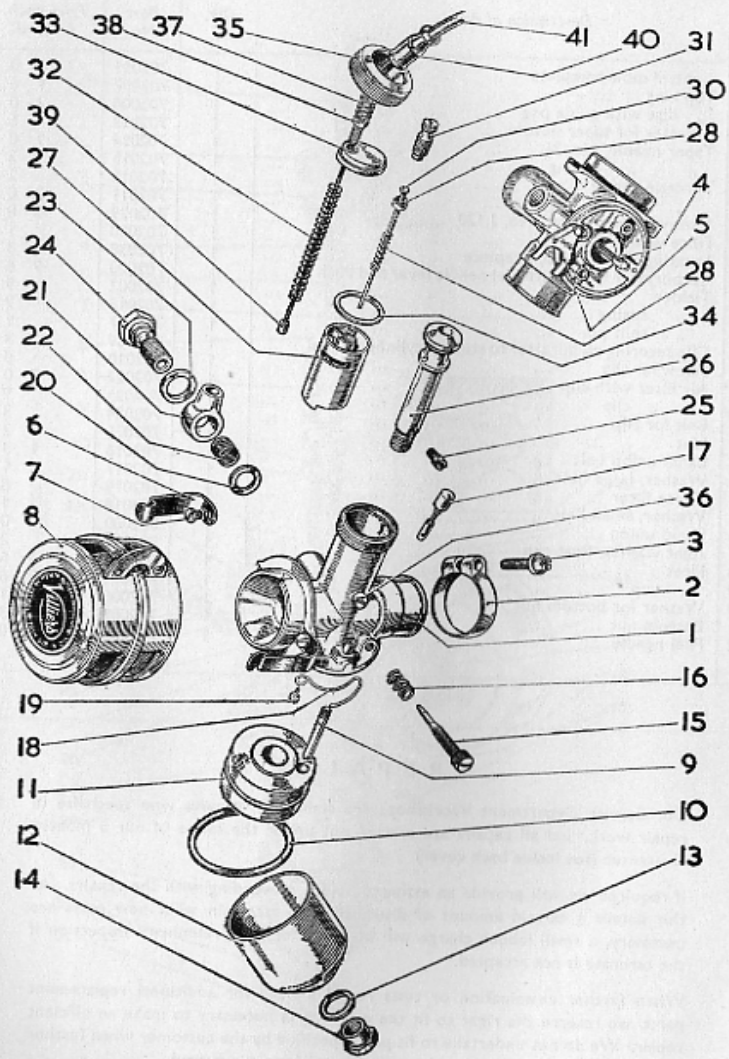

Ill. No.	Description of Part	Qty.	Part No.	Price each £ s. d.
—	Carburetter complete	1	702200	3 5 0
1	Body with fuel bush	1	702201	15 0
2	.. clip	1	702202	2 3
3	.. clip screw	1	702217	6
4	Fuel needle	1	702021	10
5	.. lever	1	702203	8
6	Air filter clip	2	702218	3
7	Screw for clip	2	702219	1 1
8	Air filter	1	702220	11 0
9	Pilot jet	1	702221	1 0
10	Cup joint washer	1	702001	2
11	Float	1	702204	4 0
12	.. cup	1	702205	2 6
13	Bottom nut washer	1	702030	1
14	Bottom nut	1	702263	1 0
15	Pilot jet needle	1	702224	10
16	Spring for needle	1	702225	2
17	Tickler	1	702206	6
18	.. spring	1	702207	2
19	Screw for spring	1	900155	1
20	Washer, small hole	1	702018	1
21	Banjo union	1	002000	2 0
22	Filter gauze	1	702019	8
23	Washer, large hole	1	702017	1
24	Banjo bolt	1	702016	1 3
25	Main jet, centrepiece	1	702270	6
26	Centrepiece	1	702209	4 0
27	Throttle	1	702271	4 0
28	Needle spring	1	702229	2
29	.. collar	1	702230	2
30	Taper Needle No. 3½	1	702231	9
31	Needle adjuster	1	702232	7
32	Throttle spring	1	702064	4
33	Top disc	1	702211	1 0
34	.. washer	1	702273	1
35	.. ring	1	702213	1 6
36	Throttle guide screw	1	702214	2
37	Cable adjuster	1	702032	8
38	Adjuster locknut	1	700824	1
39	Cable nipple	1	702091	1
40	.. cover	1	702234	4
41	.. complete	1	702276	5 0

continued from page 51

Ill. No.	Model	Description of Part	Qty.	Part No.	Price each £ s. d.
—	K7-K7C-K7T	Air filter and choke	1	702220	11 0
—	..	Clip for air filter	2	702218	3
—	..	Screw for clip	2	702219	1
—	K12	Felt ring for cover joint	1	702155	3

IMPORTANT

ORDERS FOR SPARE PARTS SHOULD BE SENT IN LIST FORM ON ONE SIDE OF A SHEET OF PAPER AND NOT AS PART OF A LETTER.

THE COMPLETE FRAME AND ENGINE NUMBERS AS WELL AS PART NUMBERS AND DESCRIPTIONS SHOULD BE QUOTED ON EACH ORDER.

OLD PARTS SENT AS PATTERNS WILL BE SCRAPPED UNLESS CUSTOMER SPECIFIES OTHERWISE.

JAMES
Spares for
Gearboxes

7 Gearbox & Clutch—2 speed

L1—COMET 100

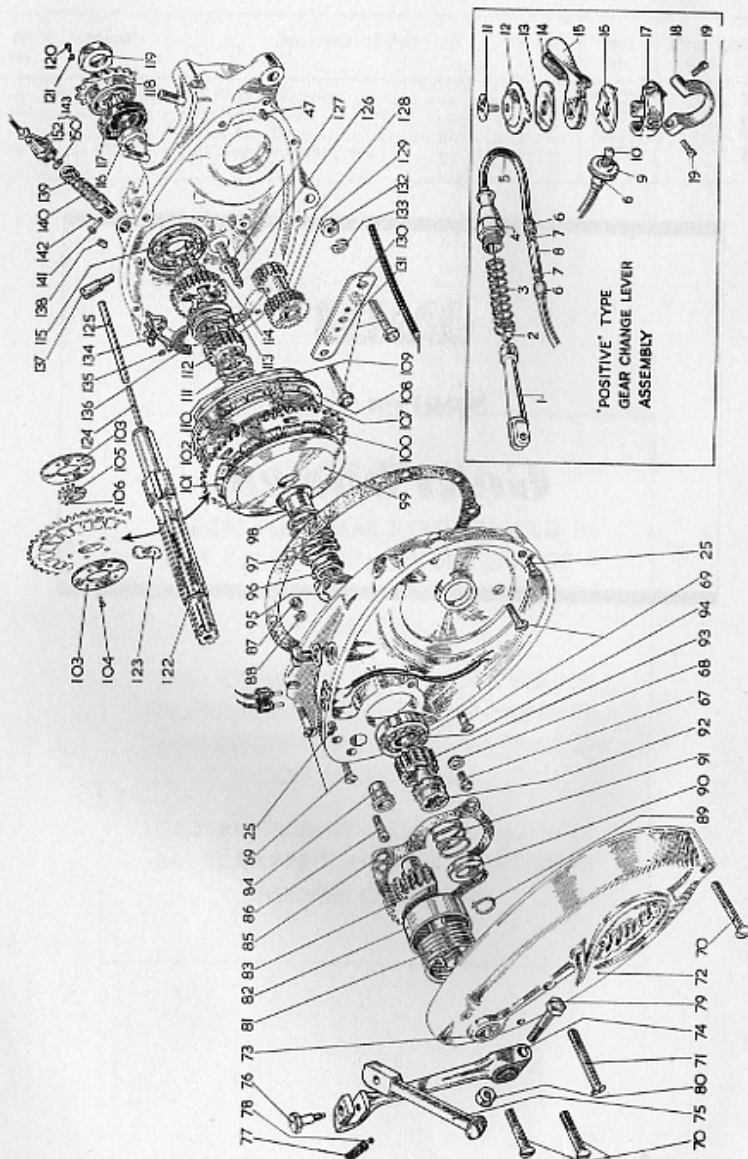

Gearbox & Clutch—2 speed

L1—COMET 100

Ill. No.	Description of Part	Qty.	Part No.	Price each £ s. d.
67	Oil level plug	1	700257	3
68	Washer	1	700283	1
69	Screws securing clutchcase to gearcase	5	700046	3
70	Screws securing flywheel cover to clutchcase	3	700043	6
71	Screw securing flywheel cover to clutchcase	1	703133	4
72	Flywheel cover	1	703134	1 15 0
73	Bush for kickstarter shaft	1	700045	3 3
74	Kickstarter lever	1	700313	11 0
75	.. pedal	1	700314	5 0
76	.. pedal pivot pin	1	700315	7
77	.. pedal spring	1	700317	1
78	.. pedal ball	1	000371	1
79	Clamp bolt for kickstart lever	1	700318	8
80	Nut	1	700319	4
81	Kickstarter return spring	1	700144	1 0
82	.. return spring cover	1	700143	1 3
83	.. shaft	1	700141	17 6
84	Bush in clutchcase for kickstarter shaft	1	700354	2 0
85	Gasket, kickstart cover	1	704011	1
86	Kickstarter stop pin	1	700041	3
87	Nut for stop pin	1	700091	2
88	Spring washer	1	700662	1
89	Circlip	1	700126	2
90	Spring retaining washer	1	700131	3
91	1	700130	2
92	Kickstarter ratchet	1	700129	6 0
93	.. pinion	1	700127	8 6
94	Ball bearing 20 x 42 x 9 m.m. FBC 6004	1	700125	*
95	Splined lockwasher	1	700120	3
96	Clutch spring retaining nut	1	700111	1 0
97	1	700086	1 3
98 locating bush	1	700088	1 0
99	Outer clutch plate, R.H.	1	700076	6 0
100	Clutch sprocket with cork inserts	1	700077	12 6
101	Large clutch cork for clutch sprocket and corked plate	25	700079	Set 2 1
102	Small clutch cork for clutch sprocket only	5	700078	Set 5
103	Side plate for clutch sprocket ball bearing	2	700080	5
104	Rivets for plate	5	700081	Set 1
105	Ball race	1	700082	2 6
106	.. bearing	33	700113	6
107	Centre clutch plate, dished	1	700085	5 6
108	Clutch plate, with cork inserts	1	700083	6 0
109	Outer clutch plate, L.H.	1	700084	6 0
110	Circlip	1	700089	6
111	Splined washer, brass	1	700112	6
112	Low gear wheel	1	700108	13 0
113	Sliding dog clutch	1	704013	8 6
114	High gear wheel	1	700104	19 0
115	Ball bearing 25 x 52 x 15 m.m. FBC 6005	1	700105	*
116	Distance piece	1	704015	2 0
117	Oil seal	1	704003	3 0
118	Driving sprocket	1	704016	7 0
119	Retaining nut	1	700295	1 0
120	Locking screw for retaining nut	1	700050	2
121	Spring washer (not fitted)	—	—	—
122	Clutch shaft	1	700119	1 1 0
123	.. cotter	1	700134	2 0

* Manufacturers' current price

7 Gearbox & Clutch—2 speed

L1—COMET 100

continued from page 55

Ill. No.	Description of Part	Qty.	Part No.	Price each £ s. d.
124	Clutch push rod, short	1	700132	6
125	" push rod, long	1	700128	9
126	Countershaft spindle	1	700138	4 6
127	" washer	1	700137	9
128	" bushed	1	700135	17 6
129	" bush	2	700136	2 0
130	" bridge	1	700139	2 6
131	" bridge bolt	2	700318	8
132	Nut	2	700319	4
133	Spring washer	2	700662	1
134	Gear selector lever	1	704017	5 0
135	Pivot pin, selector	1	700148	3
136	Gear operating plate	1	704018	3 0
137	Spindle for selector lever	1	700147	2 0
138	Stop pin for selector lever	1	700031	4
139	Forked joint for gear selector	1	700149	3 0
140	Gear selector spring	1	700152	3
141	Pin securing forked joint to lever	1	700150	5
142	Split pin for above	1	700151	1

TWO-SPEED GEAR CONTROL. L1—COMET 100

(See illustration, page 54)

Ill. No.	Description of Part	Qty.	Part No.	Price each £ s. d.
—	Complete lever and cable assembly without forked joint and guide	1	704190	1 0 6
—	Control lever complete, less cable	1	704191	12 6
1	Forked joint for gear selector lever	1	700149	3 0
2	Cable nipple, engine end	1	704194	3
3	Gear selector spring	1	700152	3
4	Guide for forked joint	1	704196	1 6
5	Cable complete	1	704192	8 0
6	Adjusting screws	3	704197	7
7	Lock nuts	2	700824	1
8	Cable adjusting sleeve	1	700095	9
9	Finger lock nut	1	704200	1 0
10	Cable nipple, control end	1	704201	3
11	Top screw	1	704202	8
12	" cover	1	704203	6
13	Friction plate	1	704204	6
14	Trigger with spring	1	704205	1 0
15	Control lever	1	704206	3 6
16	Ratchet plate	1	704207	6
17	Control body	1	704208	3 6
18	" clip	1	702038	1 6
19	" clip screw	2	702039	2

7 Gearbox—3 speed

L15—CADET 150

K7—CAPTAIN 200

See illustration overleaf

Ill. No.	Model	Description of Part	Qty.	Part No.	Price each £ s. d.
1	L15-K7	Gearbox, bushed	1	704050	2 10 0
2	"	Bearing 25×52×15 m.m. Hoffman 125	1	700297	*
3	"	Oil seal	1	704003	3 0
4	"	Sprocket distance piece	1	704015	1 3
5	L15	Final drive sprocket 16 teeth	1	700953	6 0
5	K7	" " 18 teeth	1	700954	6 0
6	L15-K7	Locknut	1	700295	1 0
7	"	Screw for locknut	1	700050	2
8	"	Spring washer	1	700203	1
9	"	Sealing disc	1	700710	3
10	"	Oil filler plug	1	700255	1 3
11	"	Washer for plug	1	700281	1
12	"	Oil drain plug	1	700254	1 3
13	"	Washer for plug	1	702030	1
14	"	Layshaft bush	1	700234	6 9
15	"	Stud for end plate	3	700247	3
16	"	Dowel	2	700030	3
17	"	Selector pivot pin	1	704054	2 0
18	"	" quadrant	1	704055	1 0 0
19	"	" plunger	1	704056	5 0
20	"	Plunger spring short	1	704057	2
21	"	" long	1	700717	2
22	"	Oil level plug	1	700257	3
23	"	Washer for plug	1	700283	1
24	"	Bearing sealing washer	1	700298	4
25	"	Mainshaft	1	704212	1 0 0
26	"	High gear pinion	1	704059	1 0 0
27	"	Pressure washer	1	700332	9
28	"	Mainshaft sliding pinion	1	700302	11 0
29	"	" fixed pinion	1	700303	7 6
30	"	Layshaft	1	700307	17 6
31	"	" fixed pinion	1	700304	7 6
32	"	" sliding pinion	1	700306	11 0
33	"	Sliding gear operator	1	700329	2 6
34	"	Ratchet pinion	1	700308	18 6
35	"	Push rod headed	1	700250	9
36	"	" long	1	700262	8
37	"	" short	1	700263	5
38	"	Steel washer	2	700265	1
39	"	Felt washer	1	700388	1
40	"	Kickstart shaft, bushed	1	700312	1 4 0
41	"	" pawl	1	700309	1 9
42	"	" pawl plunger	1	700310	4
43	"	Plunger spring	1	700311	1
44	"	Sealing ring	1	704060	8
45	"	Operating spindle	1	700335	14 0
46	"	Sealing ring	1	704061	8
47	"	Pressure washer	1	700220	3
48	"	Spindle circlip	1	700126	2
49	"	Foot change lever	1	700349	10 0
50	"	Rubber for lever	1	700320	1 6
51	"	Bolt for foot lever	2	700318	8
52	"	Nut for bolt	2	700319	4
53	"	Ratchet spring	1	700344	6
54	"	Operating pawl	1	704062	12 0
55	"	" pawl spring	1	700343	1 0

* Manufacturers current price

7

Gearbox—3 speed

L15—CADET 150 K7—CAPTAIN 200

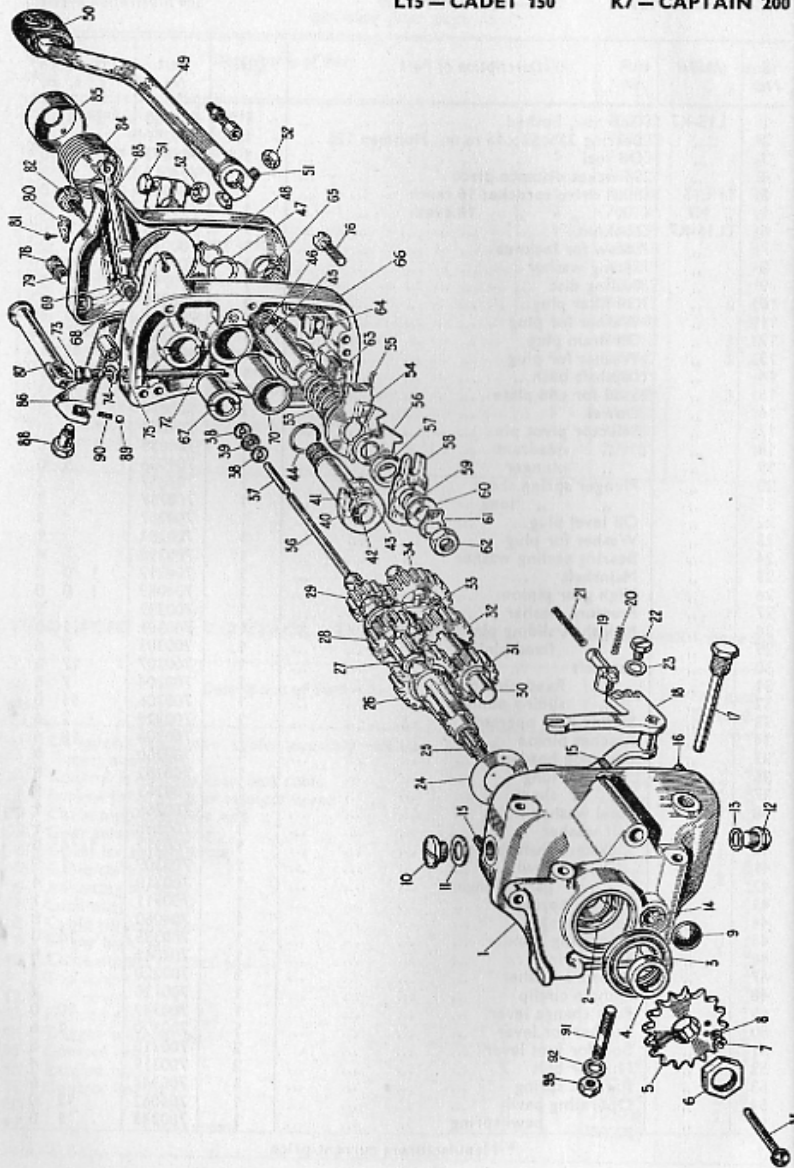
**Gearbox—3 speed**

continued from page 57

7

Ill. No.	Model	Description of Part	Qty.	Part No.	Price each £ s. d.
56	L15-K7	Operating spindle plate	1	704063	2 0
57	"	" spindle distance piece	1	700337	5
58	"	" lever	1	700347	9 0
59	"	" spindle shim	as reqd.	700338	2
60	"	" spindle washer	1	700339	1
61	"	" spindle lockwasher	1	700340	2
62	"	" spindle nut	1	700431	4
63	"	Stop pin	1	700348	2 0
64	"	Plunger box	1	704064	3 6
65	"	" nut	1	704065	1 0
66	"	End plate, bushed	1	704066	1 15 0
67	"	Mainshaft bush	1	700233	9 9
68	"	Adjuster bush	1	700330	8
69	"	" locknut	1	700331	3
70	"	Bush kickstart shaft	1	704067	4 0
71	"	" operating spindle	1	700232	5 6
72	"	Kickstart stop piece	1	700333	9
73	"	Screw for stop piece	1	700334	2
74	"	Dipstick	1	700290	1 9
75	"	Washer for dipstick	1	702283	1
76	"	End plate nut	3	700286	4
77	"	" screw	3	700251	4
78	"	Dust cover	1	700210	10 6
79	"	" screw	3	700292	3
80	"	Washer for screw	3	702282	1
81	"	Adjuster locking plate	1	700284	3
82	"	Fixing screw	2	900155	1
83	"	Clutch adjusting screw	1	700261	1 9
84	"	" lever	1	700260	3 0
85	"	Return spring	1	700326	1 0
86	"	Cap for spring	1	700325	1 3
87	"	Kickstart lever	1	700313	11 0
88	"	" pedal	1	700314	5 0
89	"	Pedal pivot pin	1	700315	7
90	"	Ball for pivot pin	1	000371	1
91	"	Spring for ball	1	700317	1
92	"	Stud	1	700244	3
93	"	Washer	1	900044	1
		Nut	1	700197	2

Gearbox - 4 speed

continued from page 61

Ill. No.	Model	Description of Part	Qty.	Part No.	Price each £ s. d.
46	All	K.S. pawl plunger	1	704095	6
47	"	" pawl plunger spring	1	704096	5
48	"	" shaft	1	704097	1 1 9
48a	"	" shaft bush	1	704099	5 3
49	"	" pawl	1	704094	3 0
51	"	" oil seal ring	1	704098	9
52	"	Selector plunger box washer and nut	1	704121	5
53	"	Selector plunger spring	1		
54	"	Drain plug	1	704123	9
55	"	Bearing 15x35x11 m.m. SKF 6022	1	001333	
56	"	Grease nipple	2	704131	9
57	"	K.S. return spring	1	704114	1 6
58	"	Short control lever	1	704130	5 3
59	"	Bearing cap	1	704106	5 3
60	"	Mainshaft nut, left hand thread	1	704083	6
61	"	Oil thrower	1	704082	1 6
62	"	K.S. stop plate pin	1	704093	3
63	"	Operator bush	1	704124	3 0
64	"	Clutch lever	1	704111	6 9
65	"	Bearing cap pins, 1" x 1/2" hex	1	704107	5
		3/8" x 1/2" hex	1	704108	5
66	"	Clutch lever adjuster sleeve and ball	1	704109	2 3
67	"	" pin	1	704110	9
68	"	Foot change rubber	1	704148	1 6
69	"	" lever	1	704146	6 9
70	"	Gearbox cap	1	704072	15 0
71	"	K.S. crank pinch pin, nut	1	704119	9
72	"	Cover pins, 3" x 1/4" ch.	4	704103	6
		1 1/8" x 1/4" ch.	2	704104	6
		1/2" x 1/4" ch.	3	704105	6
73	"	Clip bolt for lever	1	704147	3
74	"	Inspection cover	1	704112	5
75	"	" pin	1	704113	2
77	"	Nut for adjuster plate pin	2	704141	2
78	"	Adjuster plate pin	2	704129	9
79	"	Bush for adjuster pin	2	704128	2
80	"	Spring stop for adjuster plate	1	704126	3
	All	Chaincase inner half	1	704156	1 10 0
		Clutch centre assembly	1	704157	1 10 0
		Push rod headed	1	700747A	9
		" long 7 3/8"	1	704158	9
		" long 7 1/2"	1	704159	9
		" long 7 1/4" alternatives	1	704160	9
		" long 7 1/8"	1	704161	9
		Mainshaft nut...	1	704211	6
		" washer (spring)	1	704163	1
		Gearbox stud top left	1	704179	4
		" top right	1	704180	5
		" bottom	2	700090	3
		" nut	3	700197	2
		" nut	1	700091	2
		" washers	4	900044	3

* Manufacturers current price.

Gearbox - 4 speed

K12 - COLONEL 225

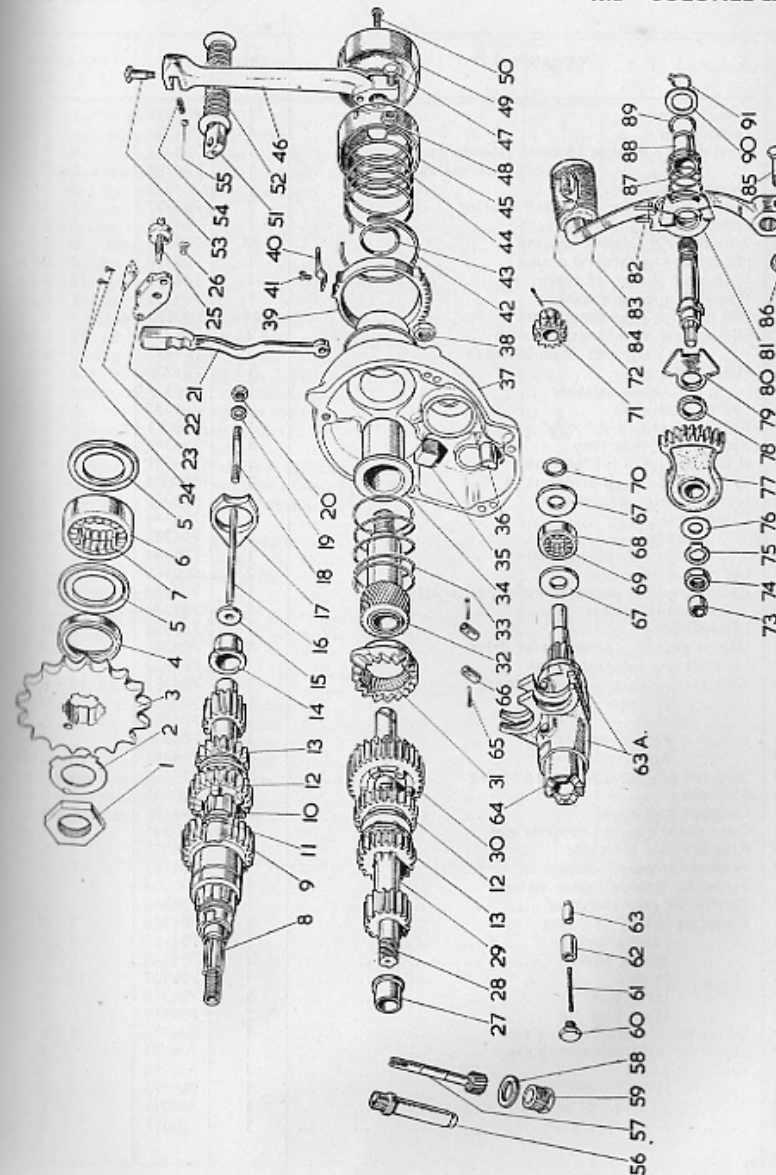

Gearbox - 4 speed

K12 - COLONEL 225

III. No.	Description of Part	Qty.	Part No.	Price each £ s. d.
1	Sprocket nut	1	704323	1 3
2	Lockwasher	1	704324	3
3	Final drive sprocket 18 teeth (standard)	1	704325	8 0
3	" " 17 teeth (alternative for S/c.)	1	704329	8 0
4	Gearbox oil seal	1	704326	4 0
5	Thrust washer for mainshaft bearing	2	704327	1 3
6	Mainshaft bearing outer race	1	704328	5 0
7	Rollers for mainshaft bearing	38	700188	set 8 0
8	Mainshaft c/w integral pinion	1	704330	2 0 0
9	High gear pinion, 27 teeth	1	704331	1 12 6
10	Mainshaft pressure washer	1	704332	1 0
11	Ball for high gear thrust race	16	000162	set 6
12	Sliding gear with dogs, 24 teeth	2	704334	12 6
13	" " without dogs, 20 teeth	2	704335	10 0
14	Mainshaft bush	1	704336	8 6
15	" rubber washer	1	704337	3
16	Clutch push rods	3	704338	6
—	Roller for clutch $\frac{3}{16}$ " x $\frac{3}{16}$ "	1	700011	3
17	Kickstart ratchet stop	1	704340	5 0
18	K.S. stop/clutch bridge stud	1	704341	3
19	Washer for clutch bridge stud	1	900004	1
20	Nut for clutch bridge stud	1	700200	2
21	Clutch lever	1	704344	3 0
22	" bridge	1	704345	4 0
23	" adjuster locking plate	1	700284	3
24	Locking plate screws	2	900155	1
25	Clutch adjuster screw assembly, external	1	704348	1 0
26	" bridge screw	1	704349	3
27	Layshaft bush	1	704350	6 0
28	Worm gear for speedometer drive	1	704351	4 0
29	Layshaft c/w integral pinion	1	704352	1 5 0
30	Kickstart ratchet pinion, 29 teeth	1	704353	1 10 0
31	" ratchet	1	704354	15 0
32	" shaft	1	704355	1 10 6
33	" ratchet spring	1	704356	4
34	" housing bush	1	704357	13 6
35	Stop for gear change return spring	1	704358	2 0
36	Stop pin	1	700348	2 0
37	Gearbox end cover	1	704360	2 0 0
38	Gear change spring retainer nut	1	700341	4
39	Ring for gear indicator	1	704362	1 6
40	Pointer for gear indicator	1	704363	3
41	Screw for gear indicator pointer	1	700204	2
42	Circlip for gear indicator	1	704365	3
43	Kickstart shaft "O" ring	1	704366	1 0
44	" return spring	1	704367	1 0
45	" spring cover	1	704368	1 3
46	" lever	1	704369	12 0
47	" lever bolt	1	700318	8
48	" lever bolt nut	1	700319	4
49	Cover for kickstart spring cap	1	704372	1 6
50	Screw for kickstart spring cap	1	704373	3
51	Kickstart pedal	1	700314	5 0
52	" lever rubber	1	704375	1 3
53	" pedal pivot pin	1	700315	7
54	" pedal spring	1	700317	1

Gearbox - 4 speed

III. No.	Description of Part	Qty.	Part No.	Price each £ s. d.
55	Ball for spring $\frac{1}{4}$ " dia.	1	000371	1
56	Bush for speedometer drive	1	704379	5 0
57	Worm wheel for speedometer drive	1	704380	4 0
58	Speedometer drive plug washer	1	704381	2
59	Plug for speedometer housing	1	704382	1 0
60	End plug for plunger	1	704383	6
61	Plunger spring	1	704384	2
62	" bush	1	704385	1 6
63	Plunger for cam	1	704386	9
63A	Sliding gear fork	2	704387	12 6
64	Cam barrel	1	704388	1 2 6
—	Thrust washer for cam barrel	1	704389	9
65	Split pin for sliding gear fork guide peg	2	704390	1
—	Bearing pin for cam barrel	1	704391	1 0
66	Guide peg for sliding gear fork	2	704392	6
67	Thrust washers for cam bearing	2	704393	1 0
68	Cam barrel bearing outer race	1	704394	2 6
69	Rollers for cam barrel bearing $\frac{3}{16}$ " x $\frac{2}{16}$ "	24	700011	set 6 0
70	Cam barrel "O" ring	1	704396	1 0
71	Pinion for cam barrel (gear indicator)	1	704397	1 0
72	Split pin for gear indicator pinion $1\frac{1}{8}$ " x $\frac{1}{16}$ "	1	704398	1
73	Operating spindle bush gearbox body	1	700235	1 0
74	" " nut	1	700341	4
75	" " lock washer	1	700340	2
76	" " shim	As reqd	700338	2
77	Quadrant for gear operation	1	704403	8 0
78	Distance piece	1	700337	5
79	Operating spindle plate	1	704405	2 0
80	" spindle	1	700335	14 0
81	" pawl	1	700342	10 0
82	" pawl spring	1	700343	1 0
83	Gear change lever	1	704409	8 0
84	Foot change gear lever rubber	1	700320	1 6
85	" " " bolt	1	700318	8
86	" " " nut	1	700319	4
87	" " ratchet spring	1	700344	6
88	Operating spindle bush gearbox end plate	1	704414	4 0
89	Gear change "O" ring	1	704061	8
90	Operating spindle washer	1	700339	1
91	" " circlip	1	700126	2

IMPORTANT

ORDERS FOR SPARE PARTS SHOULD BE SENT IN LIST FORM ON ONE SIDE OF A SHEET OF PAPER AND NOT AS PART OF A LETTER.

THE COMPLETE FRAME AND ENGINE NUMBERS AS WELL AS PART NUMBERS AND DESCRIPTIONS SHOULD BE QUOTED ON EACH ORDER.

OLD PARTS SENT AS PATTERNS WILL BE SCRAPPED UNLESS CUSTOMER SPECIFIES OTHERWISE.

JAMES

Spares for
Sundries

TANKS, MUDGUARDS, HANDLEBARS, SEATS,
TOOLBOXES, ETC.

IMPORTANT

From June 1956, certain models were offered in optional maroon or grey finish. Orders for enamelled components should clearly state the colour, as well as the usual model numbers, part numbers and descriptions.

Sundries

Model	Description of Part	Qty.	Part No.	Price each £ s. d.
L1-L15-K7C-K7T	PETROL TANK	1	003401	4 5 0
K7-K12	" " enamelled	1	003657	6 6 0
"	" " chromed panels	1	003191	7 16 0
"	Front tank bracket	1	003179	7 6
L1-L15-K7-K12	Hex bolt $\frac{3}{8}$ " x 26 x 3"	2	900041	4
K7-K12	" " $\frac{3}{8}$ " x 26 x 2 $\frac{1}{2}$ "	1	900074	4
"	" " $\frac{3}{8}$ " x 26 x 2 $\frac{1}{2}$ "	1	900119	4
"	" " $\frac{3}{8}$ " x 26 x 2 $\frac{1}{2}$ "	2	900133	3
All	Hex nut $\frac{3}{8}$ " x 26 t.p.i.	2	900000	2
"	Plain washer $\frac{3}{8}$ " dia.	4	900009	1
K7C-K7T	Spacer $\frac{3}{8}$ " thick	4	003659	6
All	Petrol tap	1	003166	5 6
"	Drain plug	1	900376	3
"	Fibre washer	2	900373	1
L1-L15-K7-K12	Petrol pipe 6"	1	002181	1 6
K7C-K7T	" " 5 $\frac{1}{2}$ "	1	002189	1 6
All	Ferrules	2	002063	4
"	Carburettor union	1	002000	1 9
"	Filler cap	1	003931	4 9
"	Synthetic sealing ring	1	003661	8
K7-K12	Knee grip — rubber L.H.	1	002365	4 0
"	" " " R.H.	1	002366	4 0
All	James tank badge (state colour)	2	002393	1 6
"	Rubber moulding	2	002816	1 0
"	Fixing screw, badge 2BA	4	900325	1
L1-L15	FRONT MUDGUARD	1	003590	19 6
K7-K12	" " "	1	003589	1 12 6
K7C-K7T	" " " aluminium	1	003038	1 5 0
L1-L15	Tubular stay (bottom)	1	003592	9 9
K7-K12	" " "	1	003013	9 9
K7C-K7T	" " "	1	003094	6 0
All	Cotter bolt $\frac{3}{8}$ " x 26 x $\frac{3}{8}$ "	2	900354	3
"	Plain washer $\frac{3}{8}$ " dia.	2	900009	1
L1-L15	Mudguard bridge	1	003473	3 3
K7-K12	" " "	1	003023	4 0
K7C-K7T	" " "	1	003868	11 0
L1-L15	Attachment clip	2	003475	2 1
K7-K12	" " " L.H.	1	003199	3 6
"	" " " R.H.	1	003020	2 6
All	Clip bolt $\frac{3}{8}$ " x 26 (1 only on L1-L15)	2	900094	8
L1-L15	Clip bolt and cable stop	1	003474	1 6
All	Hex nut $\frac{3}{8}$ " x 26 t.p.i.	2	900000	2
"	Plain washer $\frac{3}{8}$ " dia.	2	900009	1
"	Domed screw $\frac{1}{4}$ " x 26 t.p.i.	4	900315	3
"	Shakeproof washer	4	900004	1
"	Hex nut $\frac{1}{4}$ " x 26 t.p.i.	4	900027	2
L1-L15-K7-K12	FRONT NUMBER PLATE	1	002375	2 6
K7C-K7T	" " "	1	003217	2 6
L1-L15-K7-K12	Round head screw $\frac{3}{8}$ " x 26 t.p.i.	2	900010	1
"	Hex nut $\frac{3}{8}$ " x 26 t.p.i.	2	900016	1
"	Shakeproof washer $\frac{3}{8}$ "	2	900006	1
K7C-K7T	Mush head screw $\frac{1}{4}$ " x 26 t.p.i.	2	900315	3
"	Hex nut $\frac{1}{4}$ " x 26 t.p.i.	2	900027	1

Sundries

Model	Description of Part	Qty.	Part No.	Price each £ s. d.
K7C-K7T	Shakeproof washer $\frac{1}{8}$ "	2	900004	1
"	Competition number plate	1	003096	3 0
"	Hex bolt $\frac{3}{8}$ " x 26 t.p.i.	2	900354	3
"	Hex nut $\frac{3}{8}$ " x 26 t.p.i.	2	900000	2
"	Plain washer $\frac{3}{8}$ "	2	900009	1
L1-L15	REAR MUDGUARD (Including No. plate)	1	003396	4 10 0
K7-K12	" " "	1	003633	1 17 6
K7C-K7T	" " " (aluminium)	1	002338	1 5 0
"	Tubular stay	1	003635	5 0
K7-K12	Streamlined spacers — alloy	2	002341	2 6
K7C-K7T	Spacer	2	003220	9
"	Mudguard bracket (behind gearbox)	1	002822	5 0
"	Round head screw $\frac{3}{8}$ " x 26 t.p.i.	2	900010	1
"	Hex nut $\frac{3}{8}$ " x 26 t.p.i.	2	900016	1
"	Plain washer	2	900141	1
"	Mush head screw $\frac{1}{4}$ " x 26 t.p.i.	3	900315	3
K7-K12	Hex bolt $\frac{1}{2}$ " x 26 x $\frac{3}{8}$ "	2	900054	3
K7C-K7T	" " $\frac{1}{2}$ " x 26 x $\frac{3}{8}$ "	1	900024	3
K7-K12	" " $\frac{1}{2}$ " x 26 x 2"	1	900178	4
"	" nut $\frac{1}{2}$ " x 26 t.p.i.	—	900027	2
"	Plain washer $\frac{1}{2}$ " small	—	900008	1
"	" " " large	—	900045	1
"	Shakeproof washer	—	900004	1
K7-K12	Hex bolt $\frac{3}{8}$ " x 26 x 1 $\frac{1}{2}$ "	2	900108	4
"	" " $\frac{3}{8}$ " x 26 x 1 $\frac{1}{2}$ "	2	900133	3
K7C-K7T	" " $\frac{3}{8}$ " x 26 x 1 $\frac{1}{2}$ "	2	900171	4
K7-K12	" nut $\frac{3}{8}$ " x 26 t.p.i.	2	900000	2
K7C-K7T	Plain washer $\frac{3}{8}$ "	6	900009	1
K7-K12	REAR NUMBER PLATE	1	002342	10 0
K7C-K7T	" " "	1	002567	2 6
"	Bracket for number plate	1	002568	1 6
"	Fibre spacer	1	000429	6
K7-K12	Plastic moulded strip	1	003225	1 6
L1-L15	CHAINGUARD	1	003443	10 0
K7-K12	" " "	1	002120	12 6
K7C-K12	" " "	1	003527	19 6
L1	Chain cover — front	1	003722	1 0
"	Hex bolt $\frac{1}{2}$ " x 26 t.p.i.	1	900046	3
"	Plain washer $\frac{1}{2}$ " x 26 t.p.i.	1	900008	1
"	Chain cover — front	1	002769	1 6
"	Hex nut $\frac{3}{8}$ " x 26 t.p.i.	1	900016	2
"	Plain washer $\frac{3}{8}$ "	1	900022	1
L1-L15	Hex bolt $\frac{3}{8}$ " x 26 x 2"	2	900094	4
"	Spacer tube	2	003479	4
"	Plain washer $\frac{3}{8}$ " dia.	2	900009	1
K7-K12-K7C-K7T	Attachment bolt $\frac{1}{2}$ " x 26 t.p.i.	1	900178	4
K7-K12-K7C-K7T	Plain washer $\frac{1}{2}$ " dia.	1	900008	1
"	Shakeproof washer $\frac{1}{2}$ " dia.	1	900004	1
"	Hex nut $\frac{1}{2}$ " x 26 t.p.i.	1	900027	2

Sundries

Model	Description of Part	Qty.	Part No.	Price each £ s. d.
L1-L15	SEAT	1	003646	2 19 6
K7-K12-K7C	Twinseat	1	003854	3 17 6
K7T	Trials saddle	1	003647	3 12 0
—	Hex bolt $\frac{1}{2}$ " x 26 t.p.i.	—	900054	3
—	Hex nut $\frac{1}{2}$ " x 26 t.p.i.	—	900027	2
—	Plain washer $\frac{1}{2}$ "	—	900008	1
K7-K12-K7T	Rubber buffer	2	002128	6
K7T	Hex bolt $\frac{3}{8}$ " x 26 t.p.i.	2	900059	3
"	Plain washer $\frac{3}{8}$ "	4	900009	1
"	Hex nut $\frac{3}{8}$ " x 26 t.p.i.	2	900000	2
K7-K12	TOOL CASE	1	003648	17 6
K7C-K7T	" " (cylindrical)	1	003273	8 6
L1-L15	Tool compartment lid	1	003678	4 1
L1-L15-K7-K12	Thumbscrew — tool or battery case	—	000641	1 6
"	Tapped washer	—	900350	2
K7C-K12	Toolbox wing nut	1	900187	1 6
"	Wing bolt $\frac{1}{8}$ " Whitworth	1	900326	1 9
"	Plain washer $\frac{1}{8}$ "	1	900009	1
K7-K12	Panel — tool and battery cases	1	003668	5 9
"	Clip and screws for panel	1	003669	6
"	Plastic bead for panel	2	003745	9
K7-K12	BATTERY CASE	1	003654	17 6
"	Platform for battery	1	002371	1 6
"	Rubber pad	3	002368	6
All	TOOLKIT complete in wallet	1	—	1 1 0
"	Tool wallet	1	003455	3 0
"	Plug spanner — short box	1	000437	3 0
K12	" — long box	1	002539	3 0
All	Magneto spanner and feeler -012"	1	000438	7
"	Screwdriver	1	000551	1 0
"	Pliers	1	002537	4 0
"	Tyre lever	2	000544	1 6
"	Exhaust nut spanner	1	002503	3 0
L1-L15	Front wheel cone spanner	1	002536	1 0
All	D.E. spanner $\frac{3}{16}$ " x $\frac{1}{2}$ "	1	000546	2 6
"	" " $\frac{1}{2}$ " x $\frac{3}{8}$ "	1	000545	2 6
"	" " $\frac{1}{2}$ " x $\frac{1}{2}$ "	1	001996	3 0
"	" " $\frac{1}{2}$ " x $\frac{1}{2}$ "	1	000595	6 6
L1	EXHAUST PIPE	1	003911	1 10 0
L15	" "	1	003910	1 10 0
K7	" "	1	003823	1 12 6
K12	" "	1	003822	1 15 0
K7C-K7T	" "	1	003615	1 10 0
L1-L15	SILENCER — Alloy casting	1	003688	2 0 0
K7	" chromed tubular	1	003747	2 17 6
K12	" "	1	003746	2 17 6
K7C-K7T	" "	1	003820	2 10 0

Sundries

Model	Description of Part	Qty.	Part No.	Price each £ s. d.
K7C-K7T	SILENCER — chromed inner tube	1	003878	1 2 6
"	" " body	1	003821	1 8 6
"	" " self tapping screws	4	900155	1
L1-L15	Silencer cover plate	1	003690	10
"	Tail pipe L.H.	1	003447	6 0
"	" " R.H.	1	003448	6 0
"	Hex bolt $\frac{1}{4}$ " x 26 x 4 $\frac{1}{2}$ " long	1	900392	6
"	Plain washer $\frac{1}{2}$ "	1	900008	1
"	Shakeproof washer $\frac{1}{2}$ "	1	900004	1
"	Self locking nut $\frac{1}{4}$ " x 26 t.p.i.	1	900284	4
"	Cheese head screw $\frac{1}{8}$ " x 26 t.p.i.	4	900010	3
"	Shakeproof washer	4	900006	1
"	Hex bolt $\frac{3}{8}$ " x 26 x $\frac{3}{8}$ "	2	900393	4
K7-K12	Plain washer $\frac{3}{8}$ " dia.	2	900011	1
"	Hex bolt $\frac{1}{8}$ " x 26 x 1 $\frac{1}{2}$ "	1	900133	4
"	Plain washer $\frac{1}{8}$ "	1	900009	1
K7C-K7T	Hex bolt $\frac{1}{4}$ " x 26 t.p.i.	1	900024	3
"	" nut $\frac{1}{4}$ " x 26 t.p.i.	1	900027	2
"	Plain washer	1	900008	1
L1	REAR CHAIN 119 links $\frac{1}{8}$ " x 305" x 192"	1	003699	*
L15	" " 119 links $\frac{1}{8}$ " x 335" x 205"	1	003693	*
K7	" " 122 links $\frac{3}{8}$ " x $\frac{1}{4}$ " x 225"	1	003172	*
K12	" " 125 links $\frac{1}{8}$ " x 355" x 305"	1	002394	*
K7C	" " 125 links $\frac{3}{8}$ " x $\frac{1}{4}$ " x 225"	1	003691	*
K7T	" " 126 links $\frac{3}{8}$ " x $\frac{1}{4}$ " x 225"	1	003692	*
L1	Cranked double link	1	SD1442	*
L15	" "	1	003939	*
K7-K7C-K7T	" "	1	SD1447	*
K12	" "	1	790000	*
L1	Connecting link	1	SD1450	*
L15	" "	1	003940	*
K7-K7C-K7T-K12	" "	1	790001	*
L1	Spring clip	1	SD1448	*
L15	" "	1	003941	*
K7-K7C-K7T-K12	" "	1	790002	*
L15-K7-K12	SPEEDOMETER 80 m.p.h.	1	003642	*
"	" 140 k.p.h.	1	003643	*
K7C-K7T	" 65 m.p.h.	1	002532	*
"	" 120 k.p.h.	1	002533	*
"	" bracket	1	003223	*
L15-K7-K7C-K7T	" drive cable 4' 4" long	1	002348	*
K12	" drive cable 3' long	1	002349	*
L1-L15-K7C-K7T	HORN — bulb type	1	000605	*
K7-K12	" — electric, with bracket	1	003161	*
L1-L15-K7-K12	HANDLEBAR 26" x $\frac{7}{8}$ " dia.	1	003553	2 5 0
K7C-K7T	" 28" x $\frac{7}{8}$ " dia.	1	003221	15 0
All	Recessed washer $\frac{1}{2}$ " dia. (under top plate)	2	002923	1 6
"	Hex bolt $\frac{1}{2}$ " x 26 t.p.i.	2	900369	8

* Manufacturers current price.

Sundries

Model	Description of Part	Qty.	Part No.	Price each £ s. d.
K7C-K7T	Handlebar clips — upper and lower ..	2	003214	pr. 3 6
"	Hex bolt $\frac{3}{8}$ " x 26 x $1\frac{1}{2}$ " long ..	4	900361	5
"	Plain washer $\frac{3}{8}$ " ..	4	900009	1
L1-L15-K7-K12	CLUTCH LEVER, handle only ..	1	001311	7 6
K7C-K7T	" " ball ended with bracket	1	003695	13 6
L1-L15-K7-K12	BRAKE LEVER, handle only ..	1	001312	7 6
K7C-K7T	" " ball ended, with bracket..	1	003696	13 6
All	Clutch or brake lever pivot pin $\frac{1}{4}$ " x 26 t.p.i.	2	900135	2
"	Clutch or brake lever hex nut $\frac{1}{4}$ " x 26 t.p.i.	2	900023	1
K7C-K7T	COMPRESSION RELEASE LEVER complete	1	000274	3 6
All	TWISTGRIP complete ..	1	002644	12 6
"	Grip rotating sleeve ..	1	000282	3 0
"	Rubber grip ..	1	002642	1 2
"	Clip casting, cable abutment half ..	1	000283	3 6
"	" " cover half ..	1	000284	3 6
"	Cheese head screw, 1 B.A. ..	2	900087	1
"	Adjusting screw ..	1	900089	1
"	" " locknut ..	1	900086	1
"	Friction spring ..	1	000286	6
"	Slotted socket for cable ..	1	000285	3
"	L.H. handlebar rubber grip ..	1	002643	1 2
L1	Gearshift control lever ..	1	704191	12 6
L1-L15	CABLE complete, front brake control ..	1	003637	5 6
K7-K12	" " front brake control ..	1	003059	5 6
K7C-K7T	" " front brake control ..	1	003901	5 6
L1	" " clutch control ..	1	002523	5 6
L15-K7	" " clutch control ..	1	001585	5 6
K12	" " clutch control ..	1	002573	5 6
K7C-K7T	" " clutch control ..	1	002154	5 6
L1	" " carburettor control ..	1	702031	5 0
L15	" " carburettor control ..	1	702276	5 0
K7-K7C-K7T	" " carburettor control ..	1	702151	5 0
K12	" " carburettor control ..	1	702251	5 0
K7C-K7T	" " compression release ..	1	000276	3 6
L1	" " gear-shift ..	1	704192	8 0
L15-K7-K7C-K7T	" " speedometer drive ..	1	002348	*
K12	" " speedometer drive ..	1	002349	*
L1-L15	SPARKING PLUG Lodge H14 ..	1	000441	5 6
K7-K7C-K7T-K12	" " Lodge HH14 ..	1	000436	6 6
K7C-K7T	" " Lodge 3HN † ..	1	790003	6 6
L1-L15-K7-K12	" " cover and suppressor ..	1	001617	2 6
K7C-K7T	" " waterproof cover ..	1	001038	1 3
"	" " suppressor ..	1	002670	1 6

† Not standard

* Manufacturers' current price

GUARANTEE

NOTICE—We do not appoint agents for the sale on our behalf of our motor cycles or other goods, but we assign to motor cycle Dealers areas in which we supply to such Dealers exclusively for re-sale in such areas. No such Dealer is authorised to transact any business, give any warranty, make any representation or incur any liability on our behalf. Published retail prices are for delivery free of charge at Dealers' premises. All goods are offered for sale subject to the price ruling at the time of delivery. All prices and specifications are subject to alteration without notice.

We give the following guarantee with our motor cycles, motor cycle combinations and sidecars, including all accessories and component parts other than tyres, saddles, chains and lighting and electrical equipment, and other than accessories and component parts supplied to the order of the Purchaser and differing from those comprised in the standard specifications supplied with our motor cycles, motor cycle combinations and sidecars, but including accessories and parts supplied by way of exchange as hereinafter provided. This guarantee is given in place of any implied conditions or warranties or any liabilities whatsoever statutory or otherwise; no guarantee except that hereinafter contained and no conditions or warranty whatsoever statutory or otherwise is given or is to be implied, nor are we to be under any liability whatsoever except under the guarantee hereinafter contained. Any statement, description, condition or representation contained in any catalogue, advertisement, leaflet or other publication shall not be construed as enlarging, varying or over-riding anything herein contained. In the case of machines (a) which have been used for "hiring out" purposes or (b) any motor cycle and/or sidecar used for any dirt track, cinder track or grass track racing or competitions (or any competition of any kind within an enclosure for which a charge is made for admission to take part in or view the competition) or (c) machines from which the trade mark, name or manufacturing number has been altered or removed or (d) any machines in which parts have been used not supplied by or approved by the motor cycle manufacturer or (e) any machine from which the silencing system as fitted by the manufacturer has been partially or wholly removed or interfered with, no guarantee, condition or warranty of any kind statutory or otherwise, is given or is to be implied, nor are we to be under any liability whatsoever in respect of any such machine. We guarantee, subject to the conditions mentioned below, that all precautions which are usual and reasonable have been taken by us to secure excellence of materials and workmanship, but this guarantee is to extend and be in force for six months only in U.K. and ninety days overseas from date of purchase, or date of exchange in case of any accessory or part supplied by way of exchange as hereinafter provided, and damages for which we make ourselves responsible under this guarantee are limited to the free repair of or supply of a new part or accessory in exchange for the part of the motor cycle, motor cycle combination or sidecar or accessory which may have proved defective. We undertake, subject to the conditions mentioned below, to make good in manner aforesaid any part or accessory covered by this guarantee which has proved defective within the said period. We do not undertake to replace or refix or bear the cost of replacing or refixing any such new part or accessory in the motor cycle, motor cycle combination or sidecar. As motor cycles, motor cycle combinations and sidecars are easily liable to derangement by neglect or misuse, this guarantee does not apply to defects caused by wear and tear, misuse or neglect.

The term "misuse" shall include, amongst others, the following acts:

1. The attaching of a sidecar to a motor cycle in such a manner as to cause damage or calculated to render the latter unsafe when ridden.
2. The use of a motor cycle or of a motor cycle and sidecar combined, when carrying more persons or a greater weight than that for which the machine was designed by the manufacturers.
3. The attaching of a sidecar to a motor cycle by any form of attachment not provided, supplied or approved by the manufacturers, or to a motor cycle which is not designed for such use.

We do not guarantee tyres, saddles, chains or lighting and electrical equipment, or any accessories or component parts supplied to the order of the Purchaser differing from those comprised in the standard specifications supplied with our motor cycles, motor cycle combinations or sidecars. As regards all such tyres, saddles, chains, lighting and electrical equipment, accessories and component parts, no guarantee, condition or warranty of any kind statutory or otherwise is given or is to be implied, and we are to be under no liability whatsoever in respect thereof.

CONDITIONS OF GUARANTEE—If a defective part or accessory should be found in our motor cycles, motor cycle combinations or sidecars, or in any part or accessory supplied by way of exchange as before provided, it must be sent to us CARRIAGE PAID and accompanied by an intimation from the owner that he desires to have it repaired or exchanged free of charge under our guarantee, and he must also furnish us at the same time with the frame number of the machine, the date of purchase or the date when the alleged defective part or accessory was exchanged as the case may be.

Failing compliance with the above, such articles will lie here at THE RISK OF THE OWNER, and this guarantee and any implied guarantee, warranty or condition shall not be enforceable.

REPAIRS—Any motor cycle, motor cycle combination or sidecar sent to us to be plated, enamelled or repaired will be repaired upon the following conditions, i.e., we guarantee that all precautions which are usual and reasonable have been taken by us to secure excellence of materials and workmanship, such guarantee to extend and be in force for three months only from the time such work shall have been executed, and this guarantee is in lieu and in exclusion of all conditions and warranties statutory or otherwise, and all liabilities whatsoever and the damages recoverable are limited to the cost of any further work which may be necessary to amend and make good the work found to be defective.

It pays to fit genuine

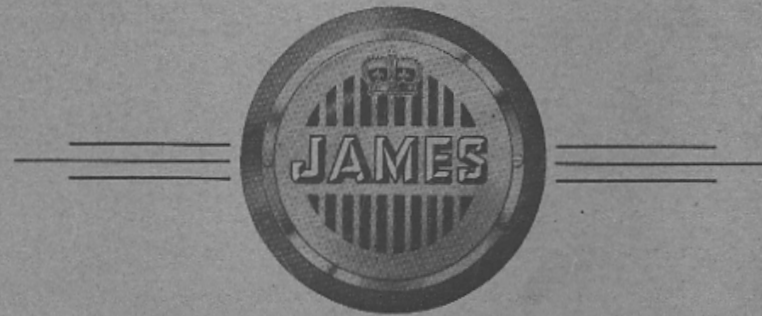

Spare Parts

James Publication No. S/56/5M
May, 1956

PRINTED IN ENGLAND