

PRICED EDITION

# **Francis-Barnett**

## **SPARES LIST**

for :—

**CRUISER 84**

**PLOVER 86**

**FALCON 87**

Manufacturers :

**FRANCIS & BARNETT LTD.**

LOWER FORD STREET

**COVENTRY**

**ENGLAND**

Telegrams: "Franbar, Coventry"

Telephone: 3054  
Service Dept. 20204

**1960**

Prices shown are subject to an increase of 10%



## SPARES PRICES

for

**CRUISER 84**

**PLOVER 86**

**FALCON 87**

### IMPORTANT

When ordering spare parts refer to page six and :—

A.—Quote frame number of machine stamped on left hand side of steering head.

B.—Quote colour of your machine.

Manufacturers :

**FRANCIS & BARNETT LTD.**

LOWER FORD STREET

**COVENTRY**

ENGLAND

Telegrams : " Franbar, Coventry "

Telephone : 3054

Service Dept. 20204

**PRICE - 4/-**

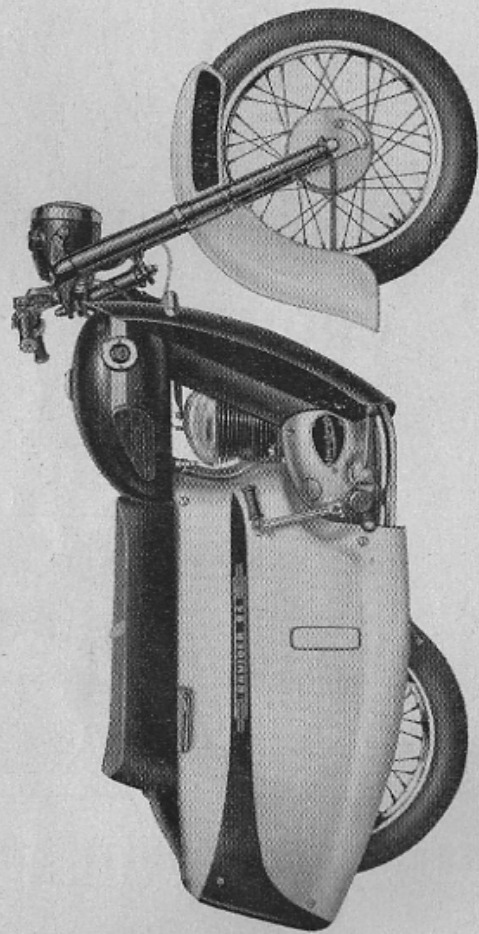

CRUISER 84

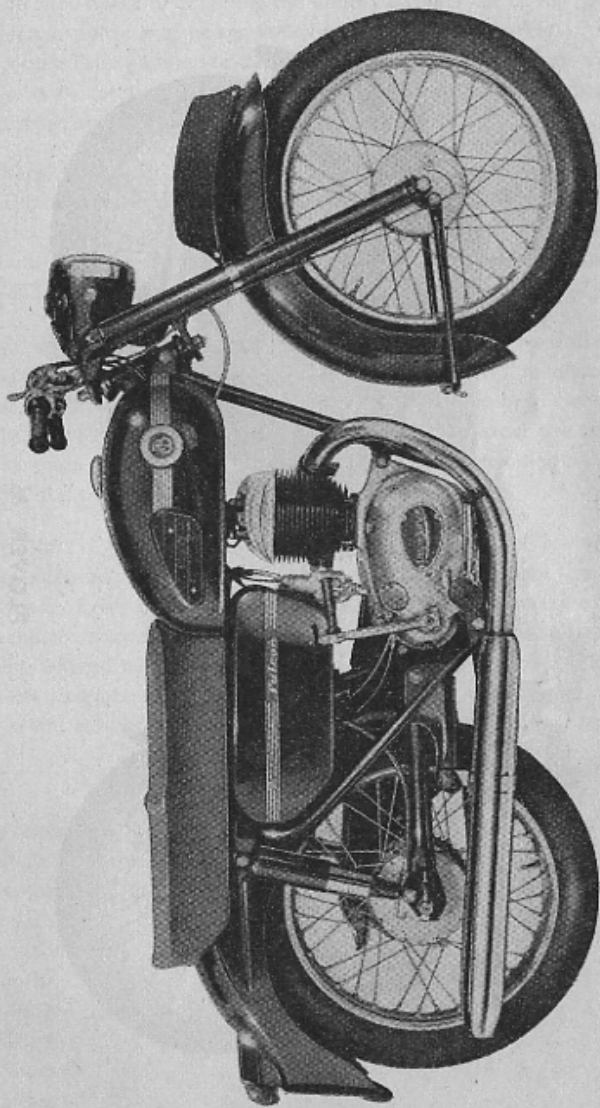

FALCON 87

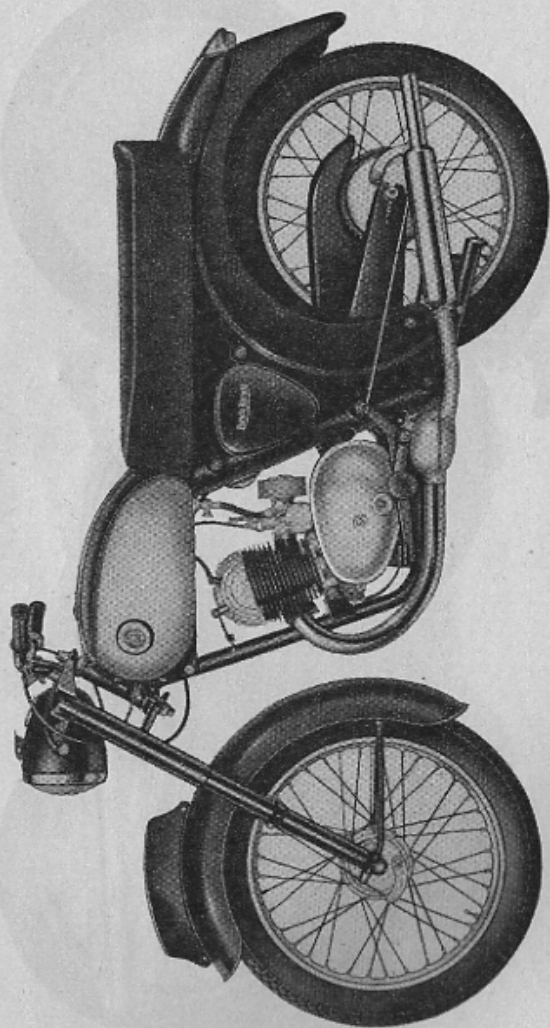

PLOVER 86

## REPAIR SERVICE

The importance of obtaining the utmost possible use of your machine with least expense is a matter which has received our careful attention, and a most efficient and up-to-date Service Department is at your disposal. All repairs are carried out by experts; your difficulties, should they arise, are attended to by specialists.

There is no economy in fitting cheap, imitation parts; we accept no responsibility whatever for breakage and consequential damage resulting from the use of parts other than those manufactured or supplied by ourselves. Always obtain your spares from the appointed FRANCIS-BARNETT dealer in your district, or from us.

**REPAIR SERVICE.**—It will be the wish of the owner to have all repairs and adjustments on his machine carried out efficiently to ensure the utmost reliability. Machines sent to us are repaired by experts who specialise in repair work. All repairs are carried out under the terms of the Guarantee set out at the end of this book—see concluding paragraph headed "Repairs."

**ROTARY EXCHANGE SCHEME.**—The importance of having your cylinder rebored accurately when the need arises, cannot be over-emphasized. Every cylinder sent here is re-ground to standard oversize limits, and no variation from this standard is permitted. A special exchange scheme is offered in connection with this, and also with the servicing of crankshaft assemblies, brake shoes and clutch sprockets and plates. Prices are as follows:—

	<b>Cruiser 84</b>	<b>Plover 86</b>	<b>Falcon 87</b>
	£ s. d.	£ s. d.	£ s. d.
Engine assembly complete ...	40 0 0	27 0 0	40 0 0
Crankshaft assembly ...	6 5 0	4 5 0	6 5 0
Cylinder rebore & O.S. piston	3 15 0	2 10 0	3 15 0
Clutch sprocket ...	7 6	7 6	7 6
Clutch plate ...	5 9	5 9	5 9
Front Fork ...	11 14 10	9 10 8	11 14 10
Petrol Tank ...	3 10 0	3 5 6	3 10 0
Brake Shoes 4" ... pair	—	7 3	—
Brake Shoes 5" ... "	—	8 6	8 6
Brake Shoes 6" ... "	10 6	—	—
Twin Seat ...	4 5 0	—	4 5 0
Flywheel Generator complete	—	6 6 3	—

## ESTIMATES

If required, we are always prepared to give an estimate before proceeding with any repair. This entails a certain amount of labour in dismantling to ascertain what new parts will be required, and therefore, in the event of any estimate not being accepted, a small charge is made for our mechanic's time in taking down the parts for inspection.

Estimates must be treated as approximate only. We reserve the right to fit additional parts where these are necessary, on further examination or test, to make the repairs satisfactory.

We do not undertake to fit to machines sent to us for overhaul, any parts specified by the customer, when we consider that other parts are necessary to make an efficient repair. In such cases, we are prepared to supply the requirements of the customer in spares, but we do not undertake to fit them.

## ORDERING SPARES

PROCEDURE.—We can supply **all spares**, except tyres and tubes. When ordering, please note carefully the following points :—

Always state **part number** and description as given in Spares List.

Always quote the **complete frame number** of your machine. This is stamped on the left-hand side of the steering head.

If engine parts are required, state the **engine number** in addition. This is stamped either on the crankcase halves at the front.

If possible, send the old parts as a pattern, and attach securely your name and address. Post full instructions under **separate cover**. Such **old parts will not be returned unless specifically requested** by the owner at the time of sending.

PLEASE PRINT NAME AND ADDRESS ON ALL CORRESPONDENCE WITH THE SERVICE DEPARTMENT.

REMITTANCE.—Repairs and spares are always treated on a cash basis. Unless otherwise instructed, spares will be sent by C.O.D. post, weight permitting, when the remittance does not accompany order.

If desired, a pro-forma invoice will be sent, showing the full cost of the order. Spares will then be forwarded on receipt of remittance.

All invoices will be surcharged by 5%, minimum 1/-, to cover packing and postage or carriage.

When making remittances by telegraph money order, the name and address of the sender *must* be included in the space provided on the Post Office requisition form for a private message from remitter to payee. Unless this is done, the Post Office does not give us this information.

Always quote our **invoice number** in correspondence which relates to past spares or repairs.

DEPOSIT ACCOUNT.—Where it is preferred, we will open a Deposit Account if an amount of not less than £2 is sent to us. The arrangement will ensure prompt service and dispense with the C.O.D. system. In such circumstances, "**Deposit Account**" should be mentioned each time spares are ordered.

All our machines are sold through appointed Dealers, each of whom keeps at least a minimum stock of the spares most likely to be needed. We therefore strongly urge owners in their own interests to obtain their spares requirements from local supplies; should a Dealer be out of stock, we will execute an urgent order from him per return, always provided stocks are available at the Factory. We are always pleased to put a Francis-Barnett owner into touch with his nearest F-B Dealer(s).

In the event of difficulty we shall be pleased to supply direct against cash with order or by C.O.D. post.

## SPARES LIST

Cuando se piden piezas de recambio basta mencionar el numero completo del motor y los numeros de las piezas de repuesta que se necesitan.

Naar reserveorde ordres er det tilstraek keligt at anfore det komplette nummer af motoren og nummeret af de onskede reserveorde.

Lors d'une commande de pieces detachees, il suffit de mentionner le numero complet du moteur et les numeros des pieces detachees requises.

Bij de bestelling van motoronderdelen behoort het nummer van de motor en het onderdeelnummer aan te geven.

Bei der Bestellung von Ersatzteilen genügt es Motornummer und Nummern der gewünschten Ersatzteil anzugeben.

Always quote the frame number and prefix of your machine when ordering spares. This is to be found stamped on the **left hand side of the steering head**. The engine number, for use when ordering engine spares, is situated on the **front crankcase lug**, immediately below the cylinder joint.

### SERVICE DEPARTMENT REPAIRS AND SPARES

Hours of business for callers :  
**MONDAY to FRIDAY ONLY**  
 8-30 a.m. to 12.30 p.m. ; 1 p.m. to 5 p.m.  
*Repairs by appointment only — please.*

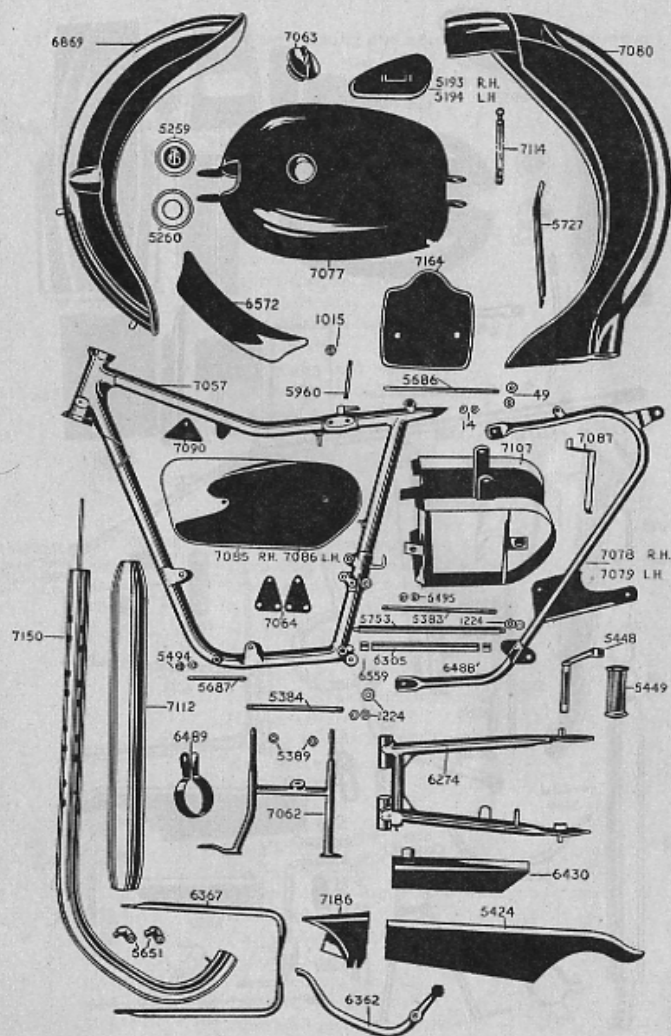

**FALCON 87**

(Always quote Frame Number when ordering spares)

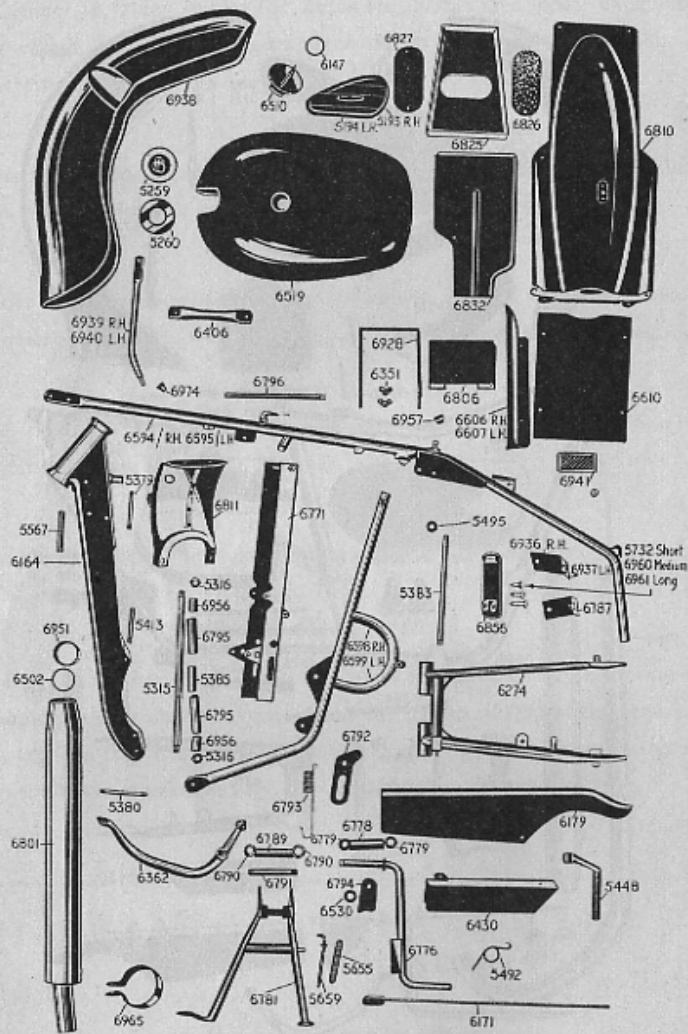

CRUISER 84

(Always quote Frame Number when ordering spares)

## SPARES PARTS PRICE LIST

(SUBJECT TO VARIATION)

5% should be added to cover packing and administration. Minimum 1/-.

### FRAME AND FOOTRESTS

Cruiser 84	Falcon 87	Description	Price each		
			£	s.	d.
6164	—	Frame Member ... ..	3	18	6
6594	—	Frame Tube Assy. R.H. ... ..	3	15	0
6595	—	Frame Tube Assy. L.H. ... ..	3	15	0
6598	—	Rear Stay Assy. R.H. ... ..	1	15	0
6599	—	Rear Stay Assy. L.H. ... ..	1	15	0
6771	—	Centre Channel Assy. ... ..	19	6	
6274	6274	Swing Fork Assy. ... ..	3	18	9
5373	5373	Pivot Bearing Silent Bloc E.20523 ... ..	6	4	
—	7057	Frame Front ... ..	8	10	0
—	7078	Rear Frame Loop Assy. R.H. ... ..	3	17	6
—	7079	Rear Frame Loop Assy. L.H. ... ..	3	17	6
5383	5383	Spring Arm Pivot Stud ... ..	4	3	
5495	5495	Nut for same ... ..	9		
—	5960	Front Stud for Top Back Stays ... ..	9		
—	1015	Nut for same ... ..	3		
—	5686	Rear Stud for Top Back stays ... ..	3	6	
—	14	Nut for same ... ..	4		
49	49	Distance Tube end cap ... ..	8		
—	5687	Front Stud for bottom rear stays ... ..	1	9	
—	5494	Nut for same ... ..	9		
5567	—	Frame stud for head lug front ... ..	1	4	
14	—	Nut for same ... ..	4		
5379	—	Frame stud for head lug rear ... ..	1	1	
14	—	Nut for same ... ..	4		
5380	—	Stud for bottom front frame member ... ..	1	4	
14	—	Nut for same ... ..	4		
6796	—	Stud for top of Centre Channel ... ..	4	0	
14	—	Nut for same ... ..	4		
5413	1492	Engine Stud ... ..	1	1	
—	14	Nut for same ... ..	4		
—	7064	Engine Plate ... ..	1	3	
6406	7090	Engine Steady ... ..	3	2	
06/16	15/10	Engine Steady Bolt ... ..	9		
5388	—	Spacer Tube — Btm. Frame Front ... ..	1	3	
6170	6170	Chain Adjuster ... ..	1	6	
6176	6176	Chain Adjuster Nut ... ..	2		
5315	5753	Footrest Stud ... ..	7	10	
1224	1224	Footrest Stud Nut ... ..	4		
—	6305	Footrest Tube — Inner ... ..	2	3	
—	6488	Footrest Tube — Outer R.H....	9		
—	6559	Footrest Tube — Outer L.H. ... ..	9		
5385	—	Centre Tube for Footrest ... ..	1	1	
6795	—	Intermediate Tube for Footrest (2) ... ..	9		
6956	—	Outer Tube for Footrest (2) ... ..	9		

(Always quote Frame Number when ordering spares)

FRAME AND FOOTRESTS—Continued

Cruiser 84	Falcon 87	Description	Price each
			£ s. d.
5448	5448	Footrest Hanger ... ..	7 10
5449	5449	Footrest Rubber ... ..	1 11
6868	—	Lifting Handle ... ..	9 6
6880	—	Lifting Handle Cover Assembly R.H. ... ..	2 6
6881	—	Lifting Handle Cover Assembly L.H. ... ..	2 6
6855	—	Pillion Rest Assembly (complete) ... ..	13 0
6856	—	Pillion Rest Cover ... ..	2 0
6858	—	Pillion Rest Pivot Bracket ... ..	4
6859	—	Pillion Rest attachment bracket ... ..	4
6860	—	Pillion Rest Pivot Block ... ..	4 0
6861	—	Pillion Rest only ... ..	5 6
6863	—	Pillion Rest Pivot Shaft ... ..	3
6862	—	Pillion Rest Spring & Ball ... ..	2
6925	—	Pillion Rest Retaining Ring ... ..	3
6376	—	Pillion Rest Rubber ... ..	1 0
14/8	—	Pillion Rest Bolt ... ..	4
5379	—	Rectifier Mounting Stud ... ..	1 1
5334	—	Rectifier Mounting Stud Spacer ... ..	9

CENTRE AND FRONT STANDS

Cruiser 84	Falcon 87	Description	Price each
			£ s. d.
6781	—	Centre Stand ... ..	1 17 6
—	7062	Centre Stand ... ..	1 11 6
6776	—	Operating Lever Assy. ... ..	12 0
6976	—	Sleeve for Op. Lever ... ..	6
6778	—	Spacer Tube — (pedal ass.) ... ..	1 3
6779	—	Side Spacers for same ... ..	4
6780	—	Spacer Tube — spring plate ... ..	4
6789	—	Spacer (stand hinge) ... ..	1 6
6790	—	Cam Roller for same ... ..	1 0
6791	—	Stud (stand hinge) ... ..	1 3
6792	—	Spring Plate ... ..	2 3
5655	—	Stand Operating Spring (bottom) ... ..	1 0
5659	—	Guide Rod Assy. ... ..	1 6
6793	—	Stand Retaining Spring (top) ... ..	2 3
6794	—	Cam Plate ... ..	1 0
6530	—	Washer for same ... ..	6
—	5655	Centre Stand Spring ... ..	1 0
—	5659	Spring Guide Rod Assy. ... ..	1 6
—	5389	Centre Stand Pivot Sleeve ... ..	6
—	5384	Centre Stand Pivot Stud ... ..	4 0
—	1224	Centre Stand Pivot Nut ... ..	4
—	907	Centre Stand Pivot Nut Washer ... ..	2
—	6367	Front Stand ... ..	7 10
—	5651	Front Stand Lug ... ..	5 3
—	6178	Front Stand Wing Nut ... ..	2 3
—	5724	Wheel Spindle Clamp Bush ... ..	1 4

(Always quote Frame Number when ordering spares)

6875 Damper compressing tool for chain adjustment 5/-

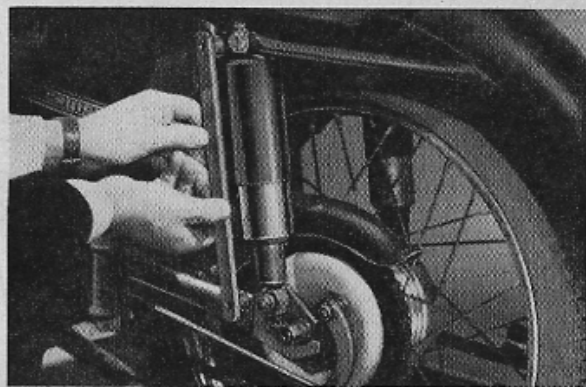
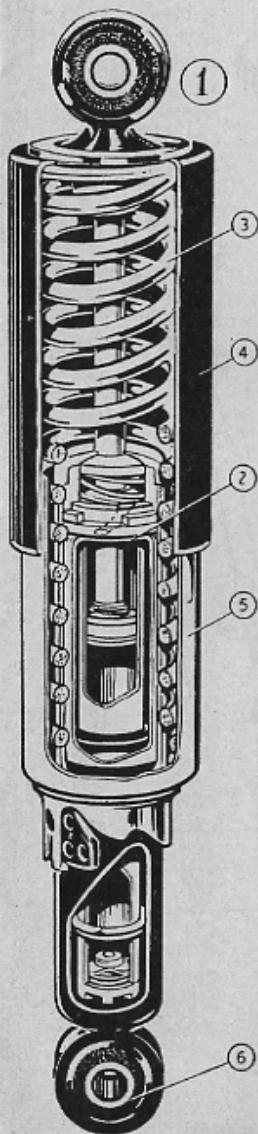

REAR SUSPENSION		Price each	
		£	s. d.
III. No.	Description	£	s. d.
1	Damper Unit complete	3	0 0
2	Damper Unit only	1	16 6
3	Suspension Spring 90 lbs./in.	7	6 6
1	Suspension Spring 96 lbs./in.	7	6 6
1	Suspension Spring 110 lbs./in.	7	6 6
1	Suspension Spring 145 lbs./in.	8	0 0
4	Upper Dirt Shield	5	9 9
5	Lower Dirt Shield (Chrome)	8	6 6
6	Ferrule Tube with Bonded Bush	2	3 3
1	Spring Retaining Collets (2) (pair)	1	2 9
1	Suspension unit top fixing bolt	6	6 6
1	Suspension unit top fixing bolt flange nut	1	5 4
1	Suspension unit bottom fixing bolt	1	5 4
1	Suspension unit bottom fixing bolt nut	1	5 4

The bottom chrome dirt shield is omitted on Cruiser 84.

(Always quote Frame Number when ordering spares)



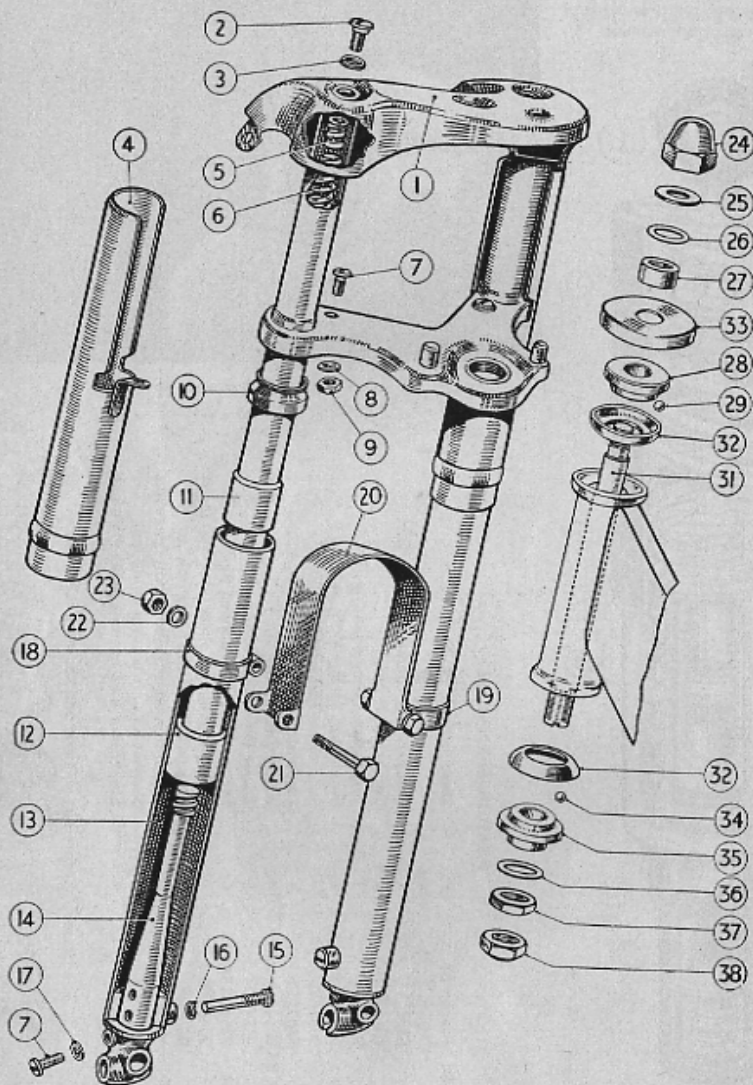

FRONT FORKS (CRUISER AND FALCON)

(Always quote Frame Number when ordering spares)

Cruiser 84 Falcon 87		III.	FORK	Price each
		No.	Description	£ s. d.
005817	005817	-	Fork Assembly Complete	19 8 6
5728	5728	-	Rubber Moulding for Fork	2 2
003953	003953	1	Fork H Assembly	5 10 3
900364	900364	2	Oil Filler Plug	1 0
900144	900144	3	Fibre Washer	3
002938	002938	4	Top Cover Sleeve	13 0
003185	003185	5	Top Spring Adaptor	5 10
002948	002948	6	Main Spring	14 9
900315	900315	7	Screw $\frac{1}{4}$ " x 26 TP1 Cover Fixing or Drain Plug	4
900004	900004	8	Shake proof Washer	1
900027	900027	9	Hex. Nut $\frac{1}{2}$ " x 26 TP1	3
003018	003018	10	Oil Seal	3 3
002907	002907	11	Slider Bush Upper	6 2
002906	002906	12	Slider Bush Lower	6 2
005747	005747	13	Fork Slider Tube	2 5 6
004781	004781	14	Damper Post	9 9
002917	002917	15	Damper Post Retaining Screw	7
900358	900358	16	Fibre Washer — Post Screw	2
900102	900102	17	Fibre Washer — Drain Plug	3
003199	003199	18	R.H. Mudguard Clip & Stop	4 7
003020	003020	19	L.H. Mudguard Clip	3 3
6927	—	20	Bridge Piece	6 0
—	004703	20	Bridge Piece	5 2
900094	900094	21	$\frac{3}{16}$ " Bolt Domed Head	11
900009	900009	22	$\frac{3}{16}$ " Plain Washer	2
900354	900354	23	$\frac{3}{16}$ " Hexagon Nut Domed	4
004348	004348	24	Steering Stem Cap Nut	4 8
900383	900383	25	Steering Stem Top Washer	5
900389	900389	26	Shim	3
003665	003665	27	Spacer for same	11
5974	5974	28	Top Cone	3 9
003894	003894	31	Steering Stem	12 4
5931	5931	32	Head Cup	2 8
5912	5912	33	Dust Cover	2 9
909	909	34	$\frac{1}{4}$ " Ball	set 2 8
5911	5911	35	Bottom Cone	3 9
900197	900197	36	Steering Stem Washer Bottom	4
900353	900353	37	Steering Stem Adjuster Nut	1 0
900352	900352	38	Locknut $\frac{3}{4}$ " x 26 TP1	1 0
003282	003282	—	Green & Chrome Extension Piece (additional to cover sleeve 002938)	4 9

(Always quote Frame Number when ordering spares)

### HANDLE BARS & CONTROLS

Cruiser 84	Falcon 87	Description	Price each
			£ s. d.
004722	004722	Handlebar Bend ... ..	2 9 6
900369	900369	Handlebar Fixing Bolt ... ..	1 0
002923	002923	Handlebar Spherical Washer ... ..	1 1
003957	003957	Handlebar Clutch and Brake Lever ... ..	7 3
003958	003958	Handlebar Lever Spacer ... ..	4
900419	900419	Pivot Pin ... ..	2
900403	900403	Pivot Pin Nut ... ..	4
4764	4764	Twist Grip complete ... ..	9 6
4765	4765	Twist Grip & Dummy Grip Rubber ... ..	1 3
6966	7094	Clutch Cable ... ..	3 6
6955	5707	Front Brake Cable ... ..	3 6
6289	7095	Throttle Control Cable ... ..	2 6
6290	7096	Air Control Cable ... ..	2 6
6291	6291	Air Control Lever ... ..	8 0
6568	6568	Horn Push and Dipper Switch ... ..	8 6

### PETROL TANK

Cruiser 84	Falcon 87	Description	Price each
			£ s. d.
6519/84	7077	Petrol Tank ... ..	7 10 0
7063	7063	Petrol Tank Filler Cap ... ..	10 0
6147	6147	Petrol Tank Filler Cap Seal ... ..	11
6393	6569	Petrol Tap ... ..	10 0
4365	4365	Petrol Tap Washer ... ..	2
BSS.249	BSS.249	Petrol Tap Banjo Bolt ... ..	1 0
BSS.1	BSS.1	Petrol Tap Banjo Bolt Washer ... ..	1
5259	5259	Monogram Badge ... ..	8 11
5260	5260	Monogram Badge Rubber ... ..	1 4
5265	5265	Monogram Badge Screw ... ..	3
5263	5263	Monogram Badge Screw Spire Nut ... ..	3
5193	5193	Knee Grip R.H. ... ..	4 9
5194	5194	Knee Grip L.H. ... ..	4 9
7144	7144	Knee Grip Fixing Screw ... ..	3
6370	—	Rear Tank Mounting Bolt ... ..	1 0
1015	—	Rear Tank Mounting Bolt Nut ... ..	3
6276	—	Tank Mounting Sleeve ... ..	1 4
—	3534	Petrol Tank Rear Fixing Stud ... ..	1 4
6804	7114	Petrol Pipe complete ... ..	5 9
—	6953 (376/138)	Banjo only for carburettor ... ..	2 3
—	6388	Tank line transfers ... ..	6

### EXHAUST SYSTEM

Cruiser 84	Falcon 87	Description	Price each
			£ s. d.
6797	7150	Exhaust Pipe Assy. ... ..	2 17 6
6801	—	Silencer Assy. ... ..	1 15 0
—	7112	Silencer Assy. ... ..	3 10 0
6502	6502	Silencer Seal ... ..	1 3
6965	—	Silencer Circlip ... ..	2 6
—	6489	Silencer Circlip ... ..	5 9
6951	6951	Silencer Abutment ... ..	6

(Always quote Frame Number when ordering spares)

### TRANSMISSION

Cruiser 84	Falcon 87	Description	Price each
			£ s. d.
6298	—	Rear Chain 123 P ... ..	2 12 1
2451	2451	Single Conn. Link ... ..	9
2453	2453	Cranked Link ... ..	1 4
1841	1841	Spring Clip ... ..	2
—	7121	Rear Chain 121 P. ... ..	2 11 3
110038/60P	—	Front Chain ... ..	12 8
—	110038/58P	Front Chain ... ..	12 3
1039	1039	Chain Rivet Extractor ... ..	1 0 6
—	6875	Rear chain adjuster jig — see illustration on page 13	5 0

### FRONT HUB COMPLETE

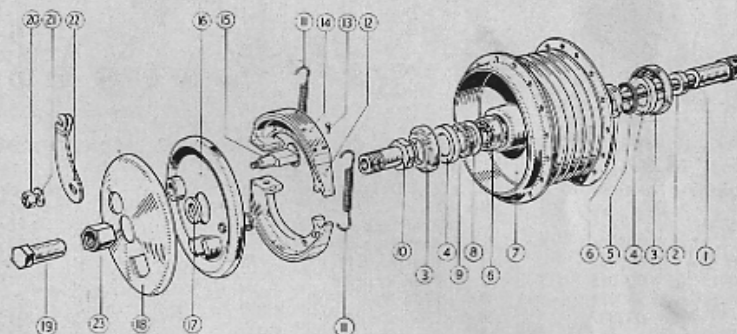

Cruiser 84	Falcon 87	Ill. No.	Description	Price each
				£ s. d.
006000	—	—	Front Hub complete 6" ... ..	9 3 9
—	006001	—	Front Hub complete 5" ... ..	7 5 0
005999	005999	1	Knock-out Spindle ... ..	12 9
005814	005814	2	Outside Spacer ... ..	1 8
001850	001850	3	Enclosure Cap ... ..	5
000942	000942	4	Enclosure Cap ... ..	8
005805	005805	5	Rubber Seal ... ..	8
001333	001333	6	Journal Bearing ... ..	14 0
004894	004894	—	Hollow Spindle ... ..	3 10
004863	004863	—	Location Pressing for same ... ..	9
—	003788	7	Hub Shell ... ..	3 11 6
003787	—	7	Hub Shell ... ..	4 17 6
000940	000940	8	Enclosure Steel Washer ... ..	4
000941	000941	9	Felt Seal ... ..	4
006082	006082	10	Brake Plate Hex. Spacer Sleeve ... ..	—
001819	—	11	Brake Shoe Spring ... .. pair	1 4
—	000320	11	Brake Shoe Spring ... .. pair	1 4
005370	—	12	Brake Shoe & Slipper ... .. pair	19 6
—	005368	12	Brake Shoe & Slipper ... .. pair	16 3
005234	005234	—	Slipper only for Brake Shoe ... ..	7
001822	—	14	Brake Shoe Liner & Rivets ... .. pair	7 3
—	000314	14	Brake Shoe Liner & Rivets ... .. pair	4 6
002051	001088	15	Brake Cam complete ... ..	5 3
006088	—	16	Brake Plate ... ..	19 9
—	006089	16	Brake Plate ... ..	16 3
005759	005759	17	Spacer 3/8" thick ... ..	—

(Always quote Frame Number when ordering spares)

Cruiser 84	Falcon 87	FRONT HUB COMPLETE—Continued			
005524	—	18	Domed Back Plate Cover	...	4 6
—	005787	18	Domed Back Plate Cover	...	4 0
900495	900495	19	Axle Nut	...	3 3
900000	900000	20	Cam Bolt Nut	...	4
900166	900166	21	Washer for same	...	3
002924	002924	22	Brake Cam Lever	...	3 4
005754	005754	23	Spacer Nut $\frac{1}{2}$ " thick	...	1 10

### REAR HUB

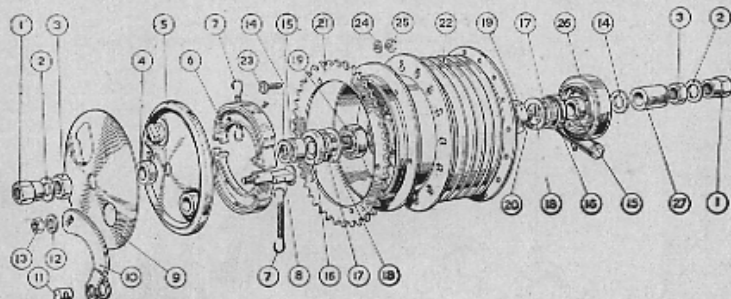

Cruiser 84	Falcon 87	Ill. No.	Description	Price each
				£ s. d.
005527	—	—	Rear Hub complete	10 10 0
—	005806	—	Rear Hub complete	7 12 6
900047	900047	1	Rear Axle Nut	3 3
900015	900015	2	Plain Washer	2
900051	900051	3	Plain Nut	4
001337	001337	4	Distance Piece	1 0
003809	—	5	Brake Back Plate	1 4 1
—	003818	5	Brake Back Plate	19 6
005370	—	6	Brake shoe including slippers	pair 19 6
—	005368	6	Brake shoe including slippers	pair 16 3
005234	005234	—	Brake shoe slipper only	7
—	000314	—	Brake liners and Rivets	pair 4 6
001822	—	—	Brake liners and Rivets	pair 7 3
001819	—	7	Brake shoe springs	pair 1 4
—	000320	7	Brake shoe springs	pair 1 4
001808	—	8	Brake Cam	5 3
—	001415	8	Brake Cam	5 3
—	004609	9	Domed Cover Plate	4 0
001816	001816	10	Cam Lever	3 11
002382	002382	11	Cam Lever Roller	1 4
900166	900166	12	Cam Bolt Washer	2
900000	900000	13	Cam Bolt Nut	4
900015	900015	14	Distance Piece Washer (2)	3
001336	001335	15	Distance Piece	1 0
003006	003006	16	Enclosure Cup	8
003007	003007	17	Felt Seal	8
003005	003005	18	Plain Enclosure Washer	4
003008	003008	19	Bearing	17 3
002961	002961	20	Axle	13 0
004852	—	21	Rear Sprocket	1 6 0
—	005889	21	Rear Sprocket	1 6 0
004878	—	22	Rear Hub Shell	5 15 0
—	003814	22	Rear Hub Shell	3 5 0
900367	900367	23	Rear Sprocket Bolt	3
900004	900004	24	Rear Sprocket Bolt Washer	2
900027	900027	25	Rear Sprocket Bolt Nut	3
52283/61/1	52283/61/1	26	Speedometer gearbox	1 17 6
001805	001805	27	Spacer	1 0

(Always quote Frame Number when ordering spares)

### WHEELS

Cruiser 84	Falcon 87	Description	Price each
			£ s. d.
7190	—	Front Wheel complete	11 2 6
—	7189/1	Front Wheel complete	10 0 0
6969	—	Rear Wheel complete	12 15 0
—	5978/1	Rear Wheel complete	10 10 0
5981	5981	Front & Rear Wheel Rim WM2 x 18	1 19 3
5983	—	Front wheel spokes 10 x 6 $\frac{1}{2}$ "	set 8 0
—	5985/6	Front wheel spokes 6 $\frac{1}{2}$ " — 6 $\frac{1}{2}$ " 10G.	set 8 0
5640	5640	Front wheel spokes Nipples	set 8 0
5984	5984	Rear wheel spokes 10 x 6 $\frac{3}{16}$ "	set 8 0
5640	5640	Rear wheel spokes Nipples	set 8 0

### BRAKE PEDALS

Cruiser 84	Falcon 87	Description	Price each
			£ s. d.
6362	6362	Brake Pedal	12 8
5415	5415	Brake Pedal Circlip	5
6171	6171	Brake Rod Assy.	6 10
6469	6469	Brake Pedal Yoke End Pin	9
6173	6173	Brake Pedal Adjuster Nut	2 2
5492	5492	Brake Return Spring	1 3

### MUDGUARDS, CHAINGUARDS, SIDE PANELS, TOOLBOX, LEGSHIELDS AND SAFETY BAR

Cruiser 84	Falcon 87	Description	Price each
			£ s. d.
6938	—	Front Mudguard	3 10 0
6989	—	Front Mudguard Side Transfer	1 0
—	6869	Front Mudguard	2 2 0
—	004703	Front Mudguard Bridge	5 2
6927	—	Front Mudguard Bridge	6 0
6986	6986	Front Mudguard Bridge Screw Phillips type	3
127	127	Front Mudguard Bridge Nut for above	3
6939	—	Front Mudguard Stay R.H.	9 6
6940	—	Front Mudguard Stay L.H.	9 6
900442	—	Front Mudguard Domed Nut	1 6
900011	—	Front Mudguard Washer	2
—	6572	Front Number plate	3 3
—	6394	Front Number Plate Fillet	1 0
6810	—	Rear Mudguard	3 10 0
—	7080	Rear Mudguard	2 10 0
—	5727	Rear Mudguard Stay Assy.	5 3
—	7169	Rear Mudguard Stay Assy. Stud	3
—	7164	Rear Number Plate	5 5
—	7144	Rear Number Plate Screws 2BA. x $\frac{3}{8}$ " 1g. Chrome	2
6941	—	Rear Reflector	3 6
—	7165	Rear Reflector	2 5
6959	—	Rear Reflector Self Tapping Screws	3
6610	—	Rear Number Plate	5 5
5902	—	Rear Number Plate Screws	3
6606	—	Tail Section R.H.	4 3
6607	—	Tail Section L.H.	4 3
6608	—	Tail Section Screws	1 3
6832	—	Rear Guard Channel	12 6
6811	—	Front cover (Side Panel Location)	14 3
6977	—	Front Cover Moulding	2 0
6979	—	Front Cover Fixing Screw	6
127	—	" " " "	3
6813	—	Side Panel R.H.	4 12 6
6816	—	Side Panel L.H.	4 12 6
6854	—	Side Panel Moulding	4 6

(Always quote Frame Number when ordering spares)

**MUDGUARDS, CHAINGUARDS, SIDE PANELS, TOOLBOX, LEGSHIELDS  
AND SAFETY BAR—Continued**

Cruiser 84	Falcon 87	Description	Price each
6837	—	Strip Assy. (Front Location of Side Panels) ...	2 0
6936	—	Rear Attachment Brkt. Assy. Top R.H. ...	1 6
6937	—	Rear Attachment Brkt. Assy. Top L.H. ...	1 6
6787	—	Rear Attachment Brkt. Assy. Lower... ..	2 3
6179	—	Chainguard Top ... ..	15 3
—	5424	Chainguard Top ... ..	15 3
6430	6430	Chainguard Assy. — Bottom ... ..	5 3
—	7106	Chainguard Front ... ..	5 3
—	7091	Distance Piece — Front Chainguard ... ..	9
—	6180	Bolt for same ... ..	1 8
—	7092	Distance Piece — Inner ... ..	6
6825	—	Toolbox Tray ... ..	8 0
—	7107	Toolbox Body ... ..	3 5 0
—	7085	Toolbox Lid R.H. ... ..	1 0 0
—	7086	Toolbox Lid L.H. ... ..	1 0 0
—	5732	Toolbox Oddie Fastener Stud (Short) ... ..	1 4
—	6960	Toolbox Oddie Fastener Stud (Long) ... ..	1 6
—	5733	Toolbox Oddie Fastener Rubber ... ..	5
—	5752	Toolbox Catch Washer ... ..	2
—	5726	Toolbox Moulding 7" 1g. ... ..	1 1
—	7142	Toolbox Transfer R.H.... ..	1 0
—	7143	Toolbox Transfer L.H. ... ..	1 0
6826	—	Seal — battery inspection hole ... ..	1 6
6827	—	Battery cover ... ..	1 3
6954	—	"Francis Barnett" Transfer ... ..	6
6945	—	"Cruiser 84" Cover Transfer ... ..	6
6982	—	Oddie fastener Retainer ... ..	3
6958	—	Oddie fastener Retainer ... ..	3
5732	—	Oddie Fastener Stud (No. 204) Small ... ..	1 4
6960	—	Oddie Fastener Stud (No. 824) Medium ... ..	1 6
6961	—	Oddie Fastener Stud (No.S.125) Long ... ..	1 6
5733	—	Oddie Fastener Rubber ... ..	5
5752	—	Plastic Catch Washer ... ..	2
6942	—	Safety Bar ... ..	1 15 0
6943	—	R.H. Legshield ... ..	1 11 6
6944	—	L.H. Legshield ... ..	1 11 6
6410	—	Bottom Legshield Bracket ... ..	2 6
5546	—	Legshield Rubber Moulding ... ..	1 3



**OPTIONAL EXTRAS  
LEGSHIELDS**

Falcon 87	Description	Price each
		£ s. d.
6627/BF	Legshield complete (for use without fairing)...	3 5 0
6627	Legshield R.H. ... ..	1 11 6
6628	Legshield L.H. ... ..	1 11 6
5566	Legshield Brkt. — Upper ... ..	2 6
6410	Legshield Brkt. — Lower ... ..	2 6
5546R	Legshield Moulding 8 $\frac{3}{8}$ " long ... ..	1 3
5546L	Legshield Moulding 13 $\frac{3}{8}$ " long ... ..	2 0
5567	Legshield Stud ... ..	1 4
5599	Legshield Half clip (Top bracket) ... each	2 0
3534	Bolt $\frac{1}{2}$ " B.S.F. ... ..	1 4
15/24	Bolt $\frac{1}{4}$ " B.S.F. ... ..	8
1015	Nut $\frac{1}{4}$ " B.S.F. ... ..	3
14/8	Bolt $\frac{1}{2}$ " B.S.F. ... ..	4
904	Washer $\frac{1}{2}$ " Plain ... ..	2
901	Internal Fan Disc Washer ... ..	2
127	Nut $\frac{1}{2}$ " B.S.F. ... ..	2

(Always quote Frame Number when ordering spares)

**LEGSHIELDS WITH AVON FAIRING**

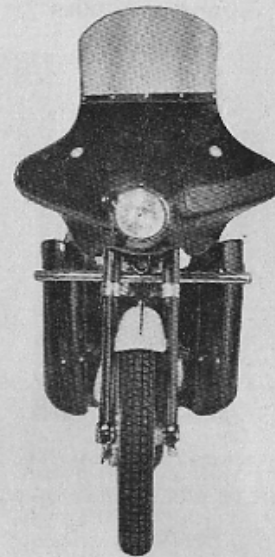

**Cruiser 84. Falcon 87**

Cruiser 84	Falcon 87	Description	Price each
6843/4/84	6932/3F	Legshields complete ... .. pair	3 5 0
6843	6932	R.H. Legshield ... ..	1 11 6
6844	6933	L.H. Legshield ... ..	1 11 6
6845	—	Top legshield bracket ... ..	5 0
—	5566	Top Legshield bracket (2) ... ..	2 6
6410	6410	Bottom Legshield bracket (2) ... ..	2 6
—	5599	Alum. Half Clips (2) ... ..	2 0
5546R	5546R	Moulding R.H. 8" ... ..	1 3
5546L	5546L	Moulding L.H. 13" ... ..	2 0
5567	5567	Frame Stud ... ..	1 4
14/10	14/10	Legshield Blade Fixing Bolt ... ..	4
6175	6175	Legshield Blade Fixing Bolt Nut ... ..	3
904	904	Plain Washer ... ..	1
901	901	Spring Washer ... ..	2

**Description**

**Price each**

£ s. d.

**PROP STANDS**

Cruiser 84	Falcon 87	Description	Price each
6991C	6739	Prop Stand complete ... ..	1 11 6
6002	6002	Prop. Stand Lug ... ..	12 6
6991	5586	Prop Stand Leg ... ..	1 6 6
4453	4453	Stand Spring ... ..	1 0
06/20	06/20	Prop Stand Leg Bolt ... ..	1 0
14	14	Nut for same. ... ..	4

(Always quote Frame Number when ordering spares)

**OPTIONAL EXTRAS—Continued**

**LUGGAGE CARRIER**

Cruiser 84	Falcon 87	Description	Price each £ s. d.
7031	7184	Luggage carrier ... .. Can be fitted with or without pannier equipment.	1 13 0
—	5509	Luggage carrier (refer illustration page 23) ... Can be fitted only with pannier equipment.	1 13 0



Illustrating Falcon Carrier 7184

**SAFETY BAR (illustrated page 21)**

Falcon 87	Description	Price each £ s. d.
7183	Safety Bar Assy. ... ..	2 2 0
7155M	Safety Bar Assy. Half Clamp ... ..	3 6
5567	Safety Bar Stud $\frac{3}{8}$ " ... ..	1 4
14	Safety Bar Stud Nut $\frac{3}{8}$ " ... ..	4
15/24	Bolt $\frac{1}{4}$ " ... ..	8
1015	Nut $\frac{5}{16}$ " ... ..	3

**PANNIER EQUIPMENT (illustrated page 23)**

Cruiser 84	Falcon 87	Description	Price each £ s. d.
7173/4	—	Fibre Glass Pannier Equipment complete ... ..	12 10 0
—	5569	Pannier set complete ... ..	*5 10 0
—	5507	Pannier Carrier R.H. ... ..	1 10 0
—	5508	Pannier Carrier L.H. ... ..	1 10 0
—	6244	Pannier Bag ... ..	* 18 9
—	6245	Pannier Hanger ... ..	15 8
—	6178	Pannier Wing Nut ... ..	2 3
—	1296	Screws $\frac{1}{2}$ " Long Hex. Head ... ..	6
—	3979	Washer ... ..	2
—	1199	Nut ... ..	4
—	14/14	Set Screw $\frac{1}{4}$ " B.S.F. x $\frac{7}{16}$ " long hex. head ... ..	6
—	904	$\frac{1}{2}$ " Plain Washer ... ..	2
—	901	Internal Fan Disc Washer ... ..	2
—	6175	$\frac{1}{2}$ " B.S.F. Nut ... ..	3

\*Purchase Tax Extra.

(Always quote Frame Number when ordering spares)

**Cruiser 84 Falcon 87 OPTIONAL EXTRAS—Continued**

005970	005970	Steering Lock ... ..	5 6
--------	--------	----------------------	-----



**AVON FAIRING (illustrated page 21)**

Cruiser 84	Falcon 87	Description	Price each £ s. d.
6415	6415	Avon fairing (GREEN) (includes Francis-Barnett exclusive bulkhead ... ..	8 15 0
W6415	W6415	Ditto in Dover White ... ..	8 15 0
6119	6119	Handlebar windscreen ... ..	4 1 6
6500	6500	Sundries bag (attached to windscreen 6119)... ..	*17 3

\*Plus Purchase Tax.

For Francis-Barnett enthusiasts a Terylene neck tie green with narrow stripe and FB monograms is available at ... .. 12 6

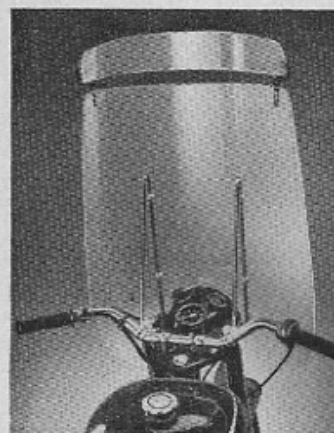

The carrier illustrated is 7031

(Always quote Frame Number when ordering spares)

**SUNDRIES**

Cruiser 84	Falcon 87	Description	Price each £ s. d.
6220	6220	Speedometer head ... ..	2 0 0
6221	—	Speedometer Drive 57" long ... ..	1 2 6
6221 inner	—	Speedometer Drive Inner ... ..	11 3
—	5738	Speedometer Drive 56" long ... ..	1 2 6
—	5738 inner	Speedometer Drive Inner ... ..	11 3
6117	6117	Speedometer Gearbox... ..	1 17 6
5739	5739	Speedometer Fixing Bracket with Bulb Holder ... ..	5 0
5740	5740	Speedometer Nut ... ..	3
5741	5741	Speedometer Bulb ... ..	1 9
6222	6222	Speedometer Head Grommet ... ..	1 3
—	4184	Cable Grommet for Mudguard ... ..	6
—	5742	Cable Grommet (Sic. 645/1621) ... ..	2
6806	—	Battery Platform ... ..	2 3
6928	—	Battery Strap complete ... ..	5 0
6351	—	Wing Nut 1/4" B.S.F. for same ... ..	9
—	7087	Battery Strap ... ..	4
—	7084	Battery Strap Rubber ... ..	1 6
—	7156	Battery Strap Retaining Washer ... ..	2
—	7082	Battery Mat ... ..	1 1
6763	7088	Twin Seat complete ... ..	5 10 0
6957	—	Twin Seat Locating Sleeve ... ..	9
—	5464	Twin Seat Nose Grommet ... ..	1 4
—	5465	Twin Seat Support Buffer ... ..	9
—	4641	Pillion Footrest ... .. pair	14 0
—	3943	John Bull clip Type "S" ... ..	4
1040	1040	Inflator ... ..	8 10
6376	6376	Kickstart Rubber ... ..	1 0
6578	6578	Electric Horn ... ..	1 3 2
6577	6577	Electric Horn Distance Piece ... ..	9

**TOOLS**

Cruiser 84	Falcon 87	Description	Price each £ s. d.
6269	6269	Tool kit complete ... ..	(Prices on application)
3844	3844	Tyre lever ... ..	
1035	1035	Screw Driver 6" ... ..	
1034	1034	Pliers 6" ... ..	
1036	1036	Open Ended Spanner 1/4" x 3/8" whit. ... ..	
1037	1037	Open Ended Spanner 1/2" x 15/16" whit. ... ..	
5288	5288	Open Ended Spanner 3/8" x 7/16" whit. ... ..	
3939	3939	Tube Spanner 3/8" x 7/16" ... ..	
3940	3940	Tommy Bar ... ..	
6234	6234	"C" Spanner for Girling units ... ..	
6284	6284	Contact breaker Feeler Gauge ... ..	
6853	6853	Cylinder Head Nut Spanner ... ..	

**TOOLS NOT INCLUDED IN TOOLROLL**

Cruiser 84	Falcon 87	Description	Price each £ s. d.
1039	1039	Chain rivet extractor ... ..	1 0 6
3845	3845	Tyre Pressure Gauge ... ..	8 11
E8676	—	Exhaust Pipe Ring Spanner ... ..	3 0

\* Plus Purchase Tax

(Always quote Frame Number when ordering spares)

**LIGHTING**

Cruiser 84	Falcon 87	Description	Price each £ s. d.
S0902	S0902	Headlamp complete with harness ... ..	5 19 0
S0244	S0244	Headlamp complete less harness ... ..	3 15 0
S0904	S0904	Lamp Body only ... ..	15 9
S0507	S0507	Reflector and Glass ... ..	13 0
01127	01127	Headlamp Glass... ..	3 6
S0066	S0066	Headlamp Rim ... ..	10 0
00915	00915	Main bulb holder unit ... ..	4 9
04938	04938	Pilot bulb holder ... ..	6
S0064	S0064	Headlamp rim screw clip set ... ..	1 1
S0070	S0070	Reflector Clip Set ... ..	1 1
S0238	S0238	Headlamp Body Fixing Bolt ... ..	2 1
S0903	—	Harness ... ..	2 0 0
—	S1081	Harness ... ..	2 7 6
S0781	S0781	Lighting Switch ... ..	13 2
S0782	S0782	Ignition Switch ... ..	13 2
S0062	S0062	Ammeter ... ..	10 3
312	312	Headlamp Main Bulb ... ..	5 0
6529	6529	Pilot Bulb ... ..	1 10
53331	53331	Rearlamp complete ... ..	17 3
526404	526404	Rearlamp Red Body ... ..	3 0
526406	526406	Rearlamp Clear Window ... ..	1 3
190	190	Rearlamp Bulb ... ..	3 6
4160	—	Battery ... ..	2 4 6
—	7081	Battery (ML 9E) ... ..	2 0 0

\*Plus Purchase Tax.

**ENGINE PARTS FOR AMC ENGINES**

**CYLINDER AND PISTON GROUPS**

Cruiser 84	Falcon 87	III. No.	Description	Price each £ s. d.
041006	—	1	Cylinder ... ..	6 19 1
—	041512	1	Cylinder ... ..	7 1 8
041024	041615	2	Cylinder base washer ... ..	1 1
041041	—	3	Piston complete—Std. ... ..	2 6 0
—	041558	3	Piston complete—Std. ... ..	2 1 6
041135	041223	4	Piston ring—top chrome ... ..	4 9
041154	041630	5	Piston ring—compression ... ..	2 3
041155	041631	6	Pressure Ring ... ..	7
041080	—	7	Gudgeon Pin ... ..	5 9
—	041603	7	Gudgeon Pin ... ..	4 9
041797	—	8	Small End Bush ... ..	3 9
—	041519	8	Small End Bush ... ..	3 9
041081	041481	9	Gudgeon Pin Circlip ... ..	3
041001	—	10	Cylinder Head ... ..	3 5 0
—	041613	10	Cylinder Head ... ..	2 7 6
041005	—	11	Cylinder Head Gasket ... ..	10
—	041203	11	Cylinder Head Gasket ... ..	9
041003	—	12	Cylinder Head Bolt ... ..	6
—	041526	12	Cylinder Head Bolt ... ..	2 3
041182	—	13	Head Stud for Torque Stay ... ..	1 7
000010	000010	14	Head Stud Washer ... ..	1
CCL.14	—	—	Sparking Plug ... ..	6 6
—	CCL.14	—	Sparking Plug ... ..	6 6
041011	—	15	Carb. Attachment Stud ... ..	7
—	041463	—	Carb. Attachment Stud ... ..	1 0
000004	—	16	Nut for Carburettor Stud ... ..	4
000011	000011	17	Washer for Carburettor Stud ... ..	1

(Always quote Frame Number when ordering spares)

CYLINDER AND PISTON GROUPS—Continued

Cruiser 84	Falcon 87	III. No.	Description	Price each £ s. d.
041013	—	18	Bakelite Spacer—Carb. Joint ...	2 11
—	023496	18	Bakelite Spacer—Carb. Joint ...	2 3
244/1048	244/765	19	"O" Ring for Spacer ...	1 0
—	041632	—	Exhaust Stub Sleeve ...	2 0
041076	—	—	Exhaust Pipe Ring ...	16 0
041115	—	—	Exhaust Pipe Collar ...	1 3
041132	—	—	Exhaust C/A Washer ...	2
6527	6527A	—	Gasket Set ...	4 0

OVERSIZES

Cruiser 84	Falcon 87	III. No.	Description	Price each £ s. d.
041160	—	—	Piston Complete, .015" ...	2 6 0
—	041578	—	Piston Complete, .015" ...	2 1 6
041164	041569	—	Piston Ring—Top Chrome .015" ...	4 9
041166	041571	—	Piston Ring—Compression .015" ...	2 3
041161	—	—	Piston Complete, .030" ...	2 6 0
—	041580	—	Piston Complete, .030" ...	2 1 6
041165	041570	—	Piston Ring—Top Chrome .030" ...	4 9
041167	041572	—	Piston Ring—Compression .030" ...	2 3

CRANKSHAFTS

Cruiser 84	Falcon 87	III. No.	Description	Price each £ s. d.
041138	—	—	Crankshaft Assembly—all parts ...	13 10 5
—	041503	—	Crankshaft Assembly—all parts ...	10 19 2
041050	—	20	Journal Bearing—Driving Side ...	1 0 9
—	041523	20	Journal Bearing—Driving Side ...	17 3
041051	—	21	Journal Bearing Spacer—Driving Side ...	2 0
—	041560	21	Journal Bearing Spacer—Driving Side ...	2 0
041058	—	22	Journal Bearing—Timing Side ...	1 11 0
—	041633	22	Journal Bearing—Timing Side ...	1 7 0
041049	—	23	Crankshaft—Driving Side ...	1 2 0
—	041449	23	Crankshaft—Driving Side ...	1 0 6
041054	—	24	Crankshaft Sleeve—Driving Side ...	4 4
—	041454	24	Crankshaft Sleeve—Driving Side ...	2 9
041056	—	25	Crankshaft—Timing Side ...	1 4 2
—	041456	25	Crankshaft—Timing Side ...	17 6
041140	—	26	Crankshaft Sleeve—Timing Side ...	4 2
—	041561	27	Crankshaft Sleeve—Timing Side ...	4 0
041191	—	26	Flywheel ...	2 13 0
041082	—	28	Flywheel Disc ...	3
041247	—	29	Crankpin ...	16 9
—	041531	29	Crankpin ...	7 9
041151	041455	30	Crankpin Side Washer ...	4 0
041137	041137	31	Crankpin Rollers ...	3
041133	041133	32	Crankpin Roller Cage ...	1 1 0
041021	041021	33	Crankshaft Key ...	6
041052	041052	34	Oil Seal ...	4 11
041042	—	35	Connecting Rod and S/E Bush ...	3 1 6
—	041533	35	Connecting Rod and S/E Bush ...	3 1 6

(Always quote Frame Number when ordering spares)

CRANKCASES

Cruiser 84	Falcon 87	III. No.	Description	Price each £ s. d.
041118	—	36	Crankcase—Sold only in pairs ...	9 0 0
—	041564	36	Crankcase—Sold only in pairs ...	7 16 1
040137	040137	—	Crankcase Drain Plug ...	7
041123	041123	—	Drain Plug Washer ...	2
041020	041020	—	Crankcase Stud ...	7
041019	041419	—	Crankcase Plain Stud ...	7
041022	041022	—	Spring Washer for same ...	1
000005	000005	—	Nut for same ...	4
041262	041262	37	Cylinder Base Stud ...	7
041010	041010	—	Spring Washer for same ...	1
041124	041124	—	Cylinder Base Stud Nut ...	7
041089	—	44	Chaincase Back Half ...	2 3 10
—	041489	44	Chaincase Back Half ...	2 0 0
—	041637	—	Chaincase Back Half Washer ...	1
041157	041574	44A	Oil Thrower ...	1 0
041090	041574	44B	Oil Thrower Oil Seal ...	3
041091	041491	44C	Oil Seal Cover ...	9
041092	—	44C	Oil Seal Cover ...	1 0
—	041573	44A	Rivet for same ...	1
041093	041093	—	Chaincase Back Half Paper Washer ...	1
016138	016138	—	Back Half Fixing Screw ...	1
041097	041097	—	Front Chaincase—Outer ...	1 17 0
041031	041431	45	Front Chaincase Gasket ...	6
041113	041433	45A	Name Plate ...	5 9
041069	041069	—	Name Plate Screws ...	3
041067	041067	—	Name Plate Washers ...	3
041066	041066	—	Chaincase Outer Half Fixing Screws ...	4
000484	000484	—	Chaincase Oil Level Plug ...	1 3
041034	041034	—	Fibre Washer for same ...	2
000202	000202	—	Timing Side Cover Assembly ...	4 6 7
041131	—	46	Timing Side Cover Assembly ...	3 18 7
—	041485	47	Timing Side Cover Washer ...	7
041035	041462	48	Timing Side Name Plate ...	5 9
041068	041068	49	Timing Side Name Plate Washer ...	3
041066	041066	50	Name Plate Fixing Screws ...	3
041067	041067	51	Timing Side Cover Screw—Short ...	4
000484	000484	52	Timing Side Cover Screw—Long ...	3
041084	041084	53	Timing Side Cover Screw—Centre ...	3
041086	041086	54	Timing Side Cover Screw—Bottom ...	3
041085	041085	—	Timing Cover Stud ...	1 2
041087	041087	55	Clutch Cable Inspection Plate ...	5 0
041104	041104	—	Washer for same ...	2
040057	040057	56	Fixing Screw for Inspection Plate ...	2
000450	000450	57	Engine Sprocket ...	12 10
041053	—	57	Engine Sprocket ...	9 0
—	041453	—	Engine Sprocket Shim ...	6
041192	041192	58	Engine Sprocket Nut ...	11
000230	000230	59	Front Chain ...	11 8
041114	—	59	Front Chain ...	11 3
—	041430	60	Generator Adaptor Cover ...	1 1 8
041062	041062	61	Generator Adaptor Stud ...	3
041064	041064	62	Nut for same ...	4
000005	000005	63	Washer for same ...	1
000012	000012	—	Spacer for Generator Cover ...	1 9
041012	041438	64	Nut for same ...	11
000230	000230	—	Generator Rotor Key ...	6
041021	041021	—	Generator Rotor Washer ...	1
000176	—	—	Generator Rotor Washer ...	4
—	021590	—	Generator Rotor Washer ...	4

(Always quote Frame Number when ordering spares)

# AMC ENGINE UNIT 25T 249 cc. — 20T 199 cc.

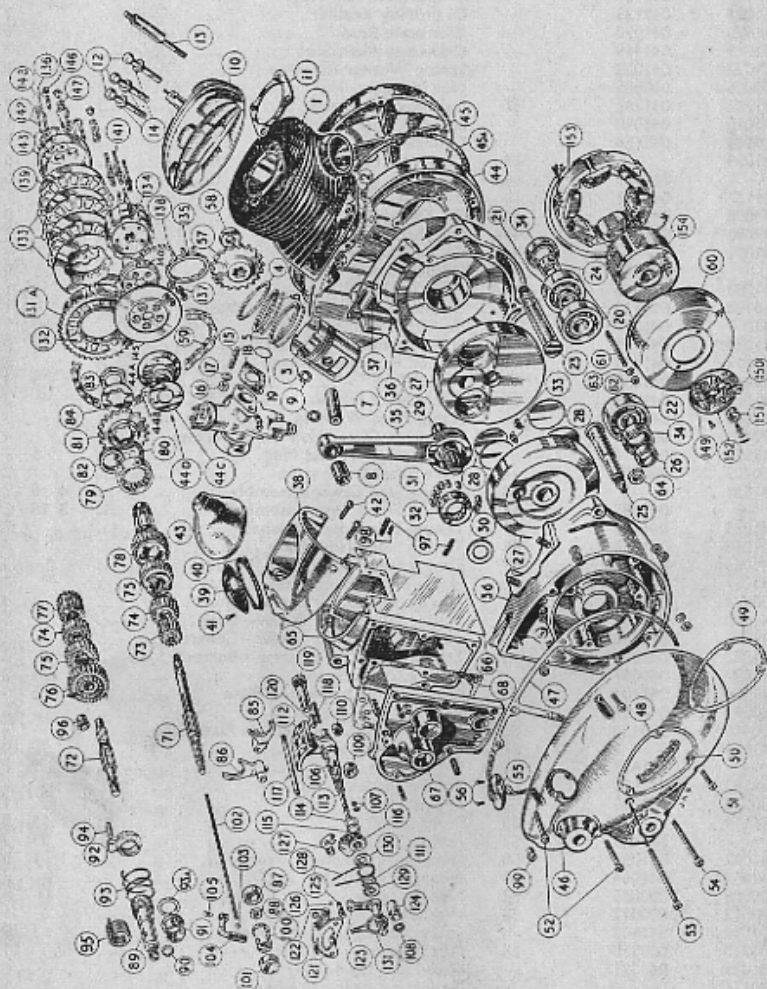

(Always quote Frame Number when ordering spares)

## GEARBOX INTERNALS

Cruiser 84	Falcon 87	III. No.	Description	Price each
				£ s. d.
041257	—	65	Gearbox Shell	5 2 6
—	041671	65	Gearbox Shell	5 7 1
040138	040138	—	Gearbox Drain Plug	6
000200	000200	—	Fibre Washer for same	4
041338	041683	66	Gearbox Shell Shim	6
041297	041670	67	Gearbox End Plate	3 0 0
041261	041655	68	End Plate Gasket	3
000347	000347	—	End Plate Fixing Bolt	5
041139	041139	69	End Plate Screws	2
041256	041256	70	End Plate Dowel	9
041263	—	71	Mainshaft	1 18 0
—	041657	71	Mainshaft	1 16 0
041288	—	72	Layshaft	1 6 3
—	041666	72	Layshaft	1 4 6
041279	—	73	Mainshaft 1st gear	8 6
—	041665	73	Mainshaft 1st gear	8 0
041277	—	74	Mainshaft 2nd gear	18 6
—	041664	74	Mainshaft 2nd Gear	18 0
041276	—	75	Mainshaft 3rd Gear	1 7 0
—	041663	75	Mainshaft 3rd Gear	1 6 0
041291	—	76	Layshaft 1st Gear (k.s. ratchet)	1 8 4
—	041669	76	Layshaft 1st Gear (k.s. ratchet)	1 7 6
041276	—	75	Layshaft 2nd Gear	1 7 0
—	041663	75	Layshaft 2nd Gear	1 6 0
041277	—	74	Layshaft 3rd Gear	18 6
—	041664	74	Layshaft 3rd Gear	18 0
041290	—	77	Layshaft High Gear	8 6
—	041668	77	Layshaft High Gear	8 0
041273	—	78	High Gear Sleeve	2 10 8
—	041662	78	High gear sleeve	2 6 0
041266	—	79	High Gear Sleeve Bearing	1 15 3
—	017191	79	High Gear Sleeve Bearing	19 6
041267	041267	80	Oil Seal	3 0 0
041268	—	81	Final Drive Sprocket	12 6
—	041528	81	Final Drive Sprocket	12 6
041391	—	82	Spacer for same...	4 0 0
—	041680	82	Spacer for same...	3 3 0
041271	—	83	Final Drive Sprocket Nut	1 9
—	041660	83	Final Drive Sprocket Nut	1 6
041272	041661	84	Washer for same	6
041341	041341	85	Mainshaft Selector Fork	1 10 6
041343	041343	86	Layshaft Selector Fork	1 10 6
012545	012545	87	Mainshaft Bearing	14 3
041265	041265	88	Mainshaft Nut	10
041398	041398	—	Mainshaft Nut Washer	3
042899	042899	—	Mainshaft Lock Washer	8
041293	041293	89	K.S. Shaft Assembly	1 18 8
040006	040006	90	"O" Ring for same	1 2
041102	041102	91	K.S. Shaft Bush—Outer	7 0
041300	041300	92	K.S. Ratchet	1 0 6
041358	041358	93	Ratchet Spring	10
041301	041301	93A	K.S. Shaft thrust washer	9
041468	041468	94	K.S. Shaft Stop Pin	1 9
040043	040043	95	K.S. Return Spring	1 2
041289	041667	96	Layshaft Bush—Box	5 9
041395	—	—	Layshaft Bush Welsh Plug	9
—	041682	—	Layshaft Bush Welsh Plug	6
041262	041262	97	Gearbox Attachment Stud	7
000004	000004	—	Nut for same	4
000577	000577	98	Gearbox Dowel	1
041057	041057	99	Gearbox Oil Level Screw	6
041055	041055	—	Fibre Washer for same	1

(Always quote Frame Number when ordering spares)



### KICK STARTER

Cruiser 84	Falcon 87	III. No.	Description	Price each £ s. d.
041177	041177	—	K.S. Crank Assembly ... ..	2 1 2
6376	6376	—	K.S. Rubber only ... ..	1 0
041176	041176	—	K.S. Crank only ... ..	1 6 8
000367	000367	—	K.S. Crank bolt ... ..	10
000004	000004	—	Nut for same ... ..	4
000011	000011	—	Washer for same ... ..	1
040431	040431	—	K.S. Pedal ... ..	12 6
040432	040432	—	K.S. Crank dome nut ... ..	1 9
000010	000010	—	Washer for same ... ..	1
040433	040433	—	K.S. Crank Spring Steel Washer ... ..	2

### CLUTCH OPERATOR MECHANISM

Cruiser 84	Falcon 87	III. No.	Description	Price each £ s. d.
041282	041282	100	Clutch Operator Body ... ..	11 3
041280	041280	101	Locking Ring for same ... ..	2 0
041346	—	102	Clutch Push Rod ... ..	2 0
—	041675	102	Clutch Push Rod ... ..	2 0
011645	011645	103	Clutch Operating Ball ... ..	2
041305	041305	—	Clutch Operating Body Peg ... ..	3
041281	041281	104	Clutch Lever ... ..	15 9
041325	041325	—	Clutch Lever Spring ... ..	3
041278	041278	105	Clutch Lever Trunnion ... ..	2 7
041264	041264	—	Clutch Trunnion Circlip ... ..	2
014225	014225	—	Clutch Cable Adjuster ... ..	11
011375	011375	—	Clutch Cable Adjuster Nut ... ..	2

### FOOTCHANGE MECHANISM

Cruiser 84	Falcon 87	III. No.	Description	Price each £ s. d.
041332	041673	106	Footchange Ratchet Shaft ... ..	1 11 6
040079	040079	107	Inner "O" ring for same ... ..	7
040006	040006	108	Outer "O" Ring for same ... ..	1 2
041299	041299	109	Ratchet Shaft Bush—Outer ... ..	3 0
041307	041307	110	Ratchet Shaft Bush—Inner ... ..	10
041394	041394	—	Ratchet Shaft Bush—Welsh Plug ... ..	6
041340	041340	111	Ratchet Shaft Bush Nut ... ..	6
041334	041334	112	Cam Segment ... ..	2 12 0
041393	041393	—	Ratchet Shaft Circlip ... ..	2
041333	041333	113	Ratchet Shaft Spindle ... ..	4 9
041389	041389	114	Ratchet Shaft Washer—Large ... ..	1
041390	041390	115	Ratchet Shaft Washer—Small ... ..	1
041283	041283	116	Footchange Ratchet ... ..	13 7
041345	041674	117	Footchange Striker Shaft ... ..	4 6
040045	040045	118	Cam Plate Plunger Spring ... ..	3
041335	041335	119	Cam Plunger Bolt ... ..	1 7
040034	040034	120	Plunger for Cam Plate ... ..	3 1
041158	041521	121	Footchange Stop Plate Assembly ... ..	3 5
041400	041400	122	Footchange Stop Plate Bolt ... ..	3
014117	014117	—	Washer for same ... ..	1
041321	041321	123	Footchange pawl Carrier ... ..	1 4 6
041101	041101	124	Gearchange Bush—Outer ... ..	1 7
041322	041322	125	Pawl Carrier Pin ... ..	1 5
041285	041285	126	Pawl Carrier Circlip ... ..	2
041326	041326	127	Footchange Ratchet Pawl ... ..	11 6
041327	041327	128	Pawl Spring ... ..	6
041640	041640	129	Pawl Spring Cup Washer ... ..	6

(Always quote Frame Number when ordering spares)

### FOOTCHANGE MECHANISM—Continued

Cruiser 84	Falcon 87	III. No.	Description	Price each £ s. d.
041323	041323	130	Pawl Spring Inner Washer ... ..	1
041524	041311	—	Footchange Pedal ... ..	17 0
041467	041467	—	Pedal End Cap ... ..	1 3
040086	040086	—	Pedal Rubber ... ..	1 2
040105	040105	—	Pedal Pinch Bolt ... ..	1 2
000005	000005	—	Nut for bolt ... ..	4
000012	000012	—	Washer for bolt ... ..	1
041328	041328	131	Footchange Pedal Return Spring ... ..	9
040051	040051	—	Gear Indicator ... ..	1 9
040137	040137	—	Indicator Screw ... ..	7
000012	000012	—	Indicator Screw Washer ... ..	1

### CLUTCH ASSEMBLY

Cruiser 84	Falcon 87	III. No.	Description	Price each £ s. d.
041357	041357	131A	Clutch Sprocket and inserts ... ..	2 5 0
045250	045250	133	Friction Plate and inserts ... ..	6 6
045161	045161	134	Clutch Centre ... ..	1 4 4
041367	041367	135	Roller Cage ... ..	2 4
041348	041348	136	Clutch Adjuster ... ..	4
000080	000080	137	Nut for Clutch Back Plate ... ..	1
041366	041366	138	Roller for Clutch Sprocket ... ..	set 2 11
045249	045249	139	Clutch Plate Plain ... ..	3 0
045162	045162	140	Clutch Race Plate ... ..	11 0
041382	041382	141	Clutch Spring Stud ... ..	2 4
041392	041392	142	Clutch Spring Cup ... ..	9
045165	045165	143	Clutch Pressure Plate ... ..	8 0
045252	045252	145	Clutch Back Plate ... ..	10 6
041370	041370	146	Nut for Clutch Adjuster ... ..	3
041353	041353	147	Clutch Spring ... ..	9
041383	041383	148	Nut for Clutch Spring—Outer ... ..	6

### IGNITION

Cruiser 84	Falcon 87	III. No.	Description	Price each £ s. d.
SO793	SO793	—	Ignition Coil ... ..	1 10 0
SO226	SO226	149	Condenser ... ..	5 3
01823	01823	150	Contact Breaker ... ..	7 11
SO223	SO223	151	Cam ... ..	5 9
5446M	5446M	—	Grease Pad for Cam ... ..	2
SO224	SO224	152	Base Plate for Contact Breaker ... ..	16 4
06252	06252	—	Rectifier ... ..	2 0 0
SO216	SO216	153	Alternator Unit Complete ... ..	7 0 6
SO221	SO221	154	Rotor ... ..	3 17 6

(Always quote Frame Number when ordering spares)

CARBURETTOR—FALCON 87/CRUISER 84

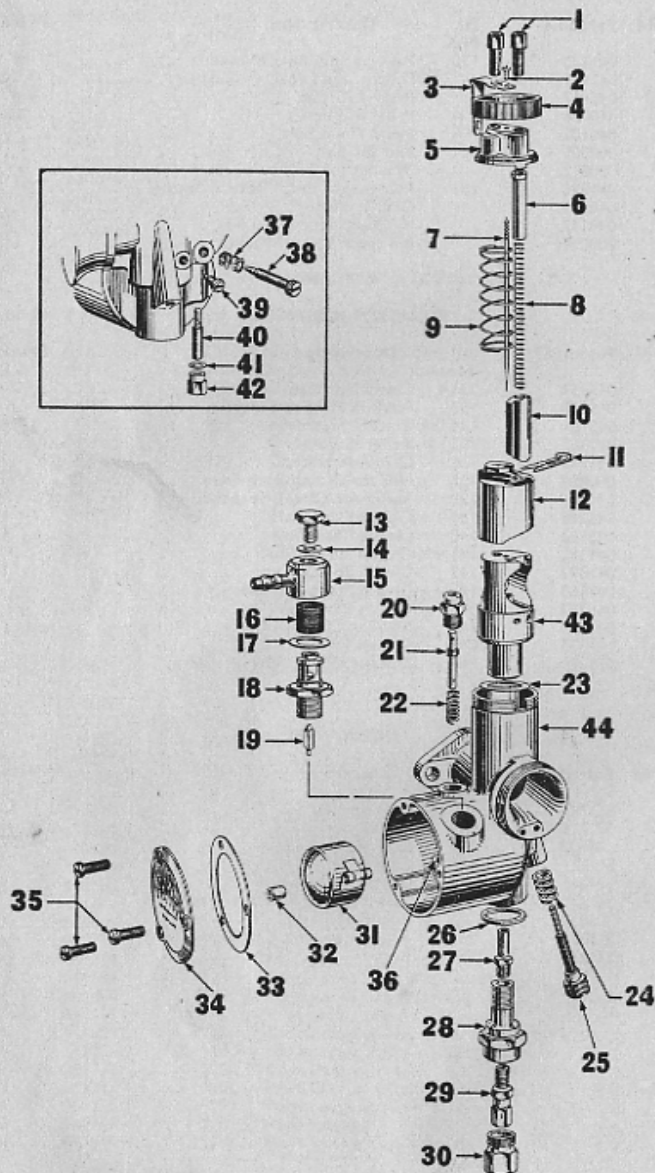
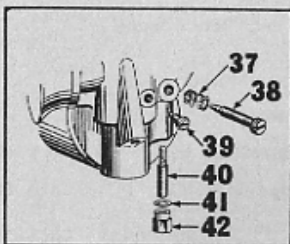

(Always quote Frame Number when ordering spares)

AMAL CARBURETTOR 389 FOR CRUISER 84

AMAL CARBURETTOR 376/231 FOR FALCON 87

Cruiser 84	Falcon 87	Ill. No.	Description	Price each £ s. d.
389/27	—	—	Carburettor Complete...	5 5 0
—	376/231	—	Carburettor Complete	5 0 0
4/035	4/035	1	Cable Adjuster ...	9
4/241	4/241	2	Fixing Screw For Cap Springs	2
29/201	4/235	3	Cap Spring for Top with Adjuster Ferrule	1 0
389/064	376/064	4	Mixing Chamber Top Cap Ring	4 0
389/065	376/065	5	Mixing Chamber Top (std.)	4 0
29/037	6/047	6	Air Valve Guide	1 8
389/063	376/063	7	Taper Needle	3 0
4/046	4/046	8	Air Valve Spring	4
389/061	376/061	9	Throttle Valve Spring	7
389/062	376/062	10	Air Valve	5 6
4/230	4/230	11	Needle Clip	7
389/060	376/060	12	Throttle Valve	8 6
376/091	376/091	13	Banjo Bolt	8
376/092	376/092	14	Banjo Bolt Washer	2
376/127	—	15	Banjo Single	2 9
—	376/138	15	Banjo Single	3 9
376/093	376/093	16	Filter Gauze	1 0
376/074	376/074	17	Banjo Washer	2
376/088	376/088	18	Needle Seating	3 3
376/089	376/089	19	Float Needle	2 0
376/125	—	20	Tickler Body	1 6
—	343/011	20	Tickler Body	1 8
376/126	—	21	Tickler	1 8
—	376/086	21	Tickler	1 3
376/087	376/087	22	Tickler Spring	2
376/067	376/067	23	Washer for Jet Block	2
376/069	376/069	24	Throttle Stop Screw Spring	3
376/068	376/068	25	Throttle Stop Screw	1 0
376/074	376/074	26	Main Jet Holder Washer	2
376/072	376/072	27	Needle Jet	3 6
376/073	376/073	28	Main Jet Holder	5 0
376/100	376/100	29	Main Jet	1 9
376/075	376/075	30	Main Jet Cover Nut	1 3
376/083	376/083	31	Float Complete	6 6
376/094	376/094	32	Float Spindle Bush	4
376/078	376/078	33	Float Chamber Cover Joint	4
376/077	376/077	34	Float Chamber Cover	3 3
376/079	376/079	35	Float Chamber Cover Screws...	2
376/085	376/085	36	Float Hinge Spindle	8
4/148	4/148	37	Air Adjusting Screw Spring	4
332/017	332/017	38	Air Adjusting Screw	1 0
—	376/070	39	Locating Peg for Jet Block	7
376/076	376/076	40	Pilot Jet	1 3
116/162	—	—	Pilot Jet Washer	2
—	—	41	Pilot Jet Cover Nut Washer	1 6
376/095	376/095	42	Pilot Jet Cover Nut	1 0
389/056	—	43	Jet Block $\frac{1}{8}$ " Bore	16 0
—	376/056	43	Jet Block $\frac{1}{8}$ " Bore	14 6
—	376/002	44	Mixing Chamber Body, Type 376	1 13 6
389/27	—	44	Mixing Chamber Body, Type 376	1 19 0
6694	005809	—	Air Cleaner Complete	1 9 6

(Always quote Frame Number when ordering spares)

## PLOVER 86 1960

### FRAME

Part No.	Ill. No.	Description	Price each		
			£	s.	d.
003355	1	Frame Dorsal Tube	5	4	0
005404	2	Engine Loop Tube	2	7	5
005615	3	Engine Steady	1	6	
005400	4	Rear Engine Lug	2	9	
004081	5	Centre Section	8	4	6
003678	6	Toolbox Lid	5	4	
—	—	Transfer	6		
000641	7	Tool Box Thumbscrew	2	0	
900350	—	Tool Box Thumbscrew Washer	1	0	
003656	8	Battery Bracket	1	0	
002484	—	Battery Insulating Strip	4		
003435	9	Footrest & Brake Pedal Bar	6	10	
003433	10	B/Pedal Spring Housing	5	6	
003431	11	B/Pedal Spring	1	0	
004055	12	B/Pedal	15	10	
002367	13	Brake Rod	2	3	
002382	14	Brake Lever Roller	1	4	
000342	15	Brake Rod Adjuster	2	7	
005709	16	Footrest Hanger	7	10	
002026	17	Footrest Rubber	1	11	
003436	18	Footrest Spacer	1	2	
004231	19	Pivot Tube Centre Stand	10	0	
005725	20	Centre Stand	1	17	0
003383	21	Centre Stand Operating Rod	1	8	
003395	22	Centre Stand Spring	1	0	
003415	23	Rear Suspension Torque Tube	10	2	
003526	24	Rear Suspension Torsion Bush	5	2	
004186	25	Rear Suspension Pivot Fork	3	10	2
004286	26	Rear Suspension Coil Spring	16	3	
003446	27	Rear Suspension Rubber Grommet	13	0	
003443	28	Chainguard	13	0	
003479	29	Chainguard Spacer	5		
005863	30	Rear Mudguard	5	17	0
005714	—	Rear Mudguard Plastic Beading	1	10	
—	6218	Twinseat	4	19	6
—	6288	Twinseat Distance Piece	9		
004479	32	Damper Unit (Optional Extra)	2	0	9
003978	—	Pillion Footrest Stiffener Plate	4	7	
006065	—	Toolbox Rubber Grommet			

### NUTS, BOLTS, WASHERS AND SPLIT PINS

Part No.	Ill. No.	Description	Price each		
			£	s.	d.
900171	33	Hex. Bolt $\frac{3}{8}$ " x 26	5		
900094	34	Hex. Bolt $\frac{1}{2}$ " x 26 x $1\frac{1}{4}$ "	10		
900290	35	Hex. Bolt $\frac{1}{2}$ " x 26 x 2"	10		
045050	36	D/E Stud. $4\frac{3}{8}$ " LG Eng. Front	9		
045055	—	D/E Stud. $3\frac{1}{2}$ " LG Eng. Bottom	6		
900468	—	D/E Stud. $3\frac{1}{2}$ " LG Eng. Rear	1	2	
900384	37	Hex. Bolt. $\frac{3}{8}$ " x 26 x $\frac{3}{8}$ " LG.	10		
900025	—	Hex. Bolt. $\frac{1}{2}$ " BSC x 1" LG. Twinseat...	4		
900027	38	Hex. Nut. $\frac{1}{2}$ " BSC.	3		
900285	39	Hex. Nut	5		
900005	40	Hex. Nut Washer	1		
900017	—	Hex. Nut $\frac{3}{8}$ " x 20	4		
900035	41	Hex. Nut $\frac{1}{2}$ " x 26	4		

(Always quote Frame Number when ordering spares)

### FRAME AND REAR SUSPENSION COMPONENTS

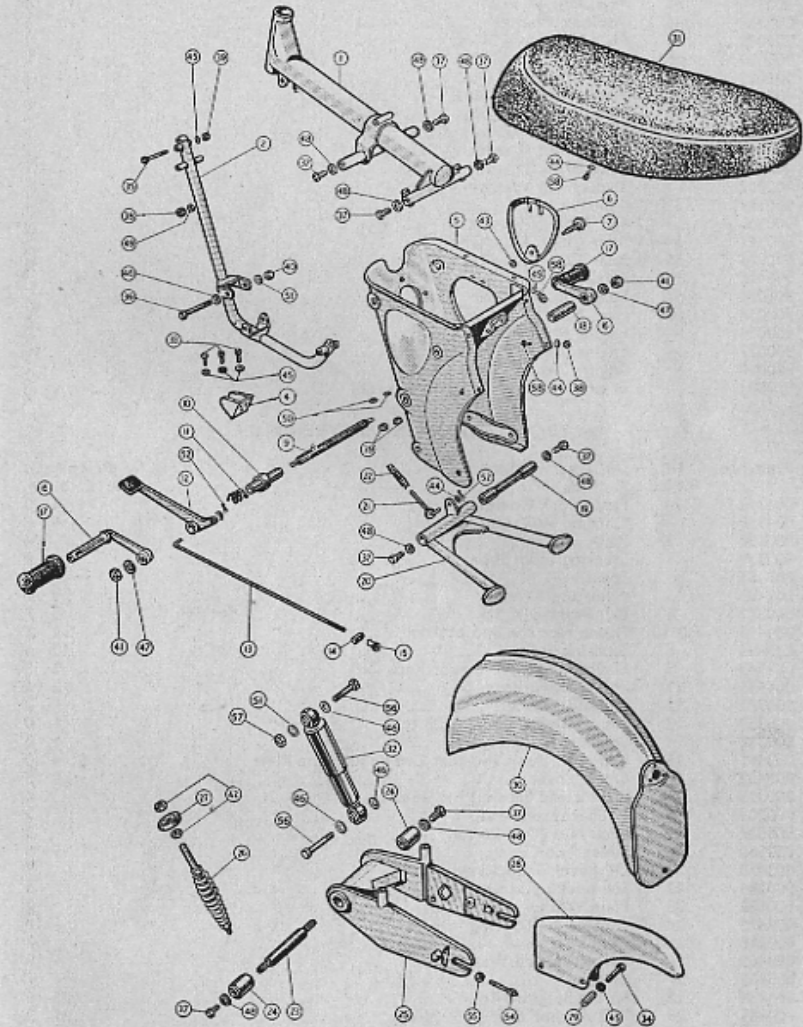

(Always quote Frame Number when ordering spares)

NUTS, BOLTS, WASHERS AND SPLIT PINS—Continued

Part No.	Ill. No.	Description	Price each £ s. d.
900390	42	Hex. Nut $\frac{1}{2}$ " x 26	5
900350	43	Toolbox Washer	5
900008	44	Plain Washer $\frac{1}{2}$ " Dia.	2
900009	45	Plain Washer $\frac{3}{8}$ " Dia.	2
900011	46	Plain Washer $\frac{1}{2}$ " Dia.	2
900033	47	Plain Washer $\frac{3}{8}$ " Dia.	2
900030	48	Plain Washer $\frac{1}{2}$ " Dia.	2
900004	49	Shakeproof Washer $\frac{1}{2}$ " Dia.	2
900003	50	Shakeproof Washer $\frac{3}{8}$ " Dia.	2
000011	51	Shakeproof Washer $\frac{1}{2}$ " Dia.	1
900002	—	Shakeproof Washer $\frac{3}{8}$ " Dia.	2
900121	52	Split Pin	2
900155	53	Self Tapping Screws	2
900387	54	Rear Chain Adjuster	4
900023	55	Rear Chain Adjuster Locknut	3
900410	56	Hex. Bolt $\frac{3}{8}$ " x 26 x 1 $\frac{1}{2}$ " LG.	5
900021	57	Hex. Nut $\frac{3}{8}$ " x 26	4
900054	58	Hex. Bolt $\frac{3}{8}$ " x 26	4
900054	—	Engine Steady Bolt	4
900027	—	Engine Steady Nut	4
900008	—	Engine Steady Washer Plain	3
900004	—	Engine Steady Washer Shakeproof	2

FRONT FORKS AND STEERING

Part No.	Ill. No.	Description	Price each £ s. d.
004313	—	Front Fork Complete	14 6 0
004348	—	Chrome Hex. Nut Domed	4 8
900197	2	Plain washer	4
900389	3	Steering Stem Shim	3
003457	4	Spacer $\frac{5}{16}$ "	10
004497	5	Adjusting Race	3 7
000371	6	Ball Bearing $\frac{1}{2}$ " dia.	2 7
004495	7 & 10	Frame race top and bottom	2 3
003894	8	Steering Stem	12 4
002942	9	Enclosed Cup for Lower Race	2 3
004496	11	Fork Crown Race	2 11
900383	12	$\frac{3}{8}$ " Plain Washer	3
900353	13	Adjustment Nut $\frac{3}{8}$ " x 26 tpi.	1 0
900352	14	Locknut $\frac{3}{8}$ " 26 tpi.	1 0
003461	15	Fork 'H' Assy. includes Crown and Top Plate	5 4 0
003462	16	Outer cover	8 5
900315	17	Mush Head Screw $\frac{1}{4}$ " x 26 tpi.	4
900004	18	$\frac{1}{4}$ " Shakeproof washer	2
900027	19	Hex. Nut $\frac{1}{4}$ " x 26 tpi.	3
003550	20	Slider Tube	1 19 0
003478	21	Oil Level Grub Screw	7
900284	22	Self Locking Screw $\frac{1}{4}$ " x 26 tpi.	5
900162	23	Plain Washer $\frac{1}{2}$ " Dia.	2
004475	24	Tension Coil Spring	5 10
900418	25	Plain Washer	3
003469	26	Spring Return Washer	10
003468	27	Circlip	7
004484	28	Spring Support Rod	6 6
900385	29	Rod Anchor Bolt $\frac{1}{4}$ " x 26 tpi.	1 2
900144	30	Fibre Washer	2
003956	31	Handlebar	2 9 6
002923	32	Recessed Washer $\frac{1}{2}$ " Dia.	1 1
900369	33	Hex. Bolt $\frac{1}{2}$ " Dia. x 26 tpi.	1 0
004196/7	34	Fork Stiffeners	4

(Always quote Frame Number when ordering spares)

FRONT FORK COMPONENTS — PLOVER 86

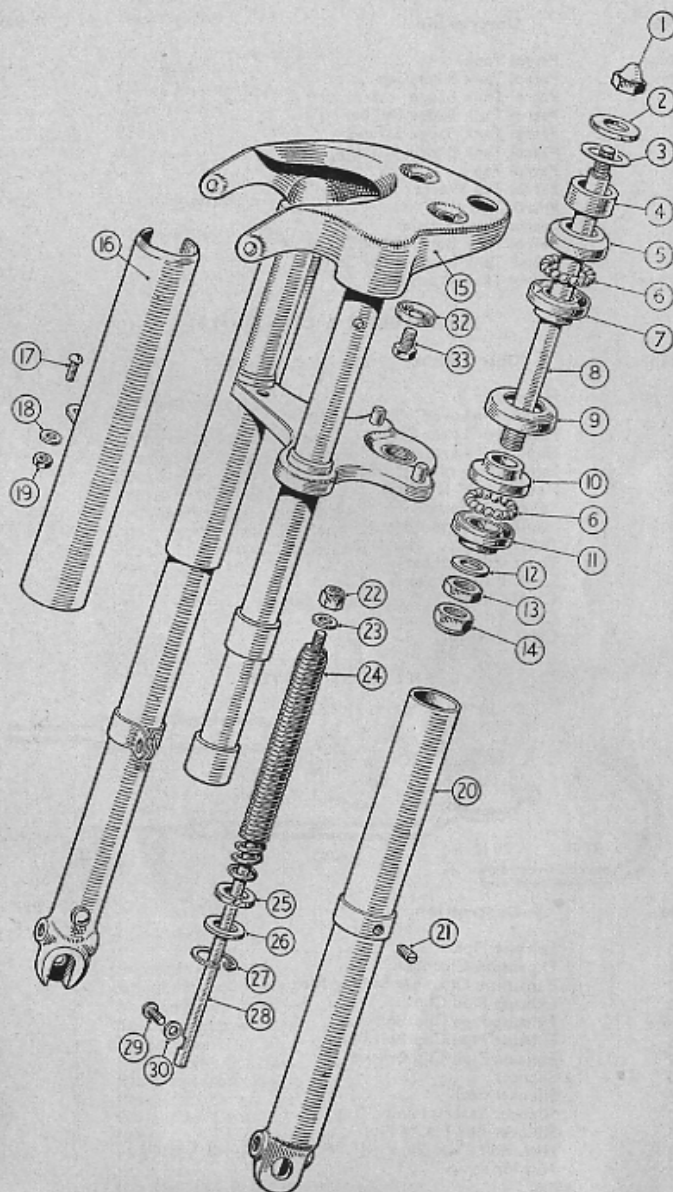

(Always quote Frame Number when ordering spares)

### PETROL TANK

Part No.	Description	Price each	
		£	s. d.
005625	Petrol Tank	5	10 6
005704	Petrol Tank Filler Cap	10	0
6001	Petrol Tank Badge	3	0
002816	Petrol Tank Badge Rubber	1	4
900325	Petrol Tank Badge Screws	2	
005713	Petrol Tank Plastic Beading	3	0
003166	Petrol Tap	7	2
900373	Petrol Tap Washer	5	
002190	Petrol Pipe	1	11
002063	Petrol Pipe Ferrules	5	
900041	Petrol Tank Bolts $\frac{1}{8}$ " x 26 tpi. x 3"	5	
900000	Petrol Tank Nuts $\frac{1}{8}$ " x 26 tpi.	3	
900009	Petrol Tank Washer	2	

### HANDLEBAR & CONTROLS

Part No.	Description	Price each	
		£	s. d.
004722	Handlebar	2	9 6
003957	Handlebar Lever. Clutch & Brake	7	3
003958	Handlebar Lever Spacer	4	
900419	Handlebar Lever Pivot Pin	2	
900403	Self Locking Nut. $\frac{1}{4}$ " BSC.	4	
900369	Hex. Bolt $\frac{1}{2}$ " x 26 tpi.	1	0
002923	Spherical Washer	1	1
002643	Handlebar Grip L.H.	1	6
005703	Twist Grip	9	6
002642	Twist Grip Rubber	1	6
003637	Cable Front Brake	3	6
005955	Cable Clutch	3	6
005546	Cable Throttle	3	6
003993	Cable Speedo.	1	2 6

### EXHAUST SYSTEM

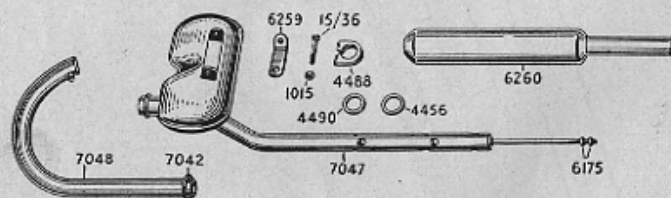

Part No.	Description	Price each	
		£	s. d.
7048	Exhaust Pipe	1	19 0
7047	Expansion Chamber	1	16 0
7042	Expansion Chamber Sealing Ring	1	3
4488	Exhaust Pipe Clip	3	0
15/36	Exhaust Pipe Clip Bolt	8	
1015	Exhaust Pipe Clip Bolt Nut	3	
6259	Exhaust Pipe Clip Bracket	1	0
6260	Silencer	2	5 0
4456	Silencer Seal	1	3
4490	Silencer Seal Retaining Cup	1	6
6175	Silencer End Fixing Nut	3	
900392	Hex. Bolt $\frac{1}{4}$ " x 26 x $\frac{1}{2}$ " Securing Silencer Casting	8	
900284	Nut for same.	5	

(Always quote Frame Number when ordering spares)

### R. CHAIN ROLLER TENSIONER

Part No.	Description	Price each	
		£	s. d.
004320	Chain Roller Pivot Bracket	1	5
004323	Rubber Roller	8	
004324	Sleeve Rubber Roller	7	
900162	Plain Washer	2	
900121	Split Pin	1	

### TRANSMISSION

Part No.	Description	Price each	
		£	s. d.
110038/58	Primary Chain — 58 Link	11	3
004869	Rear Chain 110044 — 118 Link	2	4 8
1838	Rear Chain Single Connecting Link	9	
1840	Rear Chain Double Cranked Link	1	4
1841	Rear Chain Spring Clip	2	
1039	Chain Rivet Extractor	18	11

### WHEELS AND SPOKES

Part No.	Description	Price each	
		£	s. d.
003558	Front wheel complete (less tyre and tube)	7	1 5
003621	Rear wheel complete (less tyre and tube)	10	7 4
003585 R.H.	Spokes (front R.H.) 12 s.w.g. x 7"	Set	8 0
003703 L.H.	Spokes (front L.H.) 12 s.w.g. x 6 $\frac{1}{2}$ "	"	8 0
003705	Spokes (Rear) 10 s.w.g. x 6 $\frac{1}{2}$ "	"	8 0
003707	Spoke nipples front 12 s.w.g. x .250"	"	8 0
000254	Spoke nipples rear 10 s.w.g. x .250"	"	8 0
003569	Rim. W.M.1. 18"	1	0 10

### FRONT HUB 4"

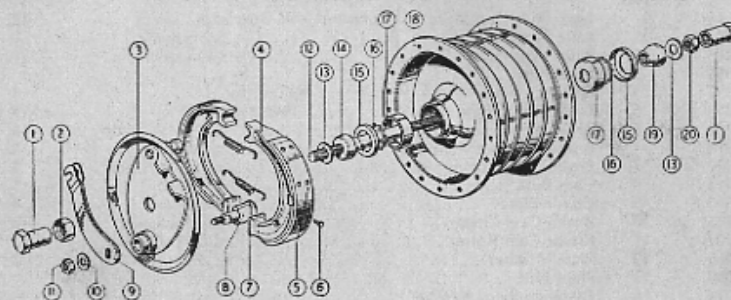

Part No.	III. No.	Description	Price each	
			£	s. d.
003783	—	Front Hub Complete	4	18 10
900359	1	Spindle Nut $\frac{7}{16}$ " x 26 t.p.i.	3	3
900360	2	Recessed Nut $\frac{7}{16}$ " x 26 t.p.i.	8	
003801	3	Brake Backplate	13	0
000690	4	Brake Shoe & Lining	pair	13 0
000370	5	Brake Lining & Rivets	pair	4 6
000369	7	Brake Return Spring	5	
000692	8	Brake Cam	3	3
002924	9	Brake Cam Lever	2	7
900166	10	Brake Cam Special Washer	2	
900000	11	Hex. Nut $\frac{7}{16}$ " x 26 t.p.i.	3	

(Always quote Frame Number when ordering spares)

**FRONT HUB 4"—Continued**

003470	12	Spindle	...	...	...	4	7
900013	13	Plain Washer $\frac{7}{16}$ " x 16 s.w.g.	...	...	...		2
000360	13	Lockwasher (adjustment cone)	...	...	...		2
000358	14	Fixed Cone	...	...	...	2	11
000353	15	Dust Cap	...	...	...		5
000371	16	Ball Bearing $\frac{1}{2}$ "	...	...	per set 20	2	7
000351	17	Bearing Cup	...	...	...	1	11
003789	18	Hub Shell and Brake Drum	...	...	...	1	19 0
000359	19	Adjusting Cone	...	...	...	3	3
900034	20	Hex. Locknut	...	...	...		4

**REAR HUB 5"**

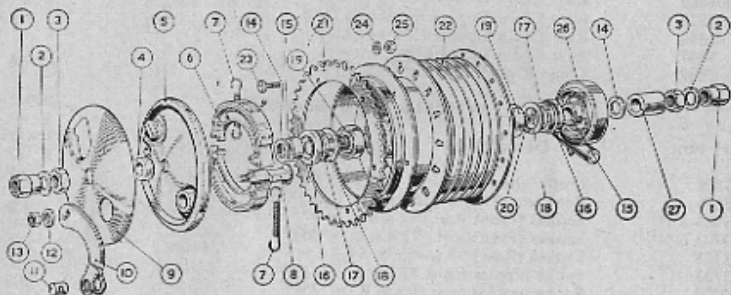

Part No.	Ill. No.	Description	Price each
			£ s. d.
003626/1	—	Rear Hub Complete less Sprocket and Gearbox	7 12 6
900047	1	Axle Nut	3 3
900015	2	Plain Washer	2
900051	3	Lock Nut	4
001337	4	Distance Piece	1 4
003818	5	Brake Back Plate	19 6
002282	6	Brake Shoes and Liners	16 3
000314	—	Brake Liners and Rivets	4 6
000320	7	Brake Shoe Spring	1 4
001415	8	Cam Bolt	5 2
004609	9	Cover Plate	4 0
001816	10	Brake Cam Lever	3 11
002382	11	Brake Cam Roller	1 4
900166	12	Plain Washer	2
900000	13	Plain Nut	3
900015	14	Distance Piece Washer	2
001335	15	Distance Piece	1 0
003006	16	Enclosure Cup	8
003007	17	Felt Seal	8
003005	18	Plain Enclosure Washer	4
003008	19	Bearing	17 3
002961	20	Spindle	13 0
002025	21	Sprocket — 48T.	19 6
003814	22	Hub Shell	3 5 0
900367	23	Sprocket Bolt	3
900004	24	Shakeproof Washer	2
900027	25	Nut for same	3
52283/62/1	26	Speedometer Gearbox	1 17 6
001805	27	Spacer — $\frac{1}{8}$ "	1 0

(Always quote Frame Number when ordering spares)

**FRONT MUDGUARD**

Part No.	Description	Price each
		£ s. d.
004125	Front Mudguard with No. Plate Brackets	1 10 7
005703	Tubular Stay and Cotters	13 8
900442	Cap Nut	1 6
900354	Cotter Bolt $\frac{3}{8}$ " x 26 t.p.i.	4
004292	Bridge Piece	4 4
003475	Bridge Attachment Clip	2 9
900108	R.H. Clip Bolt $\frac{3}{8}$ " x 26	5
003474	L.H. Clip Bolt and Brake Adjustment Bolt	1 11
900009	Plain Washer $\frac{3}{8}$ " dia.	2
900000	Hex. Nut $\frac{3}{8}$ " x 26	3
900315	Domed Screws $\frac{1}{4}$ " x 26	4
900004	Plain Washer $\frac{1}{2}$ " dia.	2
900027	Hex. Nut $\frac{1}{2}$ " dia.	3
900404	Unbrako Screw $\frac{1}{4}$ " dia. B.S.F.	3
002375	No. Plate — Front	3 3
900010	Round Head Screw $\frac{3}{8}$ "	2
900016	Round Head Screw Nut $\frac{3}{8}$ "	2

**SUNDRIES**

Part No.	Description	Price each
		£ s. d.
005733	Sparking Plug, HLN	5 6
003642	Speedo Head	2 0 0
003156	Speedo Head Grommet	5
003993	Speedo Cable	1 2 6

**TOOL KIT**

Part No.	Description	Price each
		£ s. d.
—	Tool Roll Complete	} Prices on Application
003971	Plug Spanner	
002536	Cone Spanner	
003869	Steering Head Spanner	
000544	Tyre Lever	
004413	Feeler Gauge	
000595	Tyre Inflator	8 5

**LIGHTING — WICO PACEY**

Part No.	Description	Price each
		£ s. d.
S1127	Headlamp Less Harness, DL	3 8 0
S1057	Headlamp Less Harness, Rect. Lighting	3 8 0
S0912	Headlamp Body	15 0
S0237	Light Unit & Rim	1 7 4
S0066	Headlamp Rim	10 0
S0915	Main Bulb Holder	4 9
04938	Pilot Bulb Holder	6
S0064	Headlamp Rim Clip Set	1 1
S0070	Reflector Clip Set	1 1
S0238	Headlamp Fixing Set	2 1
S0924	Cable Harness, DL	1 5 0
S1058	Cable Harness (Rect. L)	1 5 0
S0781	Lighting Switch	13 2
S0783	Lighting Switch Handle	1 9
S0062	Ammeter	10 3
S0229	Tail Lamp	1 0 6
S0230	Tail Lamp Cover Set	7 4
6568	Horn & Dipper Switch	8 6
166	Main Bulb	5 0
—	Pilot Bulb (2.5 volt. .2 amp.)	* 9
2840	Speedo Bulb (Min. Ray)	1 9
6529	Tail Lamp Bulb (M.E.S.) (6 volt. 1.5 watt)	*1 10

\* Plus purchase tax

(Always quote Frame Number when ordering spares)

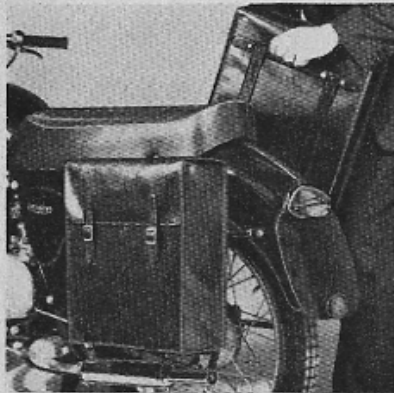

Illustrating Plover pannier equipment.

**SUNDRIES**

Part No.	Description	Price each	
		£	s. d.
003642	Speedometer head ... ..	2	0 0
003933	Speedometer cable 4' 7" ... ..	1	2 6
005733	Sparking Plug Lodge HLN ... ..		5 6
4667	K.S. Crank Rubber ... ..		1 6
4162	Licence Holder Complete ... ..		4 0
2109	Licence Holder Glass ... ..		9
004249	Electric Horn for Direct Lighting ... ..	14	6
004394	Electric Horn for Rect. Lighting ... ..	18	6
6568	Horn Push with Dipper Switch ... ..	8	6

Illustrating Plover Carrier Pillion footrests Rear damper



(Always quote Frame Number when ordering spares)

**OPTIONAL EXTRAS**

Part No.	Description	Price each	
		£	s. d.
6415G	Avon Fairing. Green { includes Francis-Barnett	8	15 0
6415W	Avon Fairing. White { bulkhead ... ..	8	15 0
	(Two colours only available)		
4641C	Passenger footrests ... .. pair	14	0
6119	Windscreen Large Type ... ..	4	1 6
6500	Sundries Bag ... ..	* 17	3
6244/5-6248/9	Pannier Equipment Complete (Plus Purchase Tax) ...	* 5	10 0
002783	Stoplight Switch Complete (Rectifier Lighting) ...	11	6
7052/3	Legshields Complete with Fittings ... ..	3	5 0
	<i>This pattern can only be used with flat screen — not suitable for use with Avon Fairing.</i>		
7052	R.H. Legshield ... ..	1	11 6
7053	L.H. Legshield ... ..	1	11 6
5599	Legshield Bracket Half Clip ... ..	2	0
5774	Legshield Bracket top ... ..	2	6
6106	Legshield Bracket Lower... ..	2	6
6107	Legshield Stud ... ..	1	0
3534	$\frac{1}{8}$ " Bolt ... ..	1	4
05/24	$\frac{5}{16}$ " Bolt ... ..		8
1015	$\frac{5}{16}$ " Nut ... ..		3
04/8	$\frac{1}{4}$ Bolt ... ..		4
904	$\frac{1}{4}$ Washer ... ..		2
901	Internal Fan Disc Washer ... ..		2
127	$\frac{1}{2}$ " Nut ... ..		3
004479	Rear Damper Unit ... ..	2	0 9
004380	Lifting Handle ... ..	7	1
7185	Luggage Carrier ... ..	1	13 0
	<i>Can be fitted with or without panniers</i>		
7191/2†	Legshields complete (for use with Avon Fairing) ...	3	5 0
7191	Legshield R.H. " " " " " " ...	1	11 6
7192	Legshield L.H. " " " " " " ...	1	11 6

\*Plus Purchase Tax

† (Not illustrated, but similar to those shown on page 21)

(Always quote Frame Number when ordering spares)

## PLOVER CARBURETTOR — AMAL 375/37

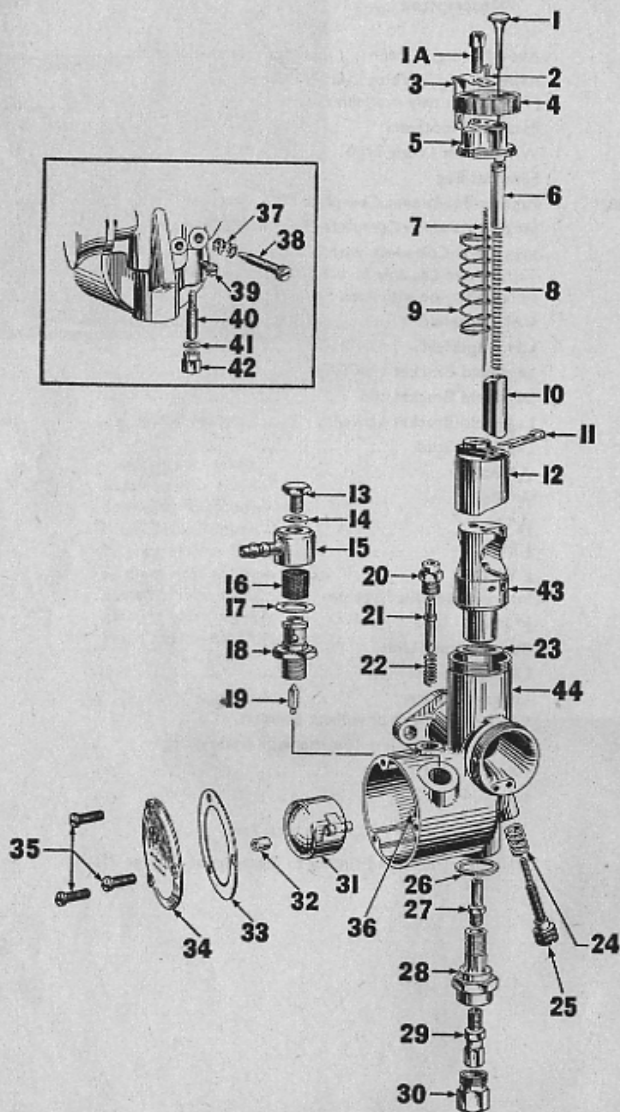
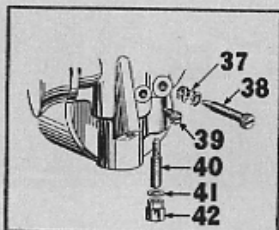

PLOVER 86

(Always quote Frame Number when ordering spares)

## AMAL CARBURETTOR—TYPE 375/37 FOR PLOVER 86

Part No.	Ill. No.	Description	Price each		
			£	s.	d.
375/37	—	Carburettor complete ... ..	4	10	0
4/035	1A	Cable Adjuster ... ..			9
4/241	2	Mixing Chamber Cap Spring Screw ... ..			2
375/070	3	Mixing Chamber Cap Spring ... ..			10
375/065	4	Mixing Chamber Cap Ring ... ..			8
375/101	5	Mixing Chamber Top Assembly ... ..	10		6
*	6	Air Valve Guide ... ..			
375/063	7	Jet Needle ... ..	2		9
*	8	Air Valve Spring ... ..			
375/061	9	Throttle Valve Spring ... ..			7
*	10	Rod Controlled Valve ... ..			
30/064	—	Strangler Rod Clip ... ..			3
4/230	11	Jet Needle Clip ... ..			7
375/060.3½	12	Throttle Valve ... ..	8		0
376/091	13	Banjo Bolt ... ..			8
376/092	14	Banjo Bolt Washer (Small) ... ..			2
376/138	15	Banjo ... ..	2		6
376/093	16	Filter Gauze ... ..			10
14/175	17	Banjo Washer (Large) ... ..			2
376/088	18	Needle Seating ... ..	3		0
376/089	19	Float Needle ... ..	1		10
343/011	20	Tickler Body ... ..			6
376/086	21	Tickler ... ..	1		3
376/087	22	Tickler Spring ... ..			2
375/067	23	Jet Block Washer ... ..			2
376/069	24	Throttle Adjusting Screw Spring ... ..			3
376/068	25	Throttle Adjusting Screw ... ..	1		0
376/074	26	Jet Holder Washer ... ..			2
376/072.105	27	Needle Jets ... ..	3		3
376/073	28	Jet Holder ... ..	4		9
376/100.110	29	Main Jets ... ..	1		6
376/075	30	Main Jets Cover ... ..			3
376/083	31	Float and Pivot ... ..	6		0
376/094	32	Float Spindle Bush ... ..			4
376/078	33	Side Cover Washer ... ..			4
376/077	34	Side Cover ... ..	3		0
376/079	35	Side Cover Screws ... ..			2
376/085	36	Float Hinge Spindle ... ..			8
4/148	37	Cold Air Adjusting Screw Spring ... ..			4
332/017	38	Cold Air Adjusting Screw ... ..	1		0
376/070	39	Locating Peg for Jet Block ... ..			7
376/076.25	40	Pilot Jet ... ..	1		3
116/162	41	Pilot Jet Cover Nut Washer ... ..			2
376/095	42	Pilot Jet Cover Nut ... ..			10
375/058	43	Jet Block Complete ... ..	11		6
375/004	44	Carburettor body ... ..	1		6
244/765	—	Sealing Rings ... ..			10
005610	—	Air Cleaner ... ..	19		5

## ENGINE PARTS FOR AMC ENGINES CYLINDER AND PISTON

Part No.	Ill. No.	Description	Price each		
			£	s.	d.
045030	1	Cylinder ... ..	6	8	2
045017	2	Piston Complete ... ..	2	1	4
045015	3	Piston Ring — Top Chrome ... ..			3
045016	4	Piston Ring — Compression ... ..			0
045109	5	Gudgeon Pin ... ..			9
041481	6	Gudgeon Pin Circlip ... ..			3
045024	7	Cylinder Head ... ..	1	19	5

\* Not supplied separately

(Always quote Frame Number when ordering spares)



CYLINDER AND PISTON—Continued

Part No.	III. No.	Description	Price each
			£ s. d.
045025	8	Cylinder Head Gasket ... ..	9
045063	9	Cylinder Head Bolt ... ..	2 0
045071	10	Cylinder Head Stud ... ..	4 3
000011	11	Cylinder Head Bolt Washer ... ..	1
Lodge HLN	12	Sparking Plug ... ..	5 6
045033	13	Carburettor Spacer ... ..	2 6
045034	14	Carburettor Spacer 'O' Ring ... ..	6
045061	15	Carburettor Bolt ... ..	1 0
000011	16	Carburettor Bolt Washer ... ..	1
045089	17	Carburettor Screwed Adaptor ... ..	6 3
045027	18	Cylinder Base Washer ... ..	1
		Gasket Set complete ... ..	2 0

PISTON OVERSIZES

Part No.	III. No.	Description	Price each
			£ s. d.
045081	—	Piston Complete .015" ... ..	2 1 4
045082	—	Piston Ring — .015" (Top Chrome) ... ..	5 3
045083	—	Piston Ring — .015" (Compression) ... ..	3 0
045085	—	Piston Complete .030" ... ..	2 1 4
045086	—	Piston Ring .030" (Top Chrome) ... ..	5 3
045087	—	Piston Ring .030" (Compression) ... ..	3 0

CRANKSHAFT ASSEMBLY

Part No.	III. No.	Description	Price each
			£ s. d.
045119	—	Crankshaft Assembly ... ..	10 16 2
045111	19	Connecting Rod and S.E. Bush ... ..	2 19 9
041575	20	Small End Bush ... ..	3 9
045110	21	Crankpin ... ..	7 6
041137	22	B.E. Roller ... ..	3
041434	23	B.E. Roller Cage ... ..	18 6
045003	24	Crankshaft — T.S. ... ..	3 6 1
045002	25	Crankshaft — D.S. ... ..	3 0 2
045010	26	Crankshaft Roller Bearing T.S. ... ..	11 9
045022	27	Crankshaft Oil Seal T.S. ... ..	2 6
041523	28	Crankshaft Bearing D.S. ... ..	11 6
045018	29	Crankshaft Bearing Spacer D.S. ... ..	3
045041	30	Crankshaft Bearing Circlip D.S. ... ..	1 0
045032	31	Crankshaft Oil Seal D.S. ... ..	3 9
041453	32	Engine Sprocket ... ..	9 0
045019	33	Engine Sprocket Spacer ... ..	4 3
041192	34	Engine Sprocket Shim ... ..	2
000230	35	Engine Sprocket Nut ... ..	11

CRANKCASE ASSEMBLY

Part No.	III. No.	Description	Price each
			£ s. d.
045009	36	Crankcase Assembly ... ..	3 19 5
041262	37	Crankcase Stud — Cylinder Base ... ..	7
041124	38	Crankcase Stud Nut — Cylinder Base ... ..	7
041010	39	Crankcase Stud Nut Washer ... ..	1
045054	40	Crankcase Stud. $4\frac{3}{8}'' \times \frac{5}{16}''$ ... ..	9
045050	41	Crankcase Stud. $4\frac{1}{2}'' \times \frac{5}{16}''$ ... ..	9
045047	42	Crankcase Dowel Stud. $3\frac{1}{8}'' \times \frac{5}{16}''$ ... ..	6
045051	43	Crankcase Dowel Stud. $3\frac{1}{8}'' \times \frac{5}{16}''$ ... ..	6
045055	44	Crankcase Dowel Stud. $3\frac{1}{2}'' \times \frac{5}{16}''$ ... ..	6
000004	45	Crankcase Stud Nut ... ..	4
000011	46	Crankcase Stud Nut Washer ... ..	1
040137	47	Crankcase Drain Plug ... ..	7
041123	48	Crankcase Drain Plug Washer ... ..	2

(Always quote Frame Number when ordering spares)

AMC ENGINE UNIT — 15T - 149 cc.

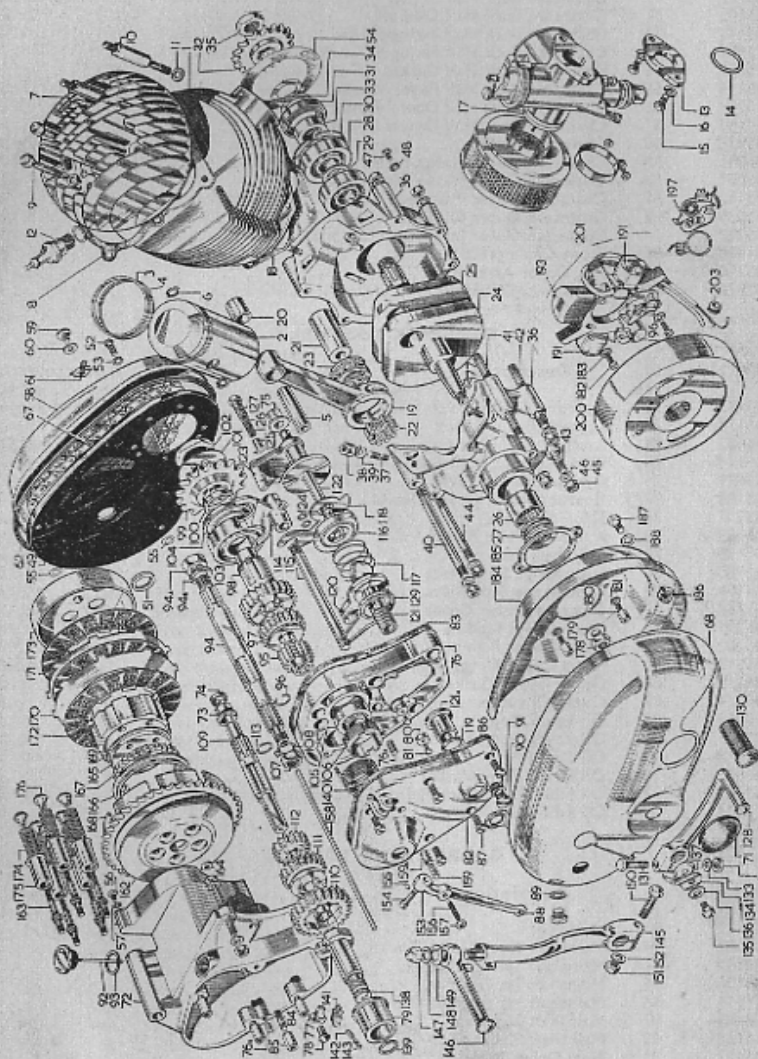

(Always quote Frame Number when ordering spares)

CHAINCASE, ETC.

Part No.	Ill. No.	Description	Price each
			£ s. d.
045037	49	Chaincase Back Half	16 6
045103	51	Chaincase Back Half Oil Seal	2 2
000440	52	Chaincase Back Half Fixing Screw	4
023107	53	Chaincase Back Half Fixing Screw Washer	2
045026	54	Chaincase Back Half Gasket	1
016138	55	Chaincase Back Half Paper Washer	1
045254	56	Chaincase Back Half Dowel Bolt	6
014117	57	Chaincase Back Half Dowel Bolt Washer	1
045038	58	Chaincase Outer	7 0
045045	59	Chaincase Outer Fixing Screw	1 9
045057	60	Chaincase Outer Fixing Screw Washer	1
023146	61	Chaincase Outer Trapped Nut	3
045039	62	Chaincase Outer Oil Seal Rubber	3 9
045247	—	Chaincase Outer Inspection Cap Assy.	4 3
041430	67	Front Chain (110038 x 58)	11 3
005710	68	T.S. Cover Assembled	12 0
042378	71	T.S. Cover Grummet	9

GEARBOX ASSEMBLY

Part No.	Ill. No.	Description	Price each
			£ s. d.
045172	72	Gearbox Shell	4 11 8
045173	73	Layshaft Bush — Box	7 3
041682	74	Layshaft Bush End Cap	6
045174	75	Cam Segment Shaft Bush	3 3
045179	76	Gearbox Inner Cover	1 19 7
045188	76A	Gearbox Inner Cover Dowel	6
045207	77	K.S. Stop Plate	2 3
045208	78	K.S. Stop Plate Rivet	6
045186	79	K/S Shaft Bush	8 0
045180	80	Footchange Stop Piece	1 3
045181	81	Footchange Stop Piece Rivet	1
045167	82	Gearbox Outer Cover	1 12 9
045211	83	Inner Cover Gasket	3
045212	84	Inner Cover Fixing Stud	1 0
045213	85	Inner Cover Fixing Stud Nut	1 3
045210	86	Outer Cover Gasket	3
045214	87	Outer Cover Screw	6
012019	88	Oil Level Plug	5
041055	89	Oil Level Plug Washer	1
012019	90	Oil Drain Plug	5
041055	91	Oil Drain Plug Washer	1
045229	92	Oil Filler Cap assembled	4 3
017504	93	Oil Filler Cap Washer	6

GEARBOX INTERNALS

Part No.	Ill. No.	Description	Price each
			£ s. d.
045182	94	Mainshaft	2 4 2
000002	94A	Mainshaft Nut (Clutch End)	5
000194	94B	Mainshaft Spring Washer	2
045190	95	Mainshaft 1st Gear	11 3
011111	96	Mainshaft 1st Gear Circlip	1
045192	97	Mainshaft 2nd Gear	1 8 6
045168	98	Mainshaft Sleeve Gear	2 5 8
041687	99	Final Drive Sprocket	12 6
045166	100	Final Drive Sprocket Spacer	4 0
041661	101	Final Drive Sprocket Lockwasher	6

(Always quote Frame Number when ordering spares)

GEARBOX INTERNALS—Continued

Part No.	Ill. No.	Description	Price each
			£ s. d.
041660	102	Final Drive Sprocket Nut	1 6
021598	103	Sleeve Gear Bearing	1 8 6
041267	104	Sleeve Gear Bearing Oil Seal	3 0
012545	105	Mainshaft Ball Bearing K/S End	14 3
041280	106	Mainshaft Bearing Lock Ring	2 1
041265	107	Mainshaft Nut — (K.S. End)	10
042899	108	Mainshaft Nut Lock Washer	2
045183	109	Layshaft	1 6 3
045255/6	—	Layshaft Shim (Fit Selectively)	3
045199	110	Layshaft 1st Gear	1 7 4
045193	111	Layshaft 2nd Gear	1 9 9
045194	112	Layshaft 3rd Gear	7 9
011111	113	Layshaft 3rd Gear Circlip	1
045151	114	Selector Fork	1 10 6
045238	115	Striker Shaft	6 6

FOOTCHANGE MECHANISM

Part No.	Ill. No.	Description	Price each
			£ s. d.
045231	116	Footchange Ratchet	1 0 3
045237	117	Footchange Ratchet Spring	3
045232	118	Footchange Actuating Plate	10
040006	119	Footchange Ratchet Shaft 'O' Ring	1 2
045224	120	Footchange Ratchet Arm Pin	3
045226	121	Footchange Ratchet Shaft Assembly	1 6 5
045215	121A	Footchange Ratchet Shaft Bush	7 0
045219	122	Cam Segment Shaft Spindle	8 3
045259	123	Cam Segment Shaft Assembly	2 3 4
040079	124	Cam Segment Shaft 'O' Ring	7
045155	125	Cam Plate Plunger	2 9
045153	126	Cam Plate Plunger Spring	3
045154	127	Cam Plate Plunger Bolt	2 6
041524	128	Footchange Pedal	17 0
045236	129	Footchange Pedal Return Spring	6
040086	130	Footchange Pedal Rubber	1 2
040105	131	Footchange Pedal Bolt	1 2
000005	132	Footchange Pedal Bolt Nut	4
000012	133	Footchange Pedal Bolt Washer	1
040051	134	Gear Indicator	1 9
040137	135	Gear Indicator Bolt	7
000012	136	Gear Indicator Bolt Washer	1
041467	137	Footchange Pedal End Cap	1 3

KICK STARTER MECHANISM

Part No.	Ill. No.	Description	Price each
			£ s. d.
045202	138	Kick Start Shaft	2 7 6
040006	139	Kick Start 'O' Ring	1 2
040043	140	Kick Start Return Spring	1 2
045205	141	Kick Start Pawl	4 3
045206	142	Kick Start Pawl Pin	6
045209	143	Kick Start Pawl Pin Spring	3
042941	—	Kick Start Crank Complete	2 1 2
042940	145	Kick Start Crank only	1 6 8
042934	146	Kick Start Crank Pedal	12 6
040432	147	Kick Start Crank Pedal Dome Nut	1 9
000010	148	Kick Start Crank Pedal Plain Washer	1
040433	149	Kick Start Crank Pedal Spring Steel Washer	2
000367	150	Kick Start Crank Bolt	10
000004	151	Kick Start Crank Bolt Nut	4
000011	152	Kick Start Crank Bolt Washer	1

(Always quote Frame Number when ordering spares)

X TO BE ORDERED TOGETHER

## CLUTCH AND OPERATING MECHANISM

Part No.	Ill. No.	Description	Price each		
			£	s.	d.
045197	153	Clutch Lever ... ..	14	9	
045185	154	Clutch Lever Pivot Pin ... ..	1	6	
041285	155	Clutch Lever Pivot Pin Circlip ... ..			2
041348	156	Clutch Adjuster Screw ... ..			4
000080	157	Clutch Adjuster Screw Nut ... ..			1
045239	158	Clutch Push Rod ... ..	2	6	
010831	159	Clutch Operator Roller ... ..			5
045184	159A	Clutch Operator Roller Bush ... ..			9
045252	162	Clutch Back Plate ... ..	10	6	
041382	163	Clutch Spring Stud ... ..	2	4	
041370	164	Clutch Spring Stud Nut ... ..			3
045162	165	Clutch Race Plate ... ..	11	0	
041367	166	Clutch Roller Cage ... ..	2	4	
041366	167	Clutch Rollers ... ..	2	11	
041357	168	Clutch Sprocket ... ..	2	5	0
045161	169	Clutch Centre ... ..	1	4	4
045249	170	Clutch Plate Plain ... ..	3	0	
045251	171	Clutch Friction Plate — Front ... ..	6	0	
045250	172	Clutch Friction Plate ... ..	6	6	
045165	173	Clutch Pressure Plate ... ..	8	0	
041353	174	Clutch Spring ... ..			9
041392	175	Clutch Spring Cup ... ..			9
041383	176	Clutch Spring Cup Adjuster Nut ... ..			7

## WICO FLYWHEEL GENERATOR

Part No.	Ill. No.	Description	Price each		
			£	s.	d.
000572	177	Generator Rotor Key ... ..			4
045021	178	Generator Rotor Nut ... ..	1	0	
000010	179	Generator Rotor Washer ... ..			1
045059	180	Generator Stator Fixing Stud ... ..	2	0	
045062	181	Generator Stator Fixing Stud Washer ... ..			1
000455	182	Generator Stator Fixing Screw ... ..			4
000039	183	Generator Stator Fixing Screw Washer ... ..			2
045078	184	Generator Shroud ... ..	7	3	
045053	185	Generator Shroud Spacer ... ..	1	3	
023146	186	Generator Shroud Trapped Nut ... ..			3
014577	187	Generator Shroud Bolt ... ..			4
000012	188	Generator Shroud Bolt Washer ... ..			1
S1053	191	L.T. Coil Set ... ..	1	1	9
S1046	193	H.T. Coil Set ... ..	1	0	0
S1051	196	Condenser Set (Includes S0052) ... ..			7 6
S0577	197	Contact Breaker Points ... ..			7 6
S1032	200	Flywheel and Cam Unit ... ..	5	5	0
S1052	201	Stator Unit ... ..	3	10	0
2179	203	Grommet ... ..			3

(Always quote Frame Number when ordering spares)

## GUARANTEE AND TERMS OF BUSINESS

### NOTICE

Machines are delivered Carriage Paid to nearest Railway Station in Great Britain

We do not appoint agents for the sale on our behalf of our motor cycles or other goods, but we assign to motor cycle dealers areas in which we supply to such dealers exclusively for re-sale in such areas. No such Dealer is authorised to transact any business, give any warranty, make any representation or incur any liability on our behalf.

### CONDITIONS OF SALE AND GUARANTEE

We give the following guarantee with our motor cycles, including all accessories and component parts other than tyres, saddles, chains and lighting and electrical equipment and other than accessories and component parts supplied to the order of the Purchaser and differing from those comprised in the standard specifications. This guarantee is given in place of any implied conditions or warranties or any liabilities whatsoever statutory or otherwise; no guarantee except that hereinafter contained and no condition or warranty whatsoever statutory or otherwise is given or is to be implied, nor are we to be under any liability whatsoever except under the guarantee hereinafter contained.

We guarantee, subject to the conditions mentioned below, that all precautions which are usual and reasonable have been taken by us to secure excellence of materials and workmanship, but this guarantee is to extend and be in force for six months only from date of purchase, or date of exchange in case of any accessory or part supplied by way of exchange as hereinafter provided, and damages for which we make ourselves responsible under this guarantee are limited to the free repair of or supply of a new part or accessory in exchange for the part of the motor cycle or accessory which may have proved defective. We undertake subject to the conditions mentioned below to make good in manner aforesaid any part or accessory covered by this guarantee which has proved defective within the said period of six months. We do not undertake to replace or refix, or bear the cost of replacing or refixing any such new part or accessory in the motor-cycle.

As motor cycles are easily liable to derangement by neglect or misuse, this guarantee does not apply to defects caused by wear and tear, misuse or neglect.

The term "misuse" shall include amongst others the following act:—

The use of a motor cycle or of a motor cycle and sidecar combined, when carrying more persons or a greater weight than that for which the machine was designed by the manufacturers.

We do not guarantee tyres, saddles, chains or lighting and electrical equipment, or any accessories or component parts supplied to the order of the Purchaser differing from those comprised in the standard specifications. As regards all such tyres, saddles, chains, lighting and electrical equipment, accessories and component parts, no guarantee, condition or warranty of any kind statutory or otherwise is given or is to be implied, and we are to be under no liability whatsoever in respect thereof.

### CONDITIONS OF GUARANTEE

If a defective part or accessory should be found in our motor cycles, or in any part or accessory supplied by way of exchange as before provided, it must be sent to us CARRIAGE PAID, and accompanied by an intimation from the owner that he desires to have it repaired or exchanged free of charge under our guarantee and he must also furnish us at the same time with the number of the machine, the date of the purchase or the date when the alleged defective part or accessory was exchanged as the case may be.

Failing compliance with the above, such articles will lie here at THE RISK OF THE OWNER and this guarantee and any implied guarantee warranty or condition shall not be enforced.

We reserve the right to alter specifications and/or prices without notice.

### REPAIRS

Any motor cycle, sent to us to be plated, enamelled or repaired will be repaired upon the following conditions, i.e., we guarantee that all precautions which are usual and reasonable have been taken by us to secure excellence of materials and workmanship, such guarantee to extend and be in force for three months only from the time such work shall have been executed, and this guarantee is in lieu and in exclusion of all conditions and warranties statutory or otherwise and all liabilities whatsoever and the damages recoverable are limited to the cost of any further work which may be necessary to amend and make good the work found to be defective.

PRINTED BY  
NORTH VIEW PRESS LTD.,  
NORTH STREET,  
COVENTRY.

Insist on Genuine

**Francis-Barnett**

SPARE PARTS